



2961-010
CUT AND MOVE™
COULTER/RESIDUE MANAGER
OPENER
OPERATORS & PARTS MANUAL
2565-493_REV_C 11/2016

YETTER MANUFACTURING CO.
FOUNDED 1930

Colchester, IL 62326-0358
Toll free: 800/447-5777
309/776-3222 (Fax)
Website: www.yetterco.com
E-mail: info@yetterco.com

YETTER

FOREWORD

You've just joined an exclusive but rapidly growing club.

For our part, we want to welcome you to the group and thank you for buying a Yetter product.

We hope your new Yetter products will help you achieve both goals-increase your productivity and increase your efficiency so that you may generate more profit.

This operator's manual has been designed into four major sections: Foreword, Safety Precautions, Installation Instructions and Parts Breakdown.



This **SAFETY ALERT SYMBOL** indicates important safety messages in the manual. When you see this symbol, be alert to the possibility of **PERSONAL INJURY** and carefully read the message that follows.

The word **NOTE** is used to convey information that is out of context with the manual text. It contains special information such as specifications, techniques and reference information of a supplementary nature.

The word **IMPORTANT** is used in the text when immediate damage will occur to the machine due to improper technique or operation. Important will

apply to the same information as specified by note only of an immediate and urgent nature.

It is the responsibility of the user to read the operator's manual and comply with the safe and correct operating procedure and to lubricate and maintain the product according to the maintenance schedule in the operator's manual.

The user is responsible for inspecting his machine and for having parts repaired or replaced when continued use of the product would cause damage or excessive wear to the other parts.

It is the user's responsibility to deliver his machine to the Yetter dealer who sold him the product for service or replacement of defective parts, which are covered by the warranty policy.

If you are unable to understand or follow the instructions provided in this publication, consult your local Yetter dealer or contact:

YETTER MANUFACTURING CO.

309/776-4111

800/447-5777

309/776-3222 (FAX)

Website: www.yetterco.com

E-mail: info@yetterco.com

WARRANTY

Yetter Manufacturing warrants all products manufactured and sold by it against defects in material. This warranty being expressly limited to replacement at the factory of such parts or products as shall appear to be defective after inspection. This warranty does not obligate the Company to bear cost of labor in replacement of parts. It is the policy of the Company to make improvements without incurring obligations to add them to any unit already sold. No warranty is made or authorized to be made, other than herein set forth. This warranty is in effect for one year after purchase.

Dealer _____

Yetter Manufacturing warrants its own products only and cannot be responsible for damages to equipment on which mounted.

TABLE OF CONTENTS

FOREWORD	2
WARRANTY	2
SAFETY	4
CAUTION.....	4
ASSEMBLY INSTRUCTIONS	5-9
OPERATION PRECAUTIONS	9
PLANTER ADJUSTMENT	10
OPERATION.....	11
MAINTENANCE	12-17
PARTS IDENTIFICATION	18-24
TROUBLESHOOTING.....	25

SAFETY

A brief description of signal words that may be used in this manual:

CAUTION: Used as a general reminder of good safety practices or to direct attention to unsafe practices.

WARNING: Denotes a specific potential hazard.

DANGER: Denotes the most serious specific potential hazard.

SAFETY PRECAUTIONS

You can make your farm a safer place to live and work if you observe the safety precautions given. Study these precautions carefully and insist that they be followed by those working with you and for you.



WARNING

Never clean, lubricate or adjust a machine that is in motion. Always lower or block the implement before performing service.

If machine must be serviced in the raised position, jack or block it up to prevent it from accidentally falling and injuring someone.

Do not allow riders on the tractor or implement.

Use speeds and caution dictated by the terrain being traversed. Do not operate on any slope steep enough to cause tipping or loss of control.

Be sure all personnel are clear of the immediate area before operating.

Read and understand the operator's manual and require all other persons who will operate the equipment to do the same.

Be familiar with all tractor and implement controls and be prepared to stop engine and implements quickly in an emergency.



CAUTION

Consult your implement and tractor operator's manual for correct and safe operating practices.

Beware of towed implement width and allow safe clearance.

FAILURE TO HEED MAY RESULT IN PERSONEL INJURY OR DEATH.

ASSEMBLY INSTRUCTIONS

2961 – CUT AND MOVE

STEP 1. Attach the 2961-200 Coulter Bracket to the planter row unit, using three 1/2" x 1-1/2" bolts, flat washer, and lock nuts.

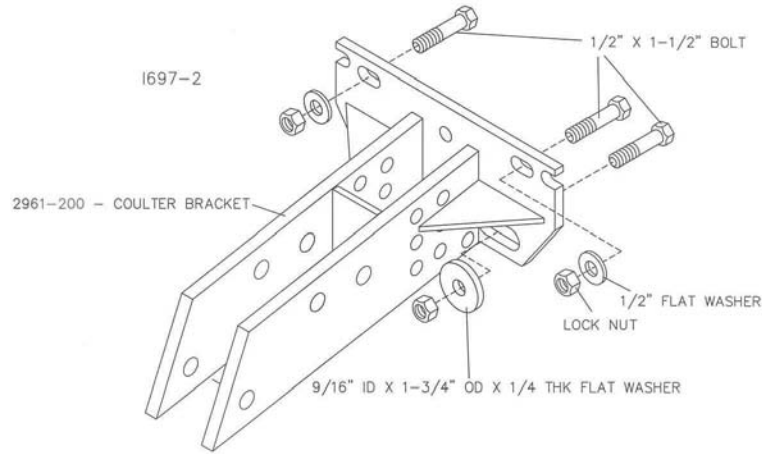

STEP 2. Attach the 2961-300 coulter arm adjustment plate to the coulter bracket using a 5/8" x 1-3/4" bolt, 5/8" x 4-1/2" bolt, 21/32" spacer bushing and lock nuts.

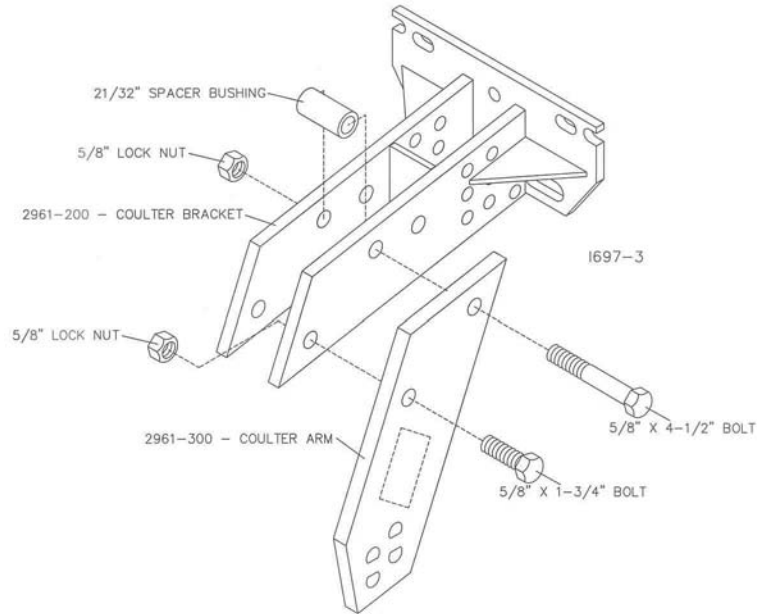

STEP 3. Assemble the 5/8" x 3" d-bolt onto the hub/bearing. Now attach the blade and hub cap to the hub/bearing assembly using 4) 5/16" x 1-1/4" carriage bolts and lock nuts.

NOTE: When assembling the blade, hub cap and bearing hub, be sure the slot in the blade is in alignment with small hole in bearing hub and groove on inside of hub cap.

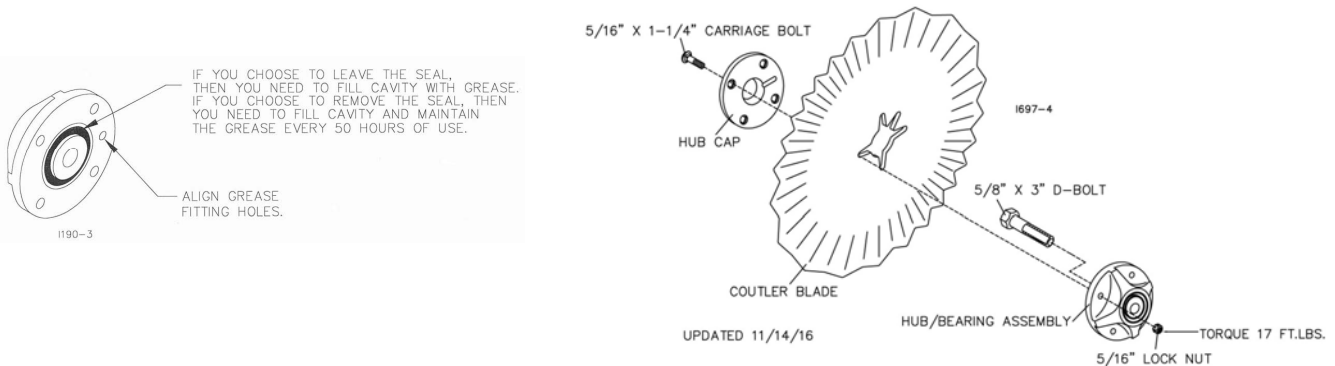

ASSEMBLY INSTRUCTIONS

2961 – CUT AND MOVE

STEP 4. Attach the blade/hub assembly to the coultter arm using the 5/8" x 3" D-bolt, lock washer and hex nut. Torque 150 ft.lbs.

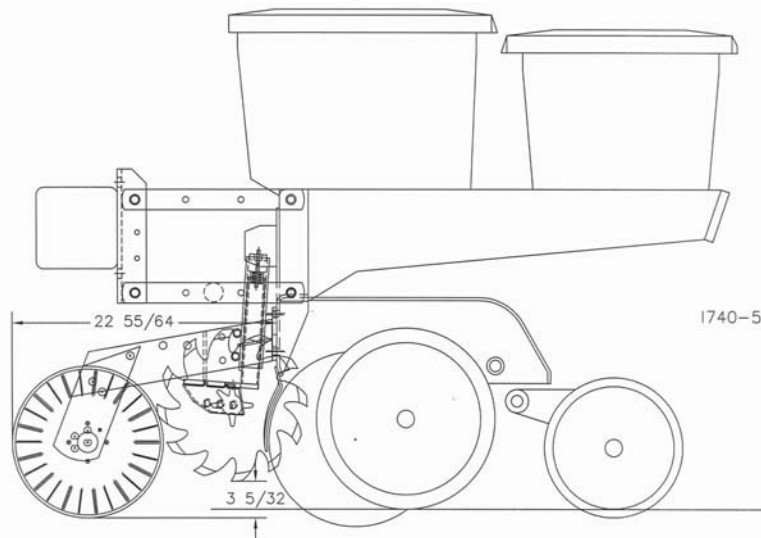
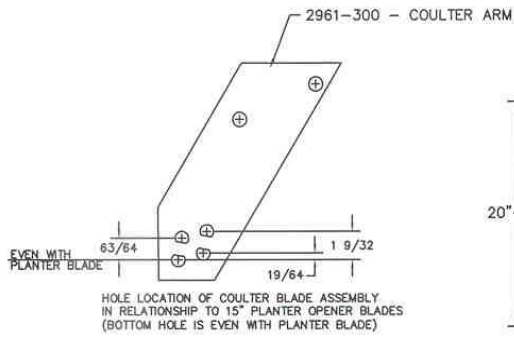
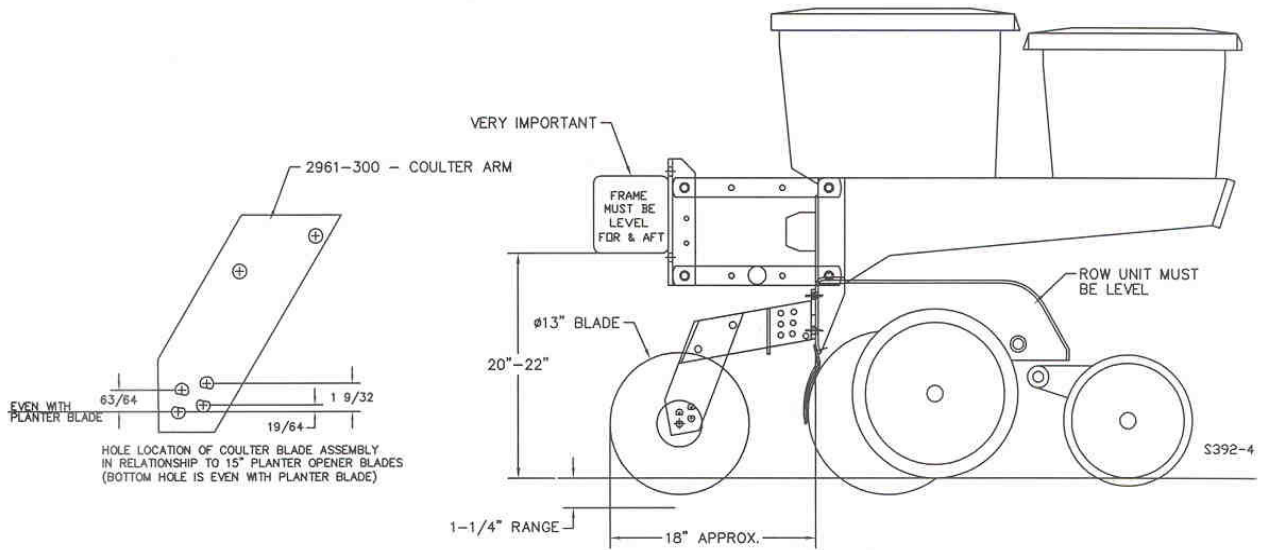
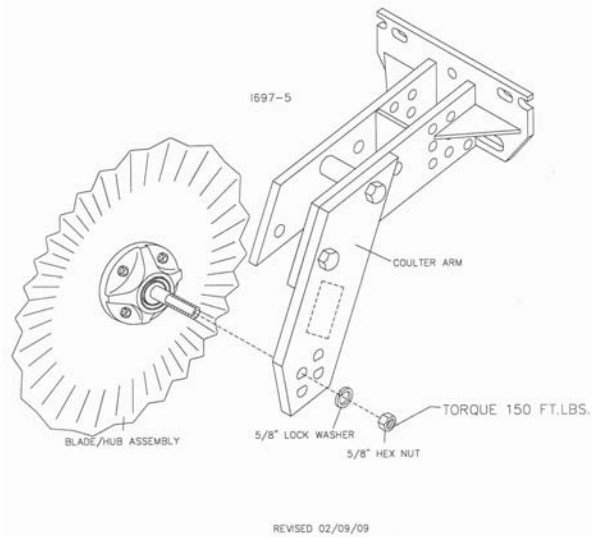

STEP 5. Laterally align blade with planter opener blades. Tighten bolts securing bracket to the planter. Torque to 80 ft. lbs.

ASSEMBLY INSTRUCTIONS

2961 – CUT AND MOVE

STEP 6. NOTE: When assembling the residue manager wheel, hub cap and bearing hub; make right hand and left hand assemblies. Also, be sure the slot in the R.M. wheel is in alignment with small hole in bearing and the groove on inside of hub cap. Assemble the 5/8" x 4" d-bolt and 3/16 thick flat washer onto the bearing hub. Now attach the residue manager wheel and hub cap to the bearing hub using 4) 5/16" x 1-1/2" carriage bolts and lock nuts.

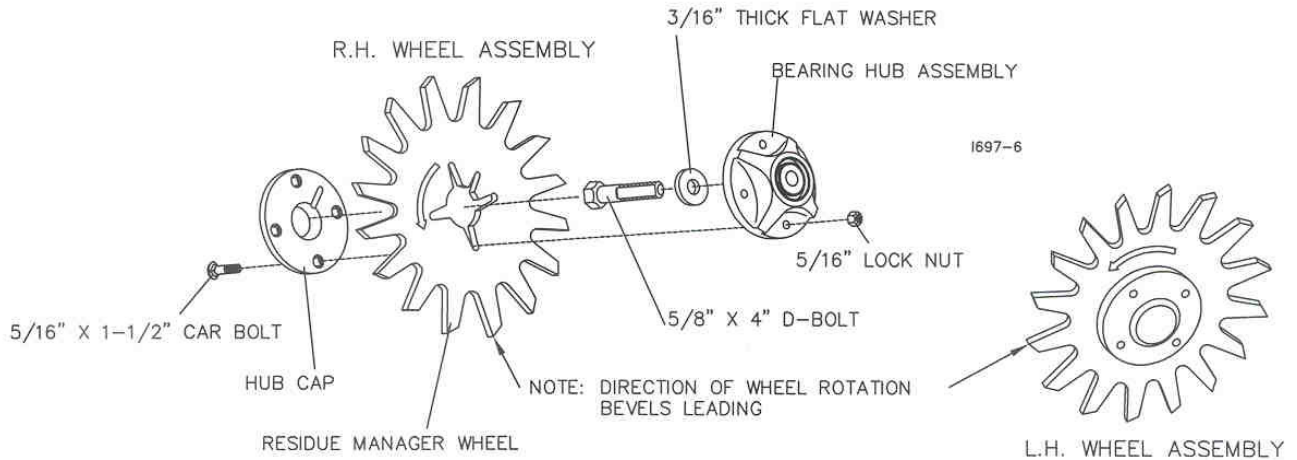

STEP 7. Onto the residue manager wheel assembly, install the 2967-302 – 3/4" spacer, 2967-336 – shield, 1/4" flat washer and attach to the 2967-247 – stem using lock washer and installed in the rear hole of the 2967-247 stem. Torque 150 ft.lbs.

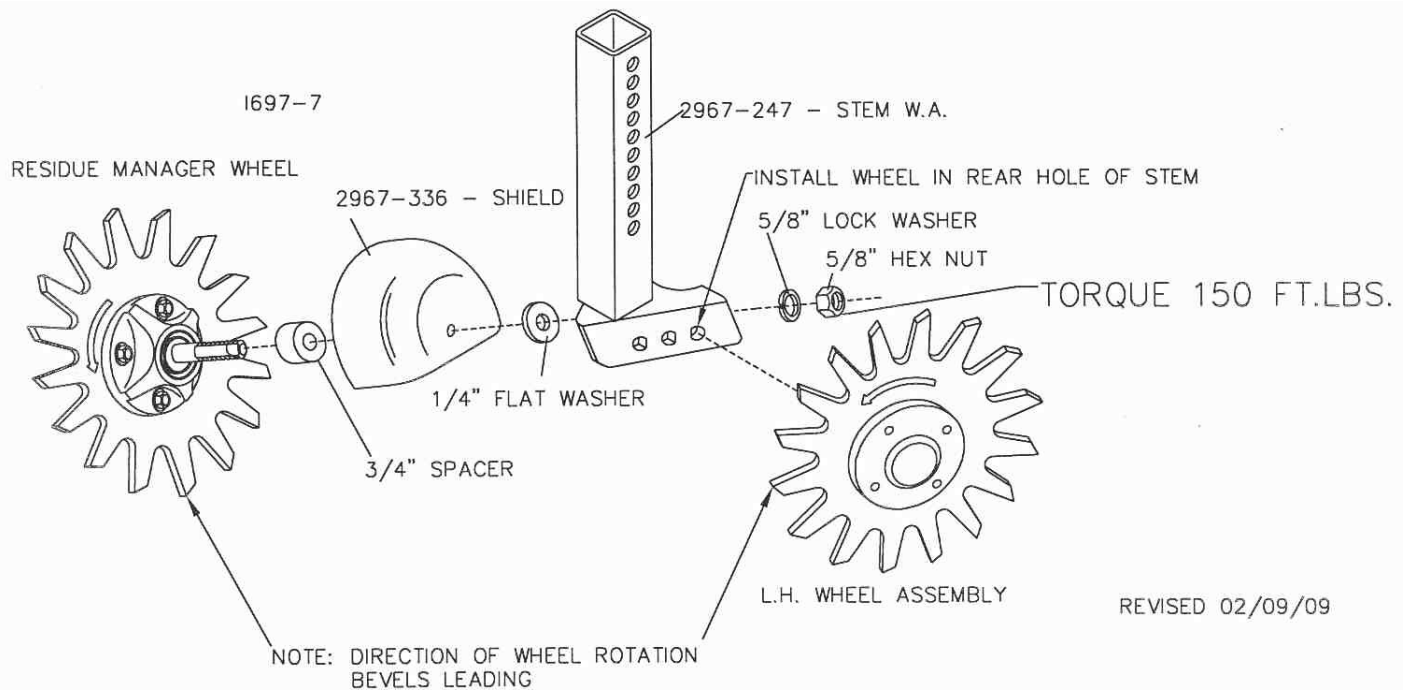

ASSEMBLY INSTRUCTIONS

2961 – CUT AND MOVE

STEP 8. Install a 1/2" x 3-1/2" bolt into the lower rear hole of the 2961-200 coultter bracket and secure with lock nut. **DO NOT OVER-TIGHTEN THE BOLT!**

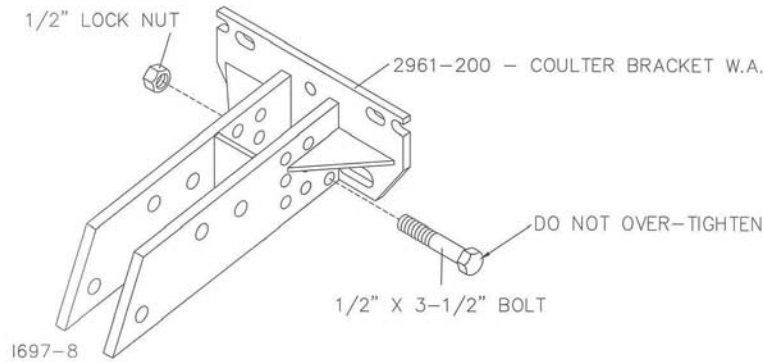

STEP 9. The universal model that fits on JD 7200/1700 series planters can be mounted two ways (See Figure 1). The front set of holes is to mount these models on planter units with light duty or heavy duty cast lower parallel arms. The rear set of holes is for planter units with heavy-duty welded lower parallel arms.

MOUNTING ARRANGEMENTS FOR JOHN DEERE 7200/1700 SERIES

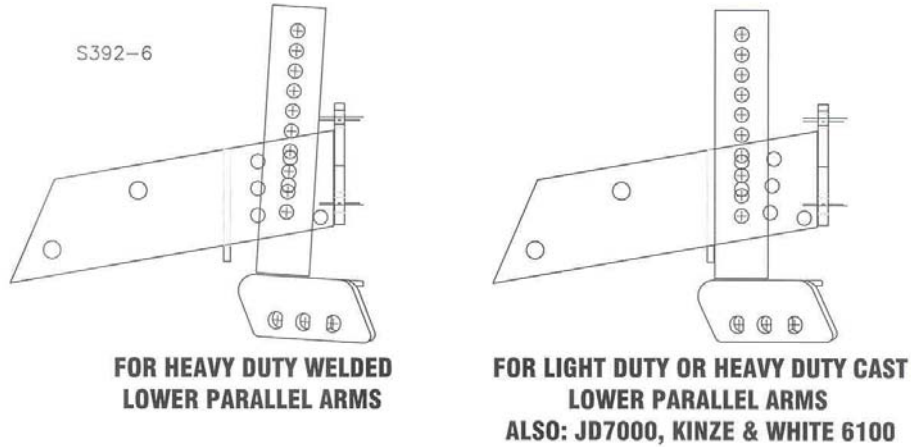

FIGURE 1

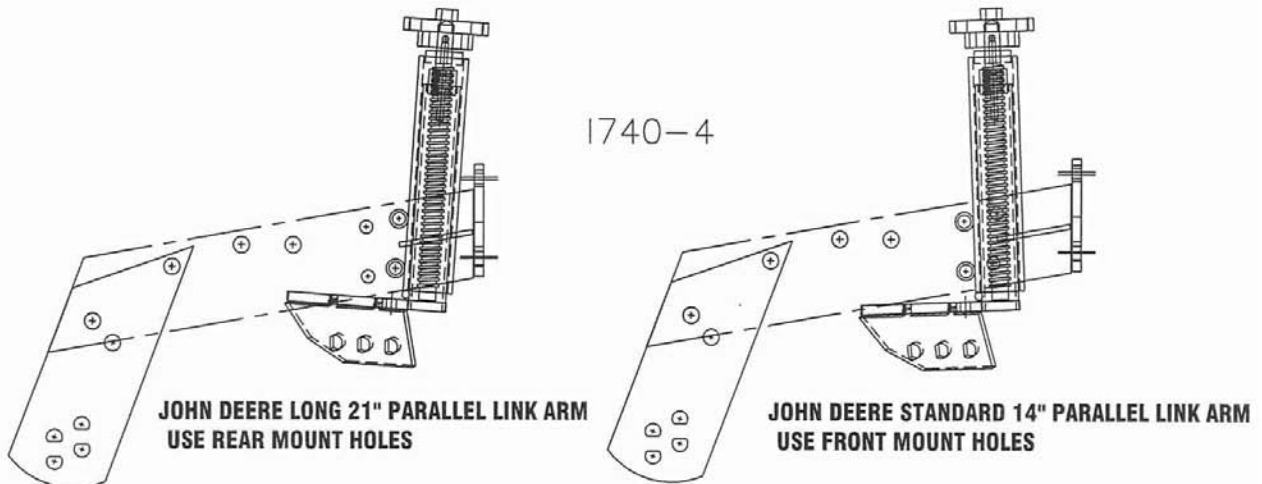
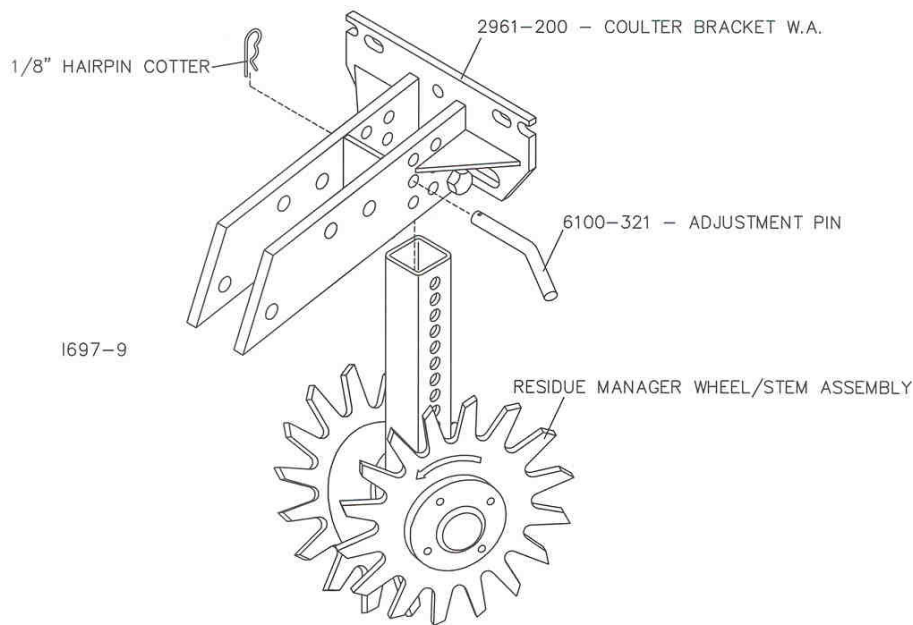

FIGURE 2

ASSEMBLY INSTRUCTIONS

2961 – CUT AND MOVE

STEP 10. Install the residue manager wheel/stem assembly onto the 2961-200 coulter bracket weldment and insert the 6100-321 adjustment pin through the parts and secure with 1/8" hairpin cotter.



OPERATION PRECAUTIONS STOP!!!

Read this before using the Yetter product.

- MACHINE OPERATION

IMPORTANT: failure to properly set the planter frame height and levelness can result in less than successful operation of the planter and the Yetter product and may result in damaged equipment. All operators should read and thoroughly understand the instructions given prior to using the Yetter product.

NOTE: **DO NOT** use this product if the planter is not adjusted properly!

Leveling the planter:

With the planter lowered to proper operating height (**Usually 20"-22"**). **Read the planter operator's manual for recommended setting**. Check to be sure the toolbar and row unit parallel arms are level fore and aft. **Re-check** when the planter is in the **field** and has been **fully loaded** with seed, fertilizer, granular chemicals, etc. Also, a field check with a bubble level on the frame should be made of the hitch height to ensure level operation front to back.

It is important for the planter to operate level laterally. Tire pressure must be maintained at pressures specified by the manufacturer.

Field and actual planting conditions change and will dictate planter frame heights. You must ensure that the row unit parallel arms are approximately parallel with the ground.

IMPORTANT: For proper operation of the planter attachments and row units, it is imperative that the planter toolbars and row unit parallel arms be level side-to-side and front-to-rear. The toolbar frame should operate at a 20"-22" height from the **planting surface**. Check the manufacturer's operator's manual for instructions on how to adjust the frame height and levelness.

PLANTER ADJUSTMENT

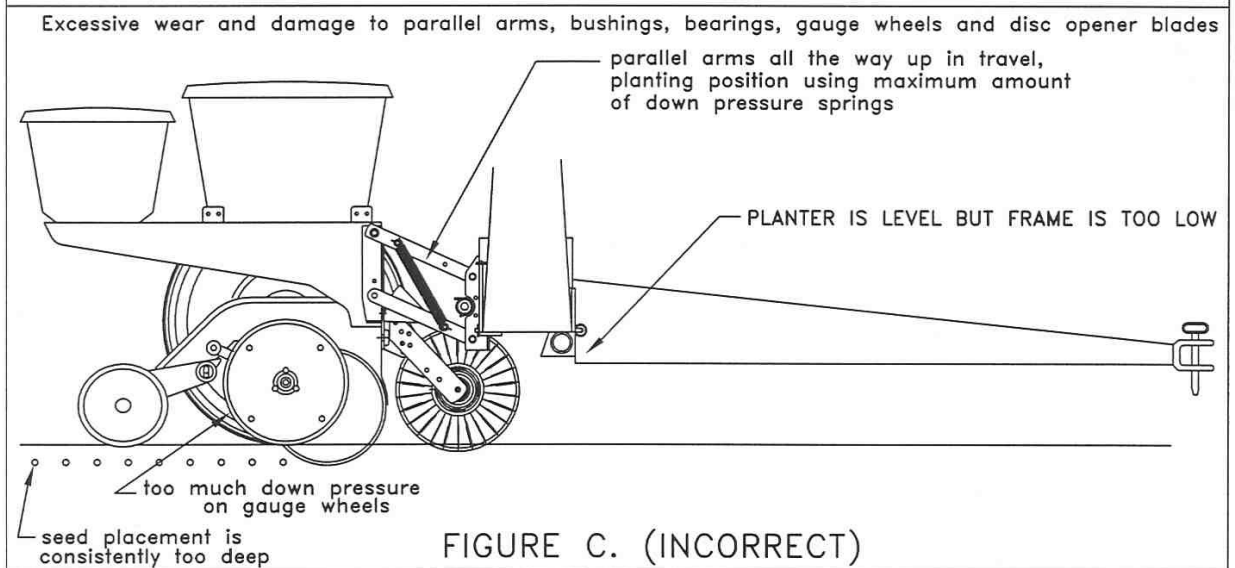
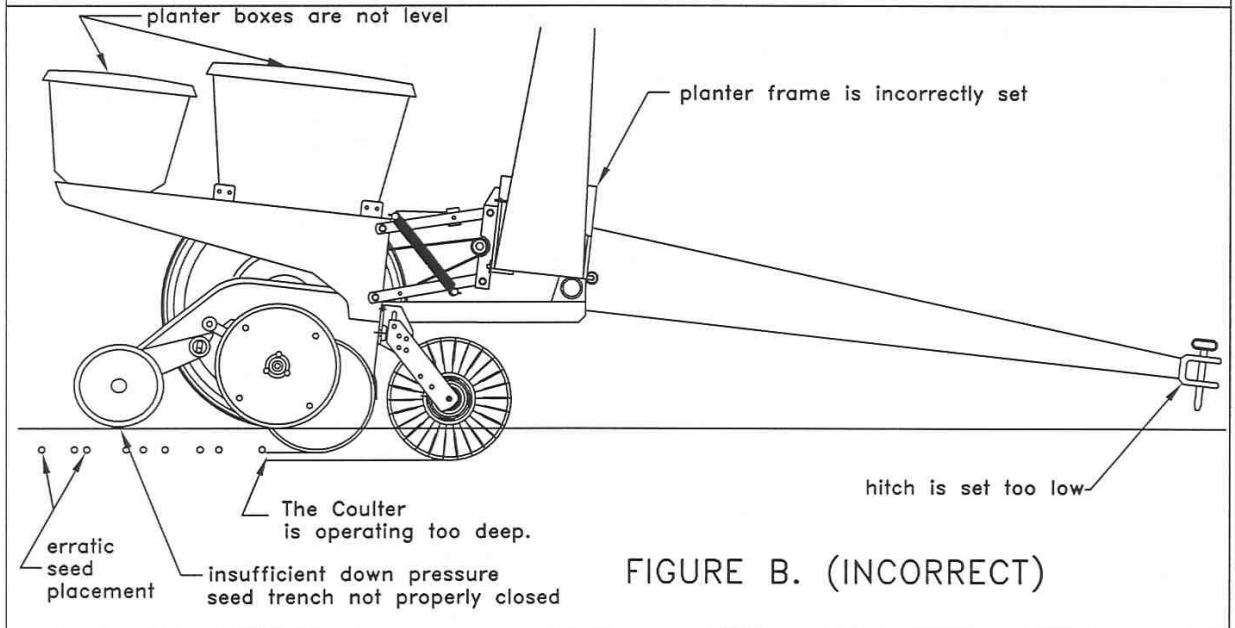
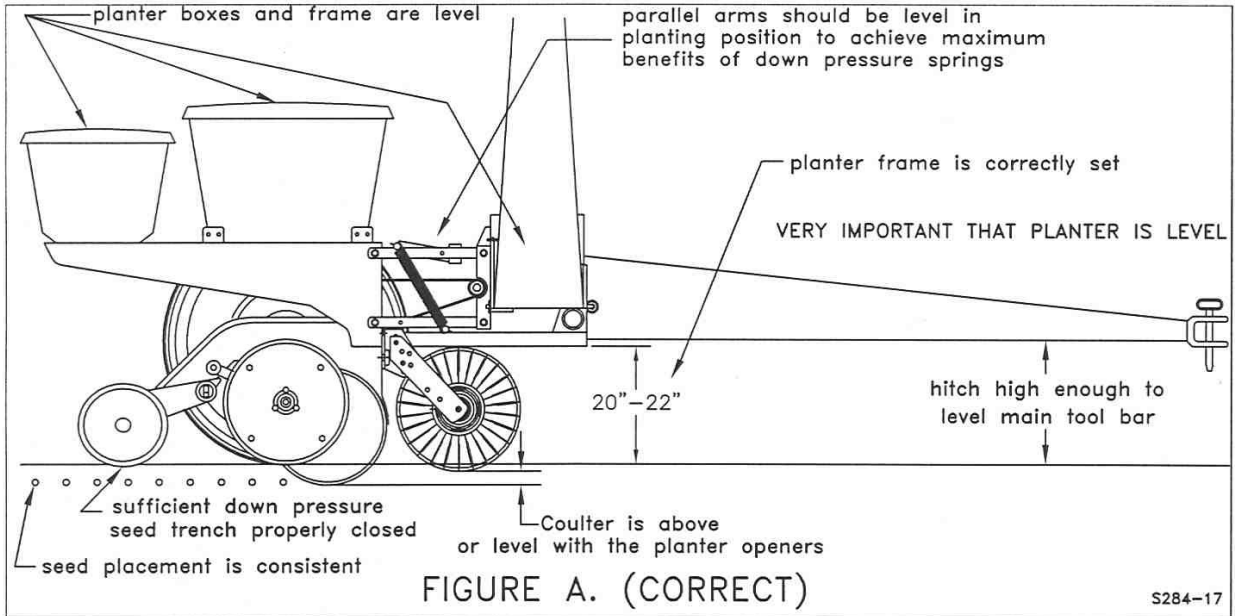

OPERATION

1. Set/mount coulter blades to run perpendicular to the soil. Operation depth and blade wear can be affected if the coulter is mounted crooked or if the toolbar is not level side to side.
2. After a few hours of use, check all bolts for tightness and proper torque.
3. Adjust the residue manager to move crop residue aside and not move any soil. Adjustments to the residue manager may have to be made when changing field conditions and type and amount of residue.

ROW CLEANER DO'S AND DON'TS

1. **DO NOT** move soil; Residue Managers are designed to move crop residue only.
2. **DO NOT** operate planter at slow speeds, ground speed affects how aggressive the spoke wheels are; operate at sufficient speed (4-6 mph) to maintain good residue flow.
3. **DO NOT** expect 100% of crop residue to be cleared, it is not necessary and would necessitate engaging the soil. The width of path cleared depends on ground conditions, depth setting and ground speed.
4. **DO** expect to see wheels occasionally quit turning, indicates ideal (shallow) setting which is not moving soil.
5. **DO** adjust toolbar frame height 20"-22" and drawbar correctly. Very important to ensure planter units will follow ground contours properly.
6. **Do** adjust planter unit down pressure kit correctly to prevent excessive depth in soft, loose soils.

MAINTENANCE

BEARING ASSEMBLY AND LUBRICATION

Practice Safety

Understand and practice safe service procedures before doing work. Follow ALL the operating, maintenance and safety information in the equipment operator manual. Clear the area of bystanders, especially small children, when performing any maintenance or adjustments. Keep work area clean and dry. Use adequate lighting for the job. Use only tools, jacks and hoists of sufficient capacity for the job.

Never lubricate, service, or adjust machine while it is moving. Keep hands, feet, and clothing from power-driven moving and rotating parts. Disengage all power and operate controls to relieve pressure. Lower equipment to the ground and stop the engine. Remove the key. Wait for all moving parts to stop before servicing, adjusting, repairing or unplugging.

Securely support any machine elements with blocks or safety stands that must be raised for service work.

Keep all parts in good condition and properly installed. Fix damaged equipment immediately. Replace worn or broken parts. Remove any buildup of grease, oil, or debris. Make sure all guards are in place and properly secured when maintenance work is completed.

Assembly

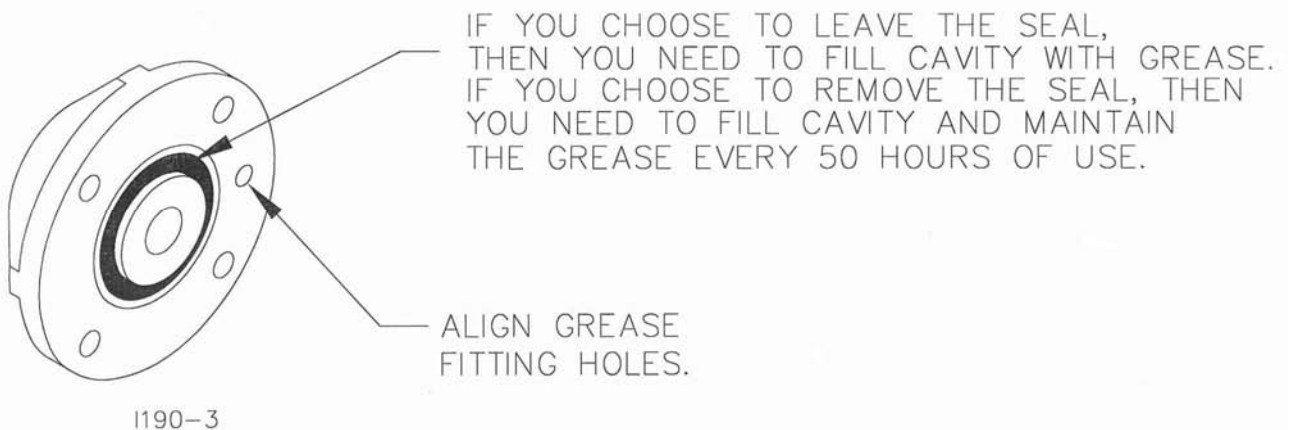

MAINTENANCE

ALIGN THE HUB CAP GROOVE,
WITH THE WHEEL SLOT AND
GREASE FITTING

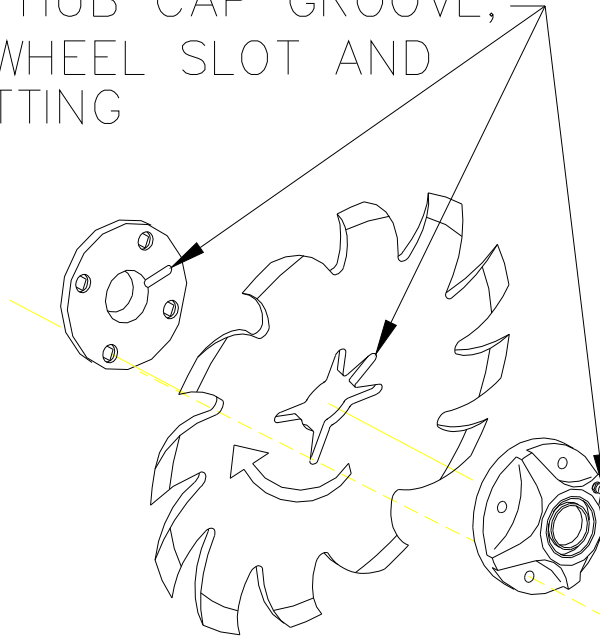

NOTE: Be certain to align the grease fitting with the slot in the wheel and the hubcap so that the grease can flow freely.

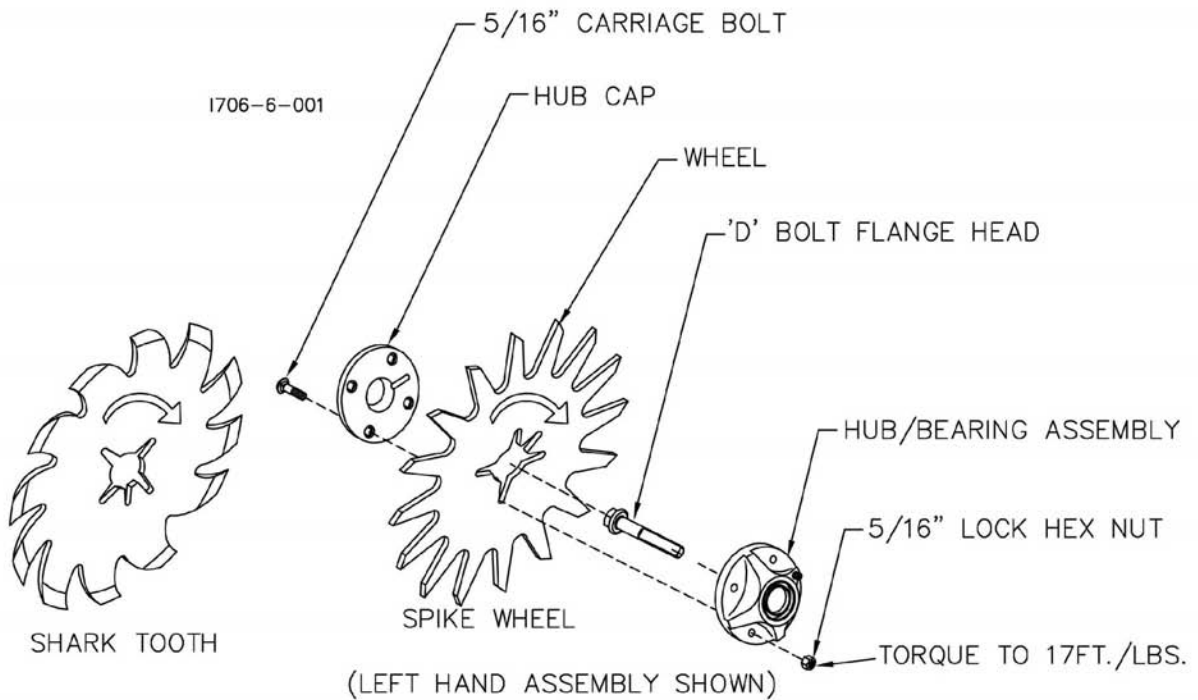

MAINTENANCE

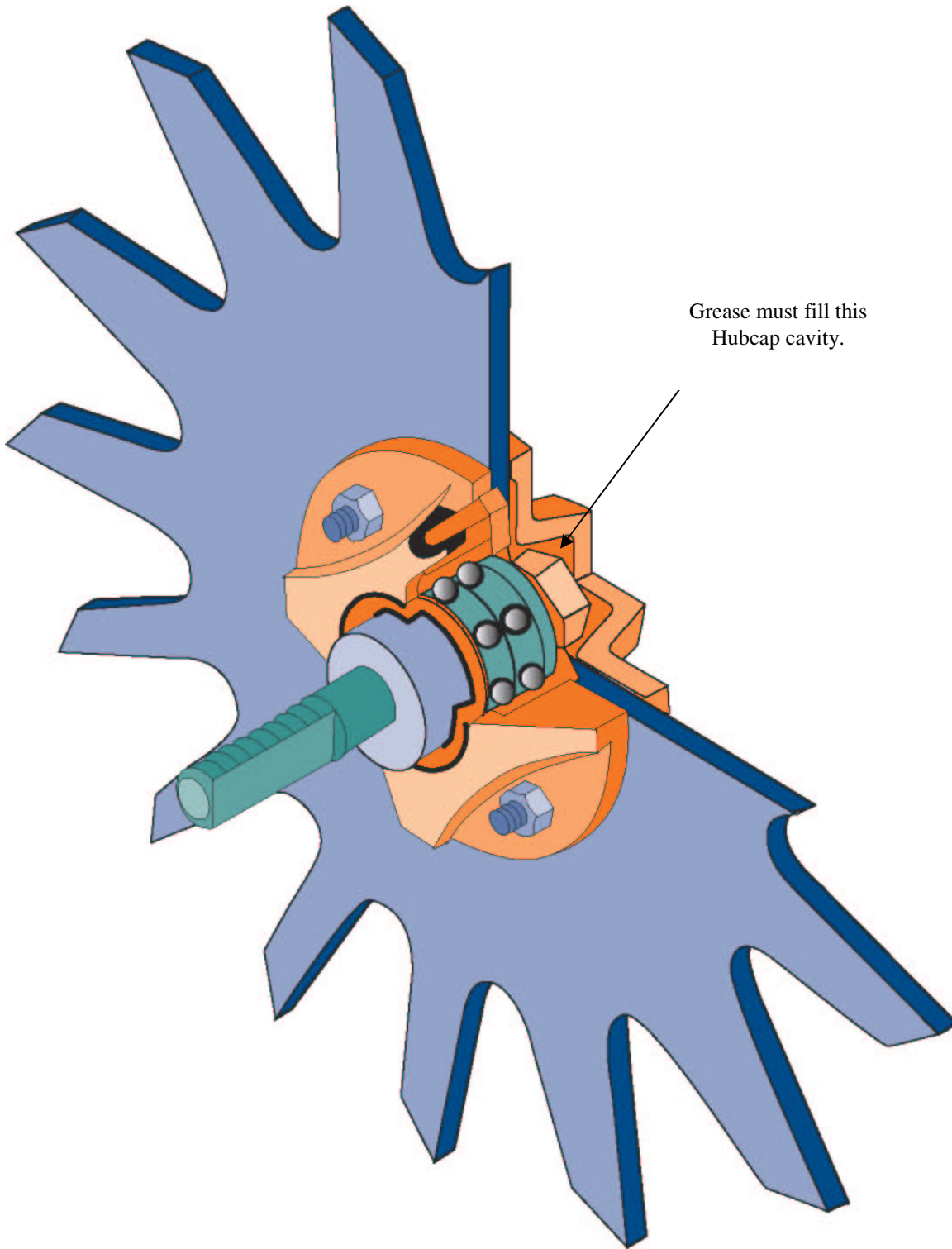

MAINTENANCE

Lubrication



CAUTION: To help prevent serious injury or death to you or others caused by unexpected movement, service machine on a level surface. Lower machine to ground or sufficiently lock or block raised machine before servicing. If machine is connected to tractor, engage parking brake and place transmission in "PARK", shut off engine and remove key. If machine is detached from tractor, block wheels and use shop stands to prevent movement.



CAUTION: Do not clean, lubricate, or adjust machine while in motion.

Use grease based on NLGI consistency numbers and the expected air temperature range during the service interval.

Use a **multi-purpose polyurea, water resistant, moderate speed, and NLGI grade #2** grease.

Other greases may be used if they meet the following **NLGI Performance Classification: GC-LB**

IMPORTANT: Some types of grease thickener are not compatible with others.

Consult your grease supplier before mixing different types of grease.

Alternative Lubricants

Conditions in certain geographical areas may require special lubricants and lubrication practices which do not appear in the operator's manual. If there are any questions, consult Yetter Manufacturing Co. to obtain latest information and recommendation.

PART #	DESCRIPTION	OUNCES OF GREASE
2967-404	13" TAPER TOOTH R.M. WHEEL	1.12 OZ
2967-602	13" SHARK TOOTH R.M. WHEEL	1.12 OZ
2967-186	FLOATER WHEEL KIT W/R.M. WHEEL	2.08 OZ
	BEVEL R.M. WHEEL W/ FLOATER WHEEL KIT	2.40 OZ

Storing Lubricants

Your machine can operate at top efficiency only if clean lubricants are used.

Use clean containers to handle all lubricants.

Store them in an area protected from dust, moisture and other contaminants.

MAINTENANCE

Lubrication Symbols



Lubricate with grease at hourly interval indicated on symbol.

Lubrication Intervals

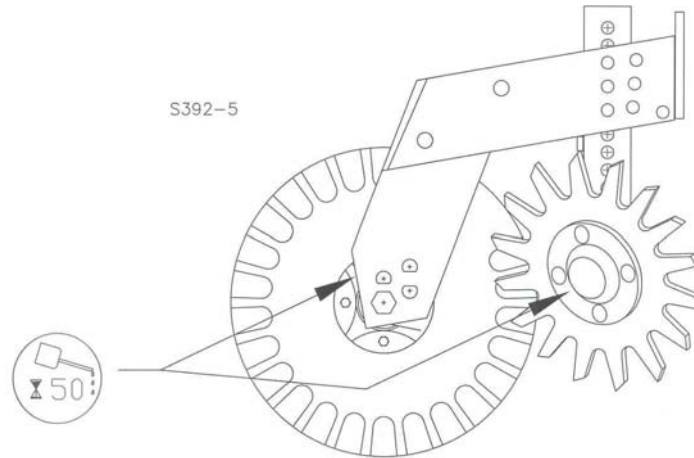

IMPORTANT: The recommended service intervals are based on normal conditions; severe or unusual conditions may require more frequent lubrication.

Perform each lubrication and service procedure at the beginning and end of each season. Clean grease fittings before using grease gun, to avoid injecting dirt and grit into the bearing. Replace any lost or broken fittings immediately. If a fitting fails to take grease, remove and clean thoroughly, replace fitting if necessary. Also check for failure of adjoining parts.

BEARING REPLACEMENT INSTALLATION

1. If you wish to be able to grease the bearings in the hubs, remove the seal from one side of the bearings as illustrated before assembly. Otherwise the bearings may be left "sealed for life".
2. When assembling the spoke wheels, bearing assembly and hubcap, be sure to align the grease transfer hole in the spoke wheel with the groove in the hubcap and hole in the hub to allow grease passage.
3. Install/assemble the wheels, hubs and caps.
4. Grease the wheel/hub/bearing assembly.

MAINTENANCE

Storing the Equipment

Store the machine in an area away from human activity

Store machine in RAISED position.

Install service locks on all wheel cylinders.

At the end of the season, the machine should be thoroughly inspected and prepared for storage. Repair or replace any worn or damaged components to prevent down time at the start of the next season. Store machine under cover with all parts in operating condition.

- Clean machine thoroughly to remove all dirt, debris and crop residue, which would hold moisture and cause rusting.
- Inspect machine for worn or broken parts. See your Yetter Farm Equipment dealer during the off-season so that parts or service can be acquired when machine is not needed in the field.
- Lubricate bearings as outlined in the Lubrication section
- Paint all parts which are chipped or worn and require repainting.
- Store machine in a clean, dry place with the planting unit out of the sun.
- If the machine cannot be stored inside, cover with a waterproof tarpaulin and tie securely in place.
- Do not allow children to play on or around the machine

PARTS IDENTIFICATION

2961 CUT AND MOVE

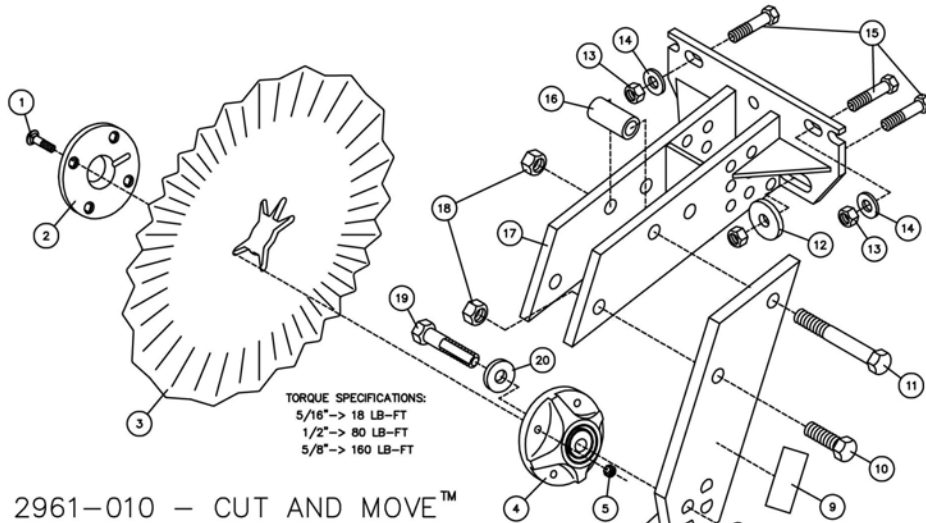

2961-010 - CUT AND MOVE™

DET	QTY	PART NO.	DESCRIPTION
1	4	2505-207	5/16-18 X 1 1/4 CAR BLT GR5 ZP
2	1	2965-352-DISC	HUB CAP CASTING, 4 BOLT, BLACK
3	1	2571-022	.118" X 13", 13 WAVE (3.25"BC)
	1	2571-189	.118X13" 25FLUTE BLADE, 4 BOLT
	1	2571-014	.140X14", 2 BEVEL SMOOTH BLADE
4	1	2965-128	HUB AND BEARING ASS'Y.,4 BOLT
	1	2550-069	SEAL, TRIPLE LIP, NTI# 1812-5
	1	2965-351	HUB CAST.,MACHINED, 4 BOLT
	1	2570-594	BEARING, 2 ROW NTN# DF0654LU
	1	2570-715	BEARING INSERT, TRASHMASTER
5	4	2520-206	5/16-18 FLANGE LOCK NUT
6	1	2961-300	COULTER ARM
7	1	2525-451	5/8 MED LOCKWASHER ZP
8	1	2520-452	5/8-11 HEX NUT ZP
9	1	2565-162	YETTER DECAL, 1-1/2 X 4-1/2
10	1	2502-331	5/8-11 X 1-3/4 HHCS GR. 5 ZP
11	1	2502-334	5/8-11 X 4-1/2 HHCS GR 5 ZP
12	1	2526-402	9/16 ID X 1-3/4 OD X 1/4 MB ZP
13	3	2520-357	1/2-13 LOCK HEX NUT ZP
14	2	2526-355	1/2 FLAT WASHER HARD'ND ZYD
15	3	2502-294	1/2-13 X 1-1/2 HHCS GR 5 ZYD
16	1	2961-301	SPACER, COULTER BRKT. ZYD.
17	1	2961-200	COULTER COMBO BRKT. W.A.
18	2	2520-459	5/8-11 LOCK HEX NUT ZP
19	1	2570-740	5/8-11 X 3" 'D' BOLT GR.5 ZYD
20	1	2527-530	1.50D X 21/32ID 3/16TK MA BU

TORQUE 150 FT.LBS.
1697-10

REVISED 10/27/16

PARTS IDENTIFICATION

2961 CUT AND MOVE

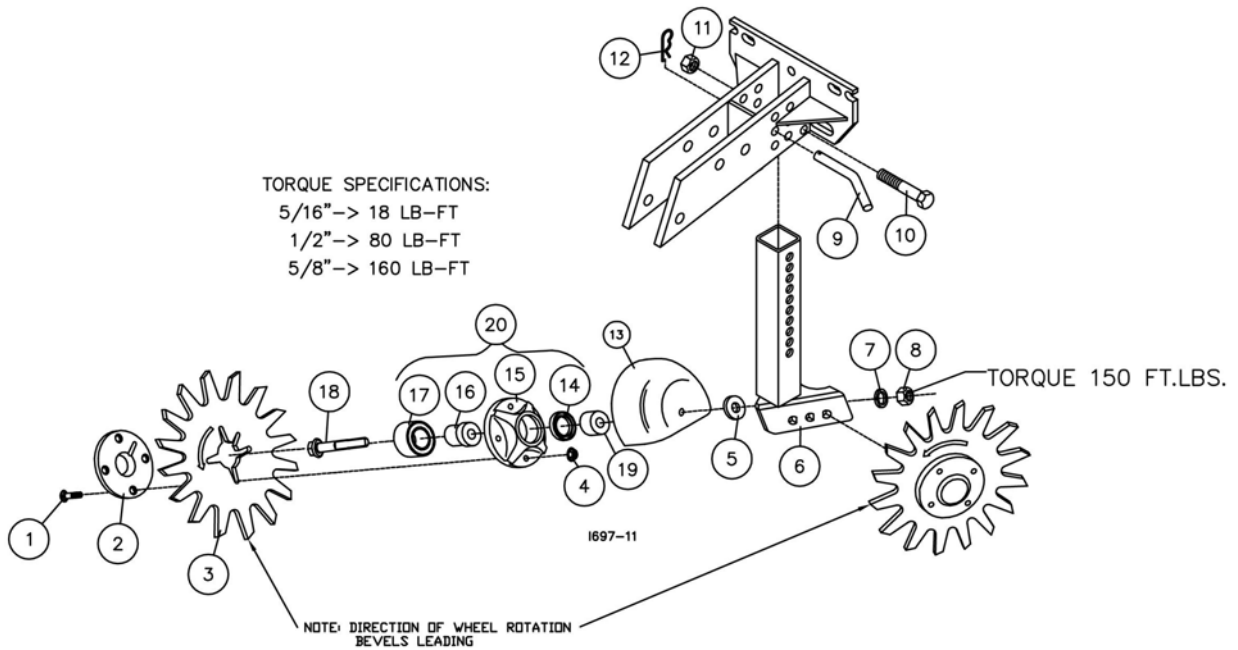

DET	QTY	PART NO.	DESCRIPTION
1	8	2505-208	5/16-18 X 1 1/2 CAR BLT GR5 ZP
2	2	2965-352	HUB CAP CASTING, 4 BOLT, BLACK
3	2	2967-404	13" TAPER TOOTH SPOKE WHEEL
		2967-602	SHARK TOOTH WHEEL (OPTIONAL)
4	8	2520-206	5/16-18 FLANGE LOCK HEX NUT ZP
5	2	2526-455	WASHER 21/32" X 1 1/4" X 1/4"
6	1	2967-247	RESIDUE MGR STEM W.A.-750/1850
7	2	2525-451	5/8 MED LOCKWASHER ZP
8	2	2520-452	5/8-11 HEX NUT ZP
9	1	6100-321	TRANSPORT PIN LOCK ZYD
10	1	2502-316	1/2-13 X 3-1/2 HHCS GR 5 ZP
11	1	2520-357	1/2-13 LOCK HEX NUT ZP
12	1	2570-448	1/8 STANDARD HAIRPIN COTTER ZP
13	2	2967-336	R.M. SHIELD, PAINTED, W. HOLE
14	2	2550-069	SEAL, TRIPLE LIP, NTI# 1812-5
15	2	2965-351	HUB CAST.,MACHINED, 4 BOLT
16	2	2570-715	BEARING INSERT, TRASHMASTER
17	2	2570-594	BEARING, 2 ROW NTN# DF0654LU
18	2	2570-742	5/8-11 X 4" 'D' BOLT GR.8 ZYD
19	2	2967-302	SPACER, 3/4" ZYD
20	2	2965-128	HUB AND BEARING ASS'Y, 4 BOLT

REVISED 11/14/16

PARTS IDENTIFICATION

2961-015-ST
SCREW ADJ. CUT & MOVE (SHARKTOOTH)

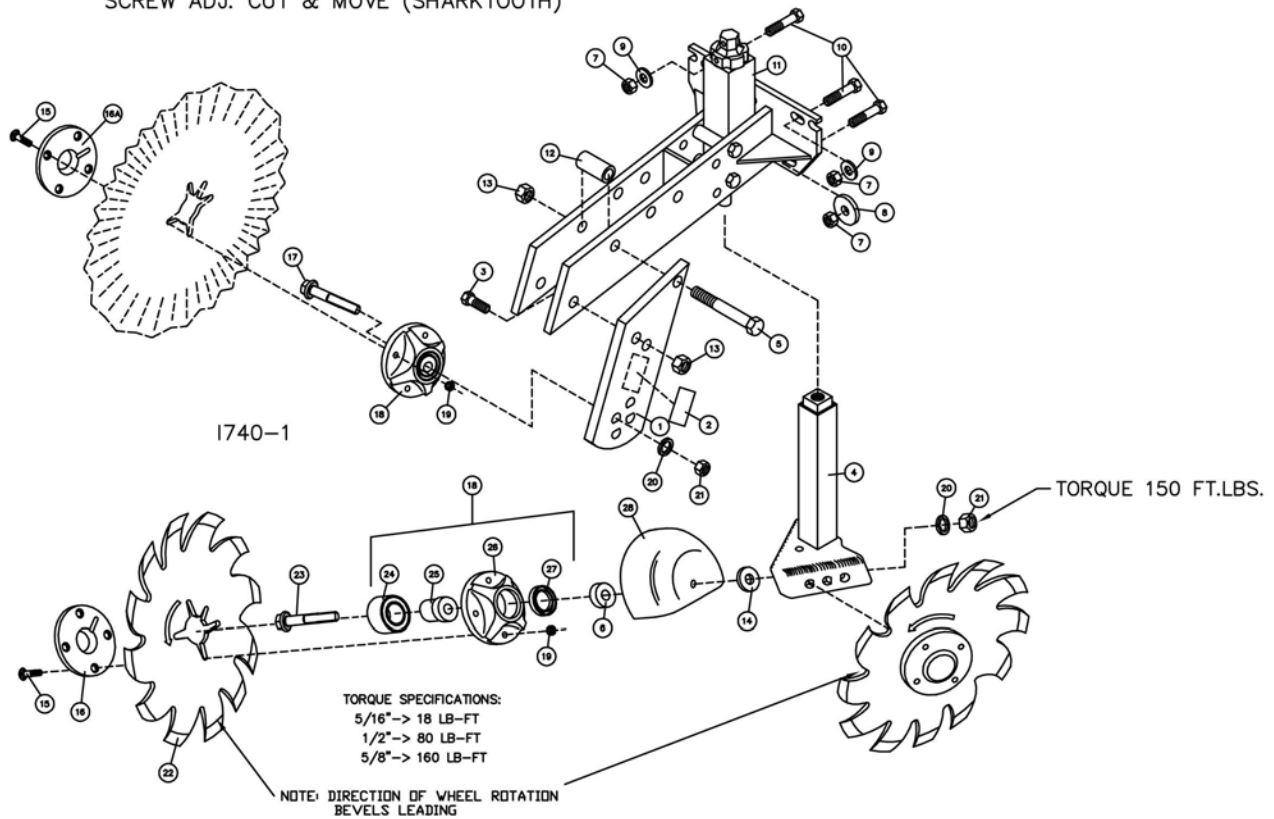

DET	QTY	PART NO.	DESCRIPTION	DET	QTY	PART NO.	DESCRIPTION
1	1	2961-305	COULTER ARM, CNH	16	1	2965-352	HUB CAP CASTING, 4 BOLT, BLACK
2	1	2565-162	YETTER DECAL, 1-1/2 X 4-1/2	16A	1	2965-352-DISC	HUB CAP CASTING, 4 BOLT, BLACK
3	1	2502-331	5/8-11 X 1-3/4 HHCS GR. 5 ZP	17	1	2570-740	5/8-11 X 3" 'D' BOLT GR. 5 ZYD
4	1	2966-206	ADJUSTMENT STEM W.A.	18	3	2965-128	HUB AND BEARING ASS'Y., 4 BOLT
5	1	2502-334	5/8-11 X 4-1/2 HHCS GR 5 ZP	19	12	2520-206	5/16-18 FLANGE LOCK NUT
6	2	2967-302	SPACER, 3/4" ZYD	20	3	2525-451	5/8 MED LOCKWASHER ZP
7	3	2520-357	1/2-13 LOCK HEX NUT ZP	21	3	2520-452	5/8-11 HEX NUT ZP
8	1	2526-402	9/16 ID X 1-3/4 OD X 1/4 MB ZP	22	2	2967-602	13" SHARK TOOTH WHEEL
9	2	2526-355	1/2 FLAT WASHER HARD'ND ZYD	23	2	2570-742	5/8-11 X 4" 'D' BOLT GR.8 ZYD
10	3	2502-294	1/2-13 X 1-1/2 HHCS GR 5 ZYD	24	3	2570-594	BEARING, 2 ROW NTN# DF0654LU
11	1	2966-128	SCREW ADJ ASSY, CUT & MOVE	25	3	2570-715	BEARING INSERT, TRASHMASTER
12	1	2961-301	SPACER, COULTER BRKT. ZYD.	26	3	2965-351	HUB CAST., MACHINED, 4 BOLT
13	2	2520-459	5/8-11 LOCK HEX NUT ZP	27	3	2550-069	SEAL, TRIPLE LIP, NTI# 1812-5
14	2	2526-455	WASHER 21/32" X 1-1/4" X 1/4"	28	2	2967-336	R.M. SHIELD, PAINTED, W. HO
15	12	2505-208	5/16-18 X 1 1/2 CAR BLT GR5 ZP				

REVISED 10/27/16

PARTS IDENTIFICATION

2961-016-ST

NARROW ROW SCREW ADJ. CUT & MOVE (SHARKTOOTH)

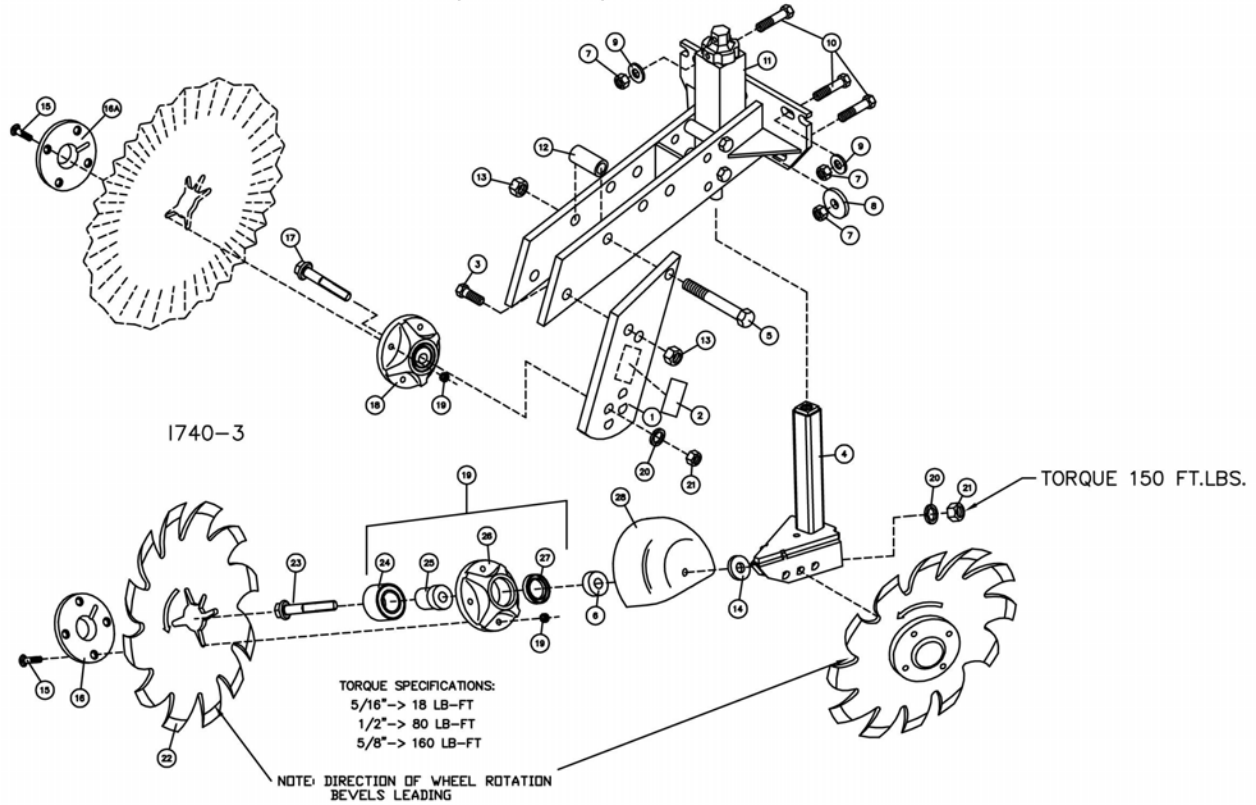

DET	QTY	PART NO.	DESCRIPTION	DET	QTY	PART NO.	DESCRIPTION
1	1	2961-305	COULTER ARM, CNH	16	1	2965-352	HUB CAP CASTING, 4 BOLT, BLACK
2	1	2565-162	YETTER DECAL, 1-1/2 X 4-1/2	16A	1	2965-352-DISC	HUB CAP CASTING, 4 BOLT, BLACK
3	1	2502-331	5/8-11 X 1-3/4 HHCS GR. 5 ZP	17	1	2570-740	5/8-11 X 3" 'D' BOLT GR. 5 ZYD
4	1	2966-211	NARROW ADJUST STEM W.A.	18	3	2965-128	HUB AND BEARING ASS'Y., 4 BOLT
5	1	2502-334	5/8-11 X 4-1/2 HHCS GR 5 ZP	19	12	2520-206	5/16-18 FLANGE LOCK NUT
6	2	2967-302	SPACER, 3/4" ZYD	20	3	2525-451	5/8 MED LOCKWASHER ZP
7	3	2520-357	1/2-13 LOCK HEX NUT ZP	21	3	2520-452	5/8-11 HEX NUT ZP
8	1	2526-402	9/16 ID X 1-3/4 OD X 1/4 MB ZP	22	2	2967-602	13" SHARK TOOTH WHEEL
9	2	2526-355	1/2 FLAT WASHER HARD'ND ZYD	23	2	2570-742	5/8-11 X 4" 'D' BOLT GR.8 ZYD
10	3	2502-294	1/2-13 X 1-1/2 HHCS GR 5 ZYD	24	3	2570-594	BEARING, 2 ROW NTN# DF0654LU
11	1	2966-128	SCREW ADJ ASSY, CUT & MOVE	25	3	2570-715	BEARING INSERT, TRASHMASTER
12	1	2961-301	SPACER, COULTER BRKT. ZYD.	26	3	2965-351	HUB CAST., MACHINED, 4 BOLT
13	2	2520-459	5/8-11 LOCK HEX NUT ZP	27	3	2550-069	SEAL, TRIPLE LIP, NTI# 1812-5
14	2	2526-455	WASHER 21/32" X 1-1/4" X 1/4"	28	2	2967-336	R.M. SHIELD, PAINTED, W. HO
15	12	2505-208	5/16-18 X 1 1/2 CAR BLT GR5 ZP				

REVISED 10/27/16

PARTS IDENTIFICATION

2961-011 - CNH CUT AND MOVE

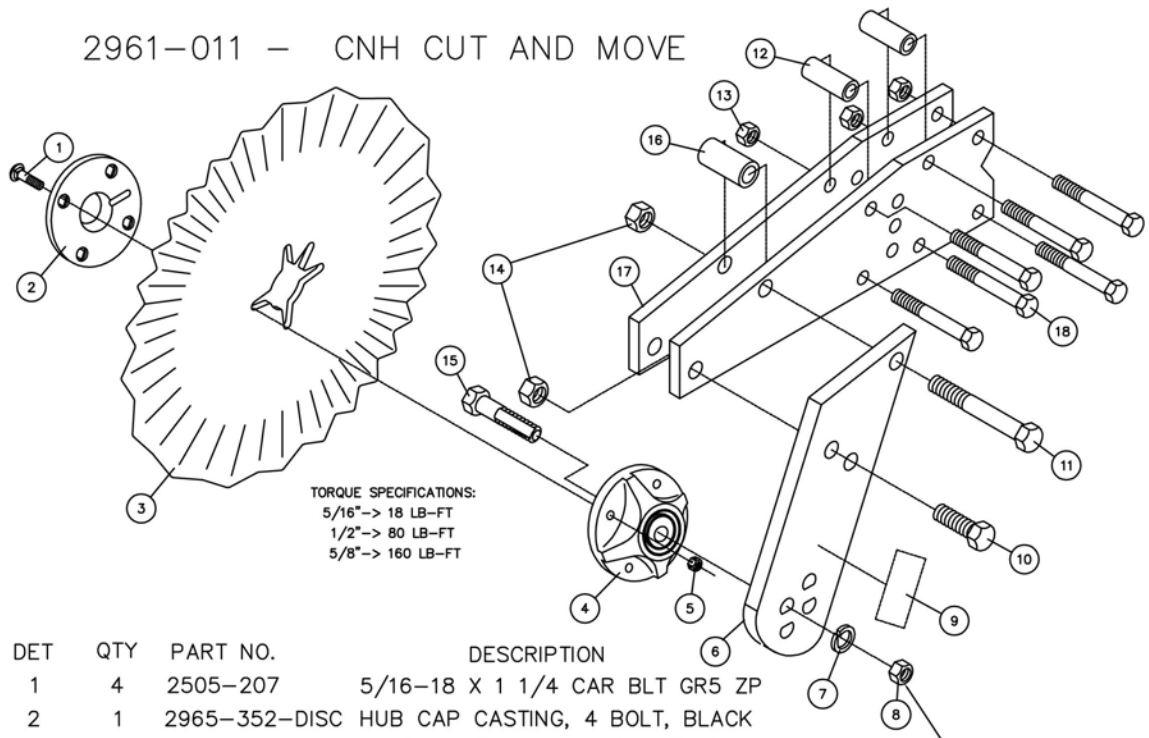

DET	QTY	PART NO.	DESCRIPTION
1	4	2505-207	5/16-18 X 1 1/4 CAR BLT GR5 ZP
2	1	2965-352-DISC	HUB CAP CASTING, 4 BOLT, BLACK
3	1	2571-022	.118" X 13", 13 WAVE (3.25"BC)
	1	2571-189	.118X13" 25FLUTE BLADE, 4 BOLT
	1	2571-014	.140X14", 2 BEVEL SMOOTH BLADE
4	1	2965-128	HUB AND BEARING ASS'Y., 4 BOLT
	1	2550-069	SEAL, TRIPLE LIP, NTN# 1812-5
	1	2965-351	HUB CAST., MACHINED, 4 BOLT
	1	2570-594	BEARING, 2 ROW NTN# DF0654LU
	1	2570-715	BEARING INSERT, TRASHMASTER
5	4	2520-206	5/16-18 FLANGE LOCK NUT
6	1	2961-305	COULTER ARM, CNH
7	1	2525-451	5/8 MED LOCKWASHER ZP
8	1	2520-452	5/8-11 HEX NUT ZP
9	1	2565-162	YETTER DECAL, 1-1/2 X 4-1/2
10	1	2502-331	5/8-11 X 1-3/4 HHCS GR. 5 ZP
11	1	2502-334	5/8-11 X 4-1/2 HHCS GR 5 ZP
12	4	2984-349	SUPPORT BUSHING
13	6	2520-357	1/2-13 LOCK HEX NUT ZP
14	2	2520-459	5/8-11 LOCK HEX NUT ZP
15	1	2570-740	5/8-11 X 3" 'D' BOLT GR.5 ZYD
16	1	2961-301	SPACER, COULTER BRKT. ZYD.
17	2	2961-304	MOUNT PLATE, CNH
18	6	2502-316	1/2-13 X 3-1/2 HHCS GR 5 ZYD.

1717-8

REVISED 10/27/16

PARTS IDENTIFICATION

DET	QTY	PART NO.	DESCRIPTION
1	8	2505-208	5/16-18 X 1 1/2 CAR BLT GR5 ZP
2	2	2965-352	HUB CAP CASTING, 4 BOLT, BLACK
3	2	2967-404	13" TAPER TOOTH SPOKE WHEEL
4	8	2520-206	5/16-18 FLANGE LOCK NUT
5	2	2526-455	WASHER 21/32" X 1 1/4" X 1/4"
6	1	2967-200	RESIDUE MGR STEM W.A.
7	2	2525-451	5/8 MED LOCKWASHER ZP
8	2	2520-452	5/8-11 HEX NUT ZP
9	1	6100-321	TRANSPORT PIN LOCK ZYD
10	1	2502-316	1/2-13 X 3-1/2 HHCS GR 5 ZP
11	1	2520-357	1/2-13 LOCK HEX NUT ZP
12	1	2570-448	1/8 BOWTIE LOCKING COTTER ZYD
13	2	2967-336	R.M. SHIELD, PAINTED, W. HOLE
14	2	2550-052	SEAL, CR# 13548
15	2	2965-351	HUB CAST.,MACHINED, 4 BOLT
16	2	2570-715	BEARING INSERT, TRASHMASTER
17	2	2570-594	BEARING, 2 ROW NTN# DF0654LU
18	2	2570-742	5/8-11 X 4" "D" BOLT GR.8 ZYD
19	2	2967-302	SPACER, 3/4" ZYD

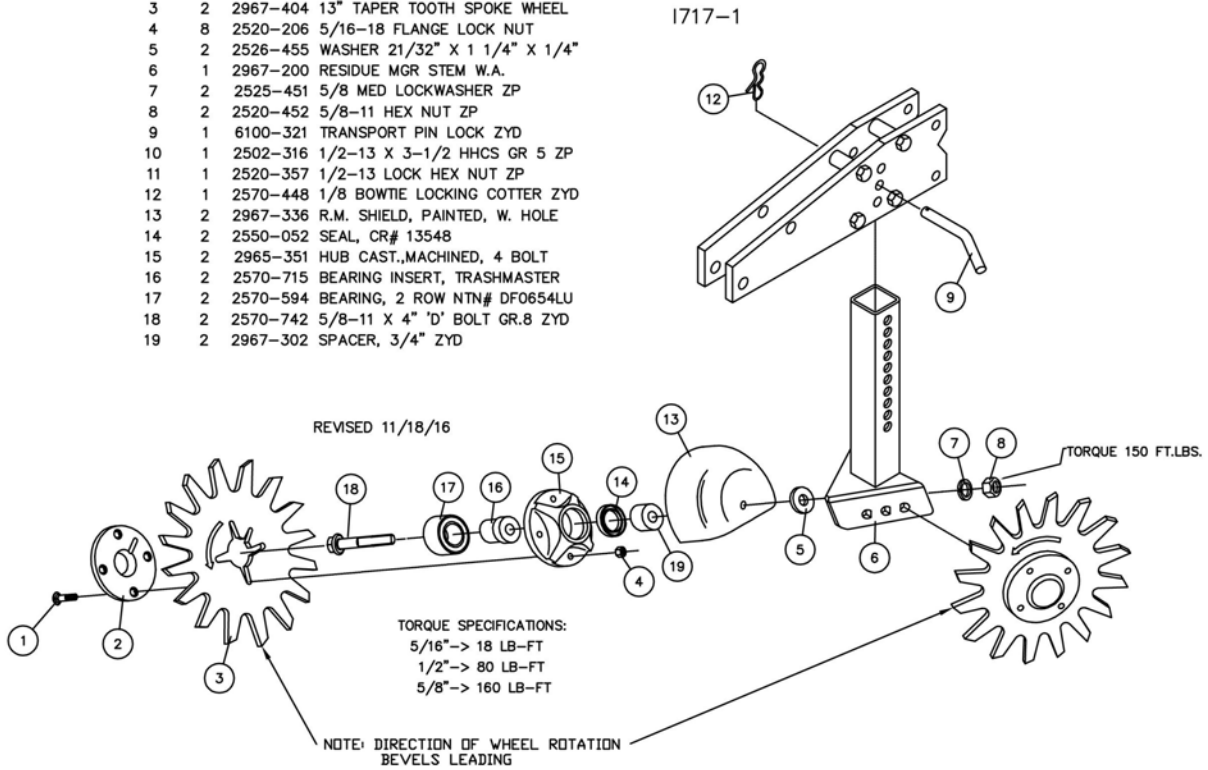

PARTS IDENTIFICATION

2966-128, SCREW ADJ ASSY, CUT & MOVE

DET	QTY	PART NO.	DESCRIPTION
1	1	2967-699	ADJUSTMENT KNOB (9/07)
2	1	2530-158	PIN, COILED SPRING, 1/4X1-1/2, HD
3	1	2526-453	5/8 SAE FLATWASHER ZP
4	1	2966-215	HOUSING SCREW ADJ., W.A.
5	1	2533-110	1/4-28 ZERK STRAIGHT SELF-TAP
6	1	2967-657	ACME SCREW
7	3	2510-102	#10-32 X .25 HEX SOCKET HD ZYD.
8	1	2526-456	BVLE DISC SPRG .630 IDX 1.250D
9	1	2967-652	DETENT PLATE
10	2	2502-316	1/2-13 X 3-1/2 HHCS GR 5 ZYD
11	2	2520-357	1/2-13 HEX LOCK NUT ZYD
12	1	2961-202	SCREW ADJUST MOUNT BRKT W.A.

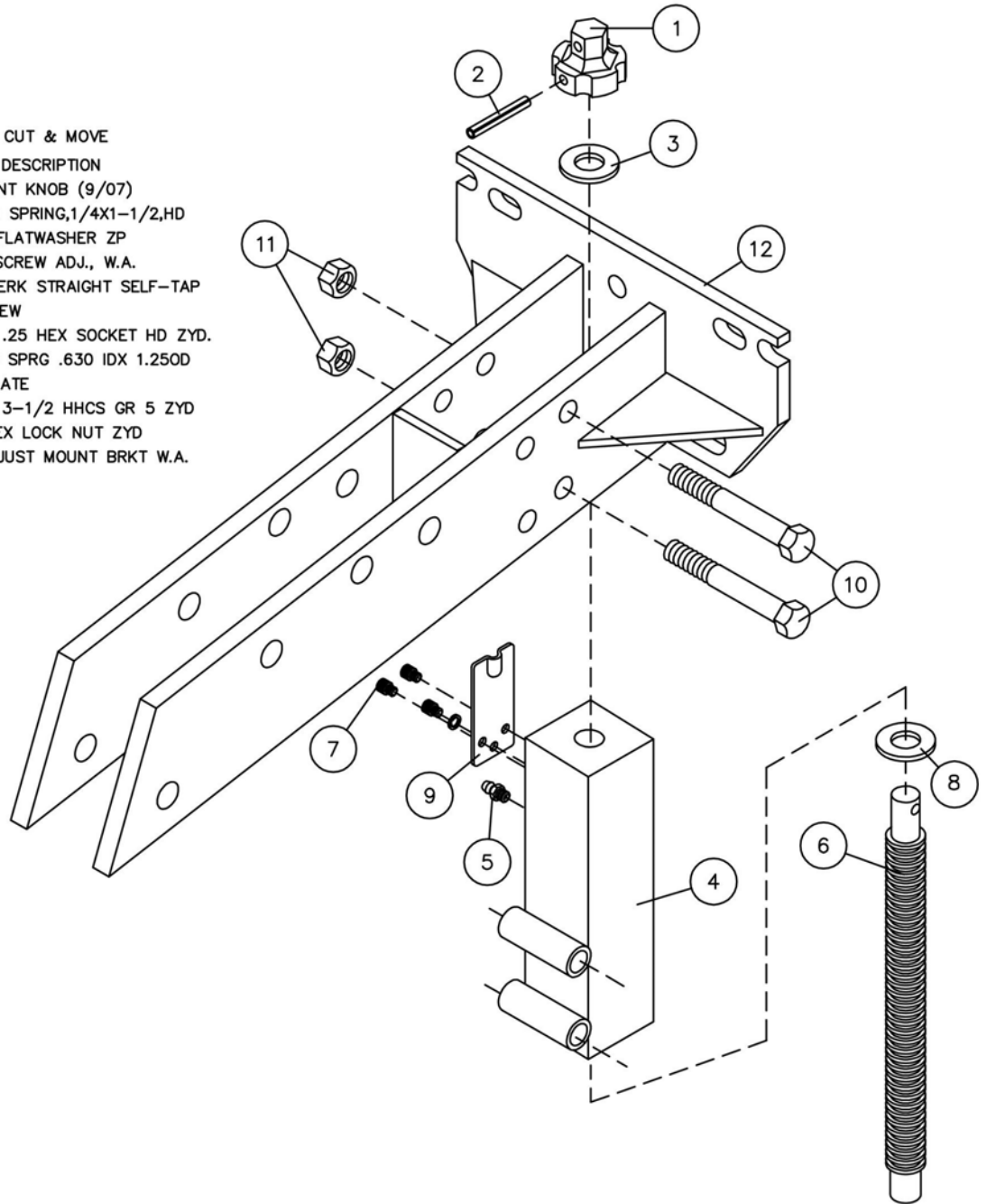

1740-6

TROUBLESHOOTING

Problem	Cause	Solution
Cannot adjust coulter depth shallow enough.	Planter frame not set correctly.	Ensure that in operation the planter frame is at correct height (20"-22") and level.
	Planter opener blade worn.	Replace planter opener blades.
Cannot adjust coulter deep enough.	Coulter blade worn too small.	Replace coulter blade.
Coulter will not penetrate.	Lack of spring tension.	Increase spring tension.
Coulter penetrates too much.	Excessive spring down pressure.	Reduce spring tension.
Seed placement is too deep.	Coulter blade set too deep relative to openers.	Shallow up coulter depth.
Optional wavy blade disturbs too much soil.	Planter frame not level front to back.	Raise planter drawbar to level planter frame.
	Soil too damp or loose.	Reduce ground speed.
		Install a less aggressive blade. 14" Smooth Blade is available.
No spring tension.	Planter frame not set correctly.	Check planter frame settings, see above.
	Broken springs.	Replace broken or damaged parts.
Residue manager wheels are plugging with corn stalks.	High amount of residue. Residue is damp/tough.	Coulter blade dull, replace blade.
	Bt. Hybrid corn. Excessively long stalks.	Coulter blade dull, replace blade.
Residue manager wheels are aggressive in loose or tilled soils.	Row unit down pressure is excessive.	Decrease row unit down pressure.
	Planter frame not level.	Level the planter frame.

NOTES:

NOTES:

Our name Is getting known

Just a few years ago, Yetter products were sold primarily to the Midwest only. Then we embarked on a program of expansion and moved into the East, the South, the West and now north into Canada. We're even getting orders from as far away as Australia and Africa.

So, when you buy Yetter products . . .you're buying a name that's recognized. A name that's known and respected. A name that's become a part of American agriculture and has become synonymous with quality and satisfaction in the field of conservation tillage.

Thank you.

YETTER MANUFACTURING CO.

Colchester, IL 62326-0358 • 309/776-4111

Toll Free 800/447-5777

Fax 309/776-3222

Website: WWW.YETTERCO.COM

E-MAIL: INFO@YETTERCO.COM