



**2984 MAVERICK OPENER™**  
**GENERATION II**  
**OPERATOR & PARTS MANUAL**  
2565-679\_REV\_B 11/2016

**YETTER MANUFACTURING CO.**  
*FOUNDED 1930*

Colchester, IL 62326-0358  
Toll free: 800/447-5777  
309/776-3222 (Fax)  
Website: [www.yetterco.com](http://www.yetterco.com)  
E-mail: [info@yetterco.com](mailto:info@yetterco.com)

**YETTER**

# TABLE OF CONTENTS

	Page
Warranty.....	3
Safety	
Symbols and Meanings.....	3-4
General Information	
Torque specifications.....	6-7
Assembly instructions	
2984-002 – Maverick Opener.....	8-12
2984-003 – Residue Manager.....	13-15
2984-004 – Soil Disruption Guard.....	16-18
2984-005/006 – Disc Sealer.....	19-22
2984-008 – V-Closing Wheels.....	23-26
2984-009 – 4.5” x 16” Wheel Sealer.....	27-29
Operation	
Toolbar Adjustment.....	30-31
Coulter Blade.....	32
Knife Setting.....	32
Soil Disruption Guard.....	33
Residue Manager.....	33
Disc Sealer.....	33
V-Closing Wheels.....	34
4.5” x 16” Wheel Sealer.....	35
Maintenance.....	36-42
Parts Identification	
2984-002 – Maverick II Opener.....	43
2984-003 – Residue Manager Assembly.....	44
2984-004 – Soil Disruption Guard.....	45
2984-007 – Disc Sealer.....	46
2984-008 – V-Closing Wheels.....	47
6000-002 – V-Closing Wheels.....	48
2984-009 – 4.5” x 16” Sealer Wheels.....	49
3000-122 – Parallel Arm Assembly.....	50
3000-131 – Mount Plate (Hinge Area).....	51
Trouble Shooting.....	52

## FOREWORD

You've just joined an exclusive but rapidly growing club.

For our part, we want to welcome you to the group and thank you for buying a Yetter product.

We hope your new Yetter products will help you achieve both goals-increase your productivity and increase your efficiency so that you may generate more profit.

This operator's manual has been designed into four major sections: Foreword, Safety Precautions, Installation Instructions and Parts Breakdown.

 This **SAFETY ALERT SYMBOL** indicates important safety messages in the manual. When you see this symbol, be alert to the possibility of **PERSONAL INJURY** and carefully read the message that follows.

The word **NOTE** is used to convey information that is out of context with the manual text. It contains special information such as specifications, techniques and reference information of a supplementary nature.

The word **IMPORTANT** is used in the text when immediate damage will occur to the machine due to improper technique or operation. Important will

apply to the same information as specified by note only of an immediate and urgent nature.

It is the responsibility of the user to read the operator's manual and comply with the safe and correct operating procedure and to lubricate and maintain the product according to the maintenance schedule in the operator's manual.

The user is responsible for inspecting his machine and for having parts repaired or replaced when continued use of the product would cause damage or excessive wear to the other parts.

It is the user's responsibility to deliver his machine to the Yetter dealer who sold him the product for service or replacement of defective parts, which are covered by the warranty policy.

If you are unable to understand or follow the instructions provided in this publication, consult your local Yetter dealer or contact:

### **YETTER MANUFACTURING CO.**

309/776-4111

800/447-5777

309/776-3222 (FAX)

Website: [www.yetterco.com](http://www.yetterco.com)

E-Mail: [info@yetterco.com](mailto:info@yetterco.com)

## WARRANTY

Yetter Manufacturing warrants all products manufactured and sold by it against defects in material. This warranty being expressly limited to replacement at the factory of such parts or products as shall appear to be defective after inspection. This warranty does not obligate the Company to bear cost of labor in replacement of parts. It is the policy of the Company to make improvements without incurring obligations to add them to any unit already sold. No warranty is made or authorized to be made, other than herein set forth. This warranty is in effect for one year after purchase.

Dealer \_\_\_\_\_

**Yetter Manufacturing warrants its own products only and cannot be responsible for damages to equipment on which mounted.**

# SAFETY

**A brief description of signal words that may be used in this manual:**

**CAUTION:** Used as a general reminder of good safety practices or to direct attention to unsafe practices.

**WARNING:** Denotes a specific potential hazard

**DANGER:** Denotes the most serious specific potential hazard.

## SAFETY PRECAUTIONS

You can make your farm a safer place to live and work if you observe the safety precautions given. Study these precautions carefully and insist that they be followed by those working with you and for you.

Finally, remember this: an accident is usually caused by someone's carelessness, neglect or oversight.



### WARNING

Never clean, lubricate or adjust a machine that is in motion. Always lower or block the implement before performing service.

If machine must be serviced in the raised position, jack or block it up to prevent it from accidentally falling and injuring someone.

Do not allow riders on the tractor or implement.

Use speeds and caution dictated by the terrain being traversed. Do not operate on any slope steep enough to cause tipping or loss of control.

Be sure all personnel are clear of the immediate area before operating.

Read and understand the operator's manual and require all other persons who will operate the equipment to do the same.

Be familiar with all tractor and implement controls and be prepared to stop engine and implements quickly in an emergency.



### CAUTION

Consult your implement and tractor operator's manual for correct and safe operating practices.

Beware of towed implement width and allow safe clearance.

**FAILURE TO HEED MAY RESULT IN PERSONAL INJURY OR DEATH.**

## INTRODUCTION

The 2984 Maverick Opener<sup>®</sup> Unit has been specifically designed for strip-till and those users who demand the utmost in accuracy of fertilizer placement along with the durability and capability to perform at least one other operation in the field simultaneously.

The Maverick Opener<sup>®</sup> is a combination of existing and new technologies. The unit is based on our patented parallel arms and attaches to a toolbar with a rugged clamp bracket casting. The main frames are heavy twin 5/8" x 5" plates, which includes punched holes, for mounting of various attachments. The formed knife plates are attached by 5/8" grade 5 bolts. The fertilizer knife is attached to the lower part of the knife plate using grade 8 bolts. The upper rear part of the knife plate has provisions for attachment of either a disc sealer or a wheel sealer with 4.5 x 16 gauge wheel tires.

This is a very versatile unit that may be complemented by other Yetter attachments, such as the 2984-004 depth control and 2984-003 residue manager.

## OPERATION

The Maverick Opener<sup>®</sup> is a universal tool designed for use in any fertilizer management program. The Maverick Opener<sup>®</sup> is the ultimate unit when properly equipped for; Fall strip tillage, Spring pre-plant, Summer side-dressing and Fumigation.

The unit when equipped with sealing wheels is ideal for controlling soil disturbance and leaving a level soil surface with the fertilizer sealed in. The unit equipped with sealing discs may be set up to close the knife slot with the blades pushing or with the blades turned to pull, form a mound or "berm" of soil over the knife slot to seal in the fertilizer.

It is important to remember that the Maverick Opener<sup>®</sup> unit is similar to a planter unit in operation, thus it is very important to adjust the frame height and levelness for best performance.

Soil conditions (i.e.; frozen soil, rocks, heavy, tough residue) have an influence on performance. If damp soil is building up on the wheels, discs or knives then it is less than optimum conditions to operate, thus the Maverick Opener<sup>®</sup> will not work at it's best.



**CAUTION** Frozen soil or heavy rock population may cause damage to the Maverick Opener<sup>®</sup>.

Note: In soil where rocks are present, it is recommended to use a 22" diameter blade(2571-196).

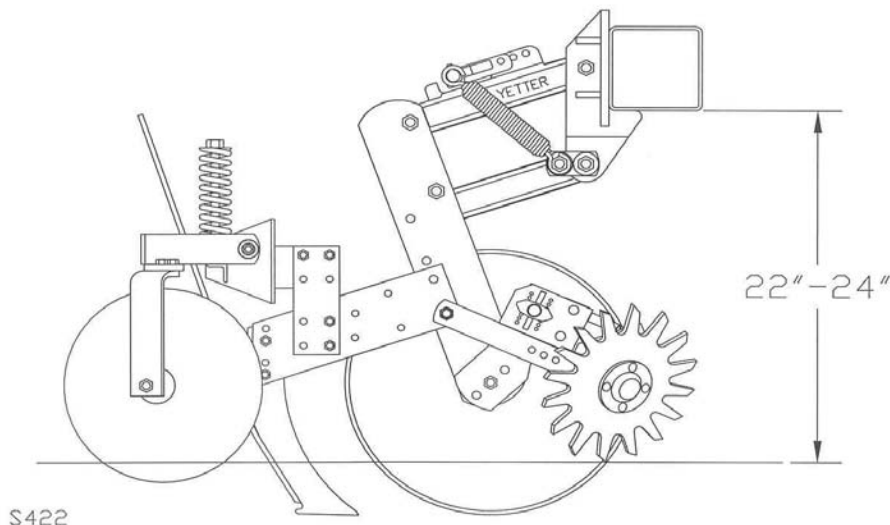

## GENERAL INFORMATION

Examine all equipment carefully for damage or parts shortages.

### 2984-002 – MAIN BODY ASSEMBLY

Includes: 1.) 2984-102 – PARTS BOX  
1.) 3000-122 – PARALLEL ARM ASSEMBLY

### Optional Equipment

Blade options:                   2571-199 – 20" SMOOTH BLADE  
                                      2571-196 – 22" SMOOTH BALDE

Knife option:                    2920-204 – STANDARD NH3 KNIFE

Residue Manager option:    2984-003 - R.M. ASSEMBLY, GEN II MAVERICK

Depth Control option:        2984-004 - DEPTH CONTROL/S.D.G., MAVERICK

WHEN USED

Sealing option:                2984-005 – 13 5/8" NOTCHED DISCS                   (FALL, SPRING)  
                                      2984-006 – 16" SMOOTH DISCS                         (FALL, SPRING)  
                                      2984-005 – QUICK ADJ. V-CLOSING 1X12 WHEEL   (SIDE DRESS, SPRING)  
                                      2984-009 – WHEEL SEALER 4.5 X 16 WHEEL       (SIDE DRESS, SPRING)

U-bolt mounting kit option:   3000-109 - 4 X 4 U-BOLT KIT  
                                      6000-010 - 5 X 7 PLANTER U-BOLT KIT  
                                      6000-011 - 7 X 7 PLANTER U-BOLT KIT

*Note: Toolbars are measured width x height*

# GENERAL INFORMATION



Note: Right hand and left hand designations are based on sitting in the tractor and facing forward.

## BOLT TORQUE

**READ THESE INSTRUCTIONS FIRST:**

1. Improperly tightened bolts will result in damage, breakage, expense, and down time.
2. Always replace bolts with the specified grade and type.
3. Torque properly before first use of the machine and every 2-4 hours of use until you are sure bolts are staying tight.
4. The chart below is a guide for proper torque. Use it unless a specified torque is called out elsewhere in the manual.
5. Torque is the force you apply to the wrench handle or the cheater bar, times the length of the handle or bar.
6. Use a torque wrench whenever possible.

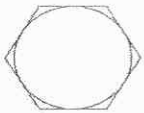
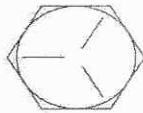
The following table shows torque in ft. lbs.

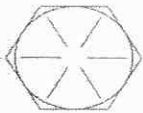
BOLT DIA. AND THREADS PER INCH	 GRADE 2	 OR  GRADE 5 A-325	 GRADE 8
1/4	6	10	14
5/16	12	20	30
3/8 - 16	25	35	50
7/16 - 14	35	55	80
1/2 - 13	55	85	125
9/16 - 12	75	125	175
5/8 - 11	105	170	235
3/4 - 10	185	305	425
7/8 - 9	170	445	690
1-8	260	670	1030
1 1/8 - 7	365	900	1460
1 1/4 - 7	515	1275	2060
1 3/8 - 6	675	1675	2700
1 1/2 - 6	900	2150	3500
1 3/4 - 5	1410	3500	5600

**Lubricate all bearings and moving parts as assembled and make certain that they work freely.**



**WARNING:** Never work around the toolbar / implement while in a raised position without using safety lockups.



**CAUTION:** The Maverick opener and its attachments are very heavy. Extra attention to lifting techniques while handling and or maneuvering the opener during assembly. Failure to do so may lead to personal injury.

# ASSEMBLY INSTRUCTIONS

## 2984-002 – MAVERICK OPENER GEN II

**STEP 1.** Mark the location of the center of each row on the toolbar. Then measure from row 4" and place a mark on the rear side of toolbar. This mark will give a reference point to where the edge of the clamp bracket (3000-368) should be located so that the fertilizer knife will be centered directly on the row.

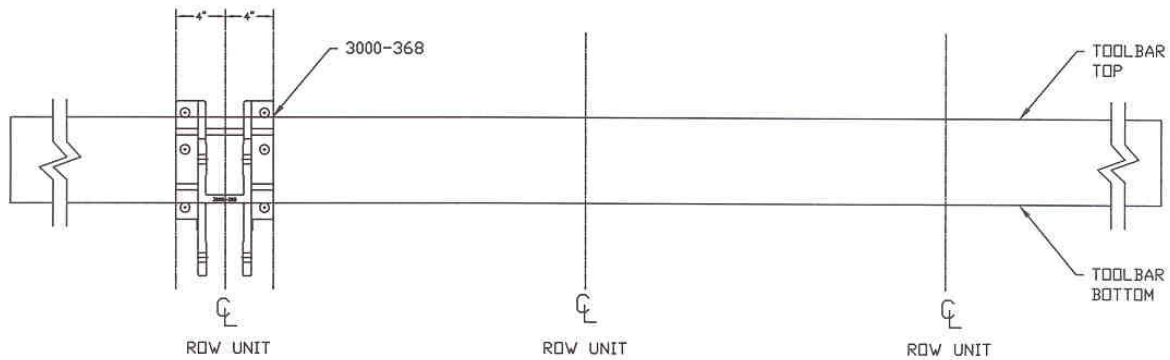

L374-2

**STEP 2.** Centering on each row, attach the (3000-122) parallel arm assembly to the toolbar with the appropriate 3/4" u-bolts, lock washers and hex nuts. Torque the u-bolts to 200 ft. lbs. Recheck the torque after 10 hours of use.

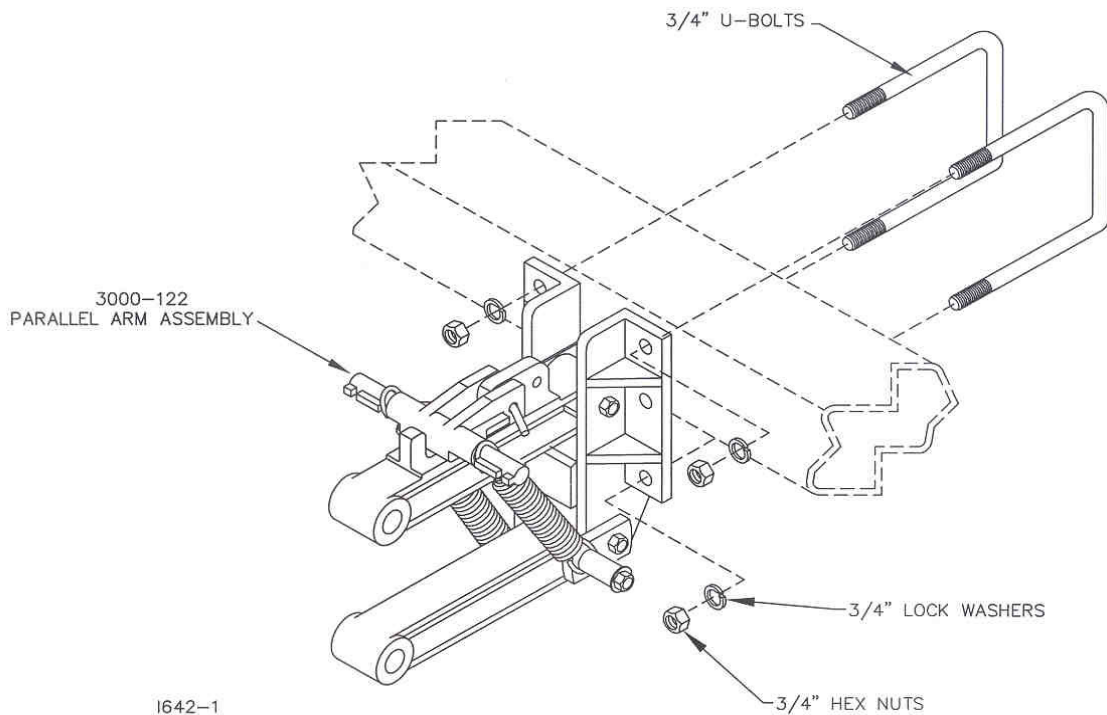

1642-1



## ASSEMBLY INSTRUCTIONS

**STEP 3.** Insert the 2960-370 - 3 13/64" spacer bushings into the parallel arms of 3000-122 parallel arm assembly.

**IMPORTANT!!!!!!** Apply never-seize lubricant to the bushings before using the Maverick Opener™.

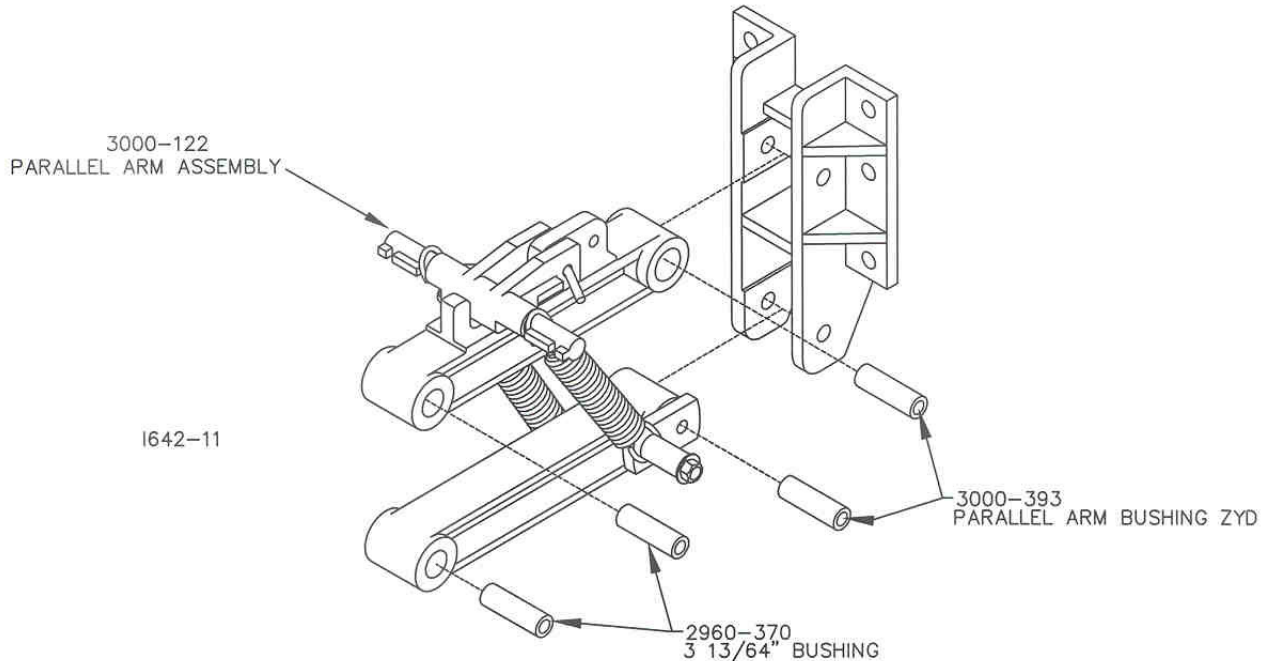

**STEP 4.** Insert 3) 2502-397 – 5/8" X 5 1/2" bolts through the hub plate 2984-308 (decals should face out from center of the row) and attach to the parallel arm assembly. Place the second hub plate 2984-308 onto the 5/8" bolts. Install the 5/8" lock nuts, do not fully tighten at this time.

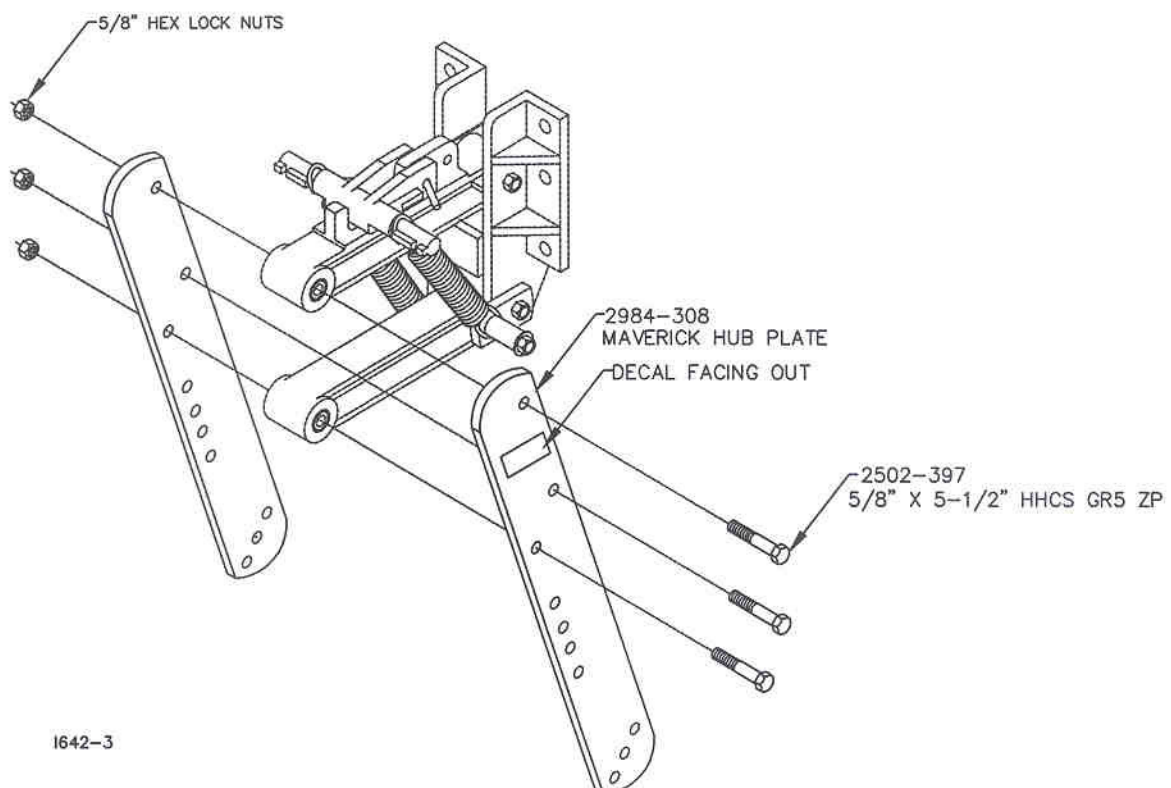

## ASSEMBLY INSTRUCTIONS

**STEP 5.** Mount the coulter blade to the hub assembly using 4) 2505-339 – 1/2" x 1 1/2" carriage bolts, 1/2" lock washers and 1/2" hex nuts. Torque the bolts to 90 ft. lbs.

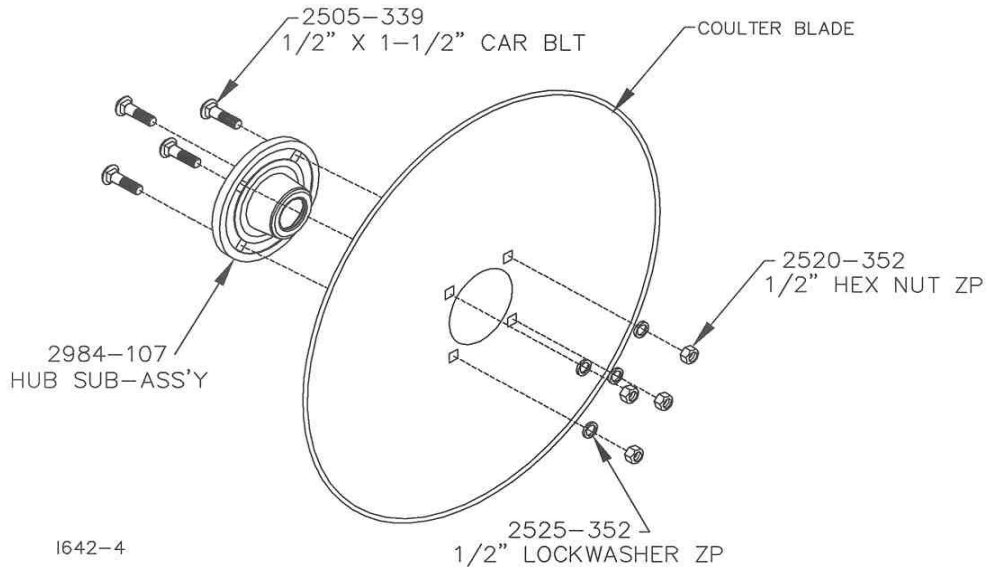

**STEP 6.** Mount the coulter blade/hub assembly to the lower end of the hub plate using 1) 2984-311 – 5/8" x 6" NF bolts, 2) 21/32" x 1 1/4" x 1/4" THK washers and 5/8" castle nut. Do not tighten 5/8" castle nut at this time. Do not install 1/8" x 1" cotter pin at this time.

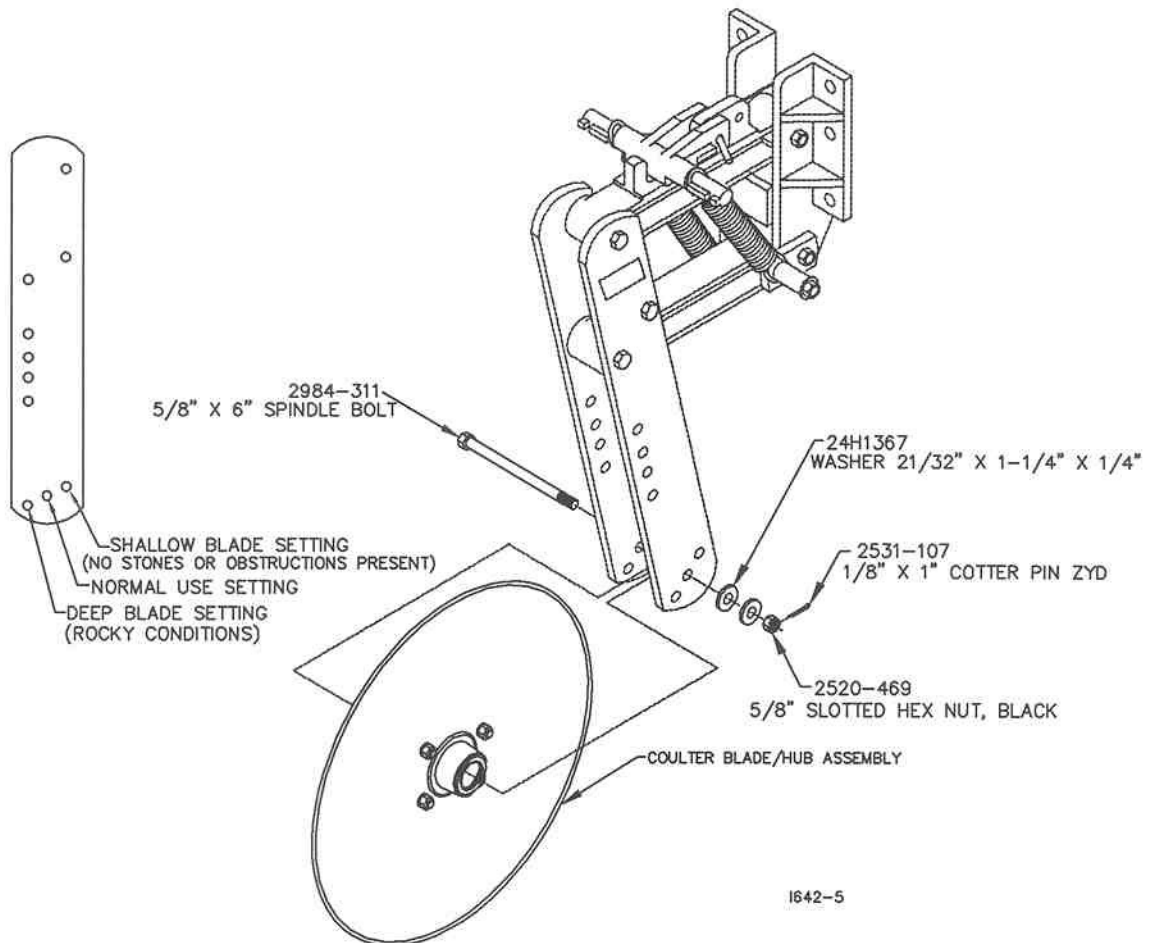

# ASSEMBLY INSTRUCTIONS

**STEP 7.** When the optional residue manager 2984-003 will be used, the 2984-312 stop plate should be assembled to the unit at this time. The 2) 21/32" x 1 1/4" x 1/4" flat washers are to be set aside for later use in the residue manager assembly. Do not fully tighten 5/8 castle nut, do not install 1/8" x 1" cotter pin at this time.

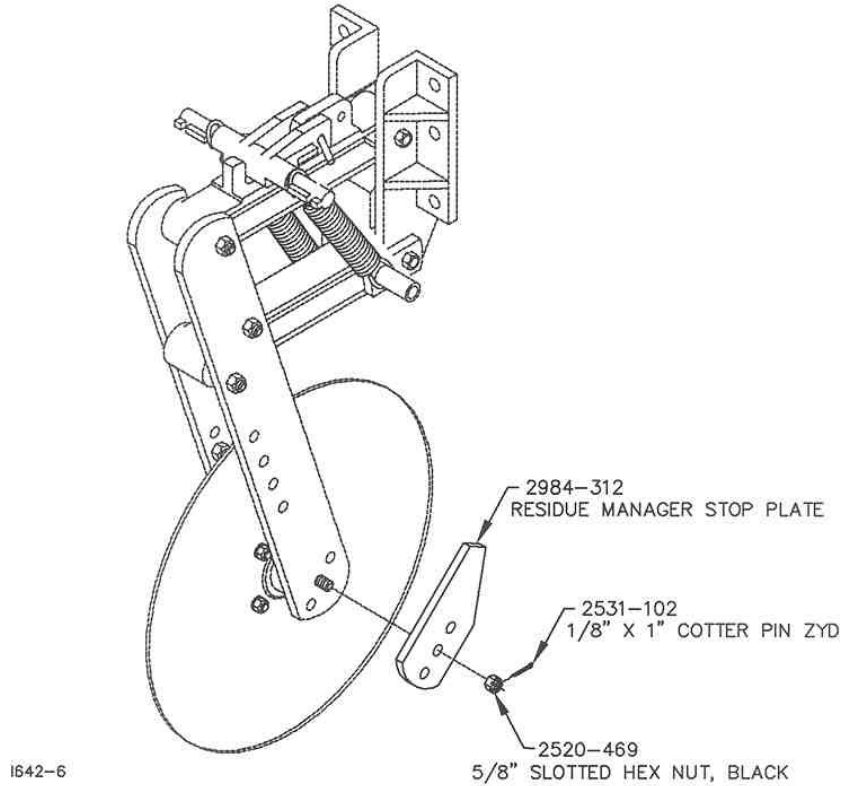

**STEP 8.** Attach the 2984-306 (RH KNIFE ARM) and 2984-307 (LH KNIFE ARM) to the hub plate using 4) 5/8" x 1 3/4" hex bolts and 5/8" lock nuts. Use the lower set of mounting holes in the hub plate.

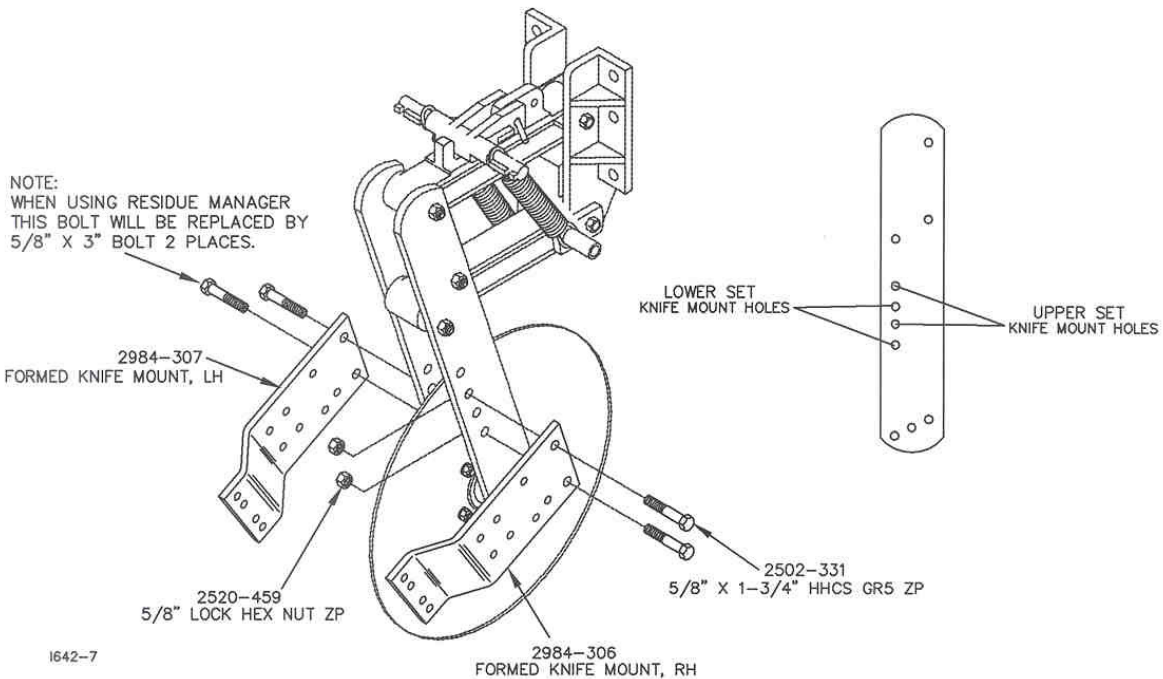

## ASSEMBLY INSTRUCTIONS

**STEP 9.** Install the knife using 2) 1/2" x 2" GR. 8 bolts and 1/2" lock nuts to the L.H. and R.H. knife mounts.

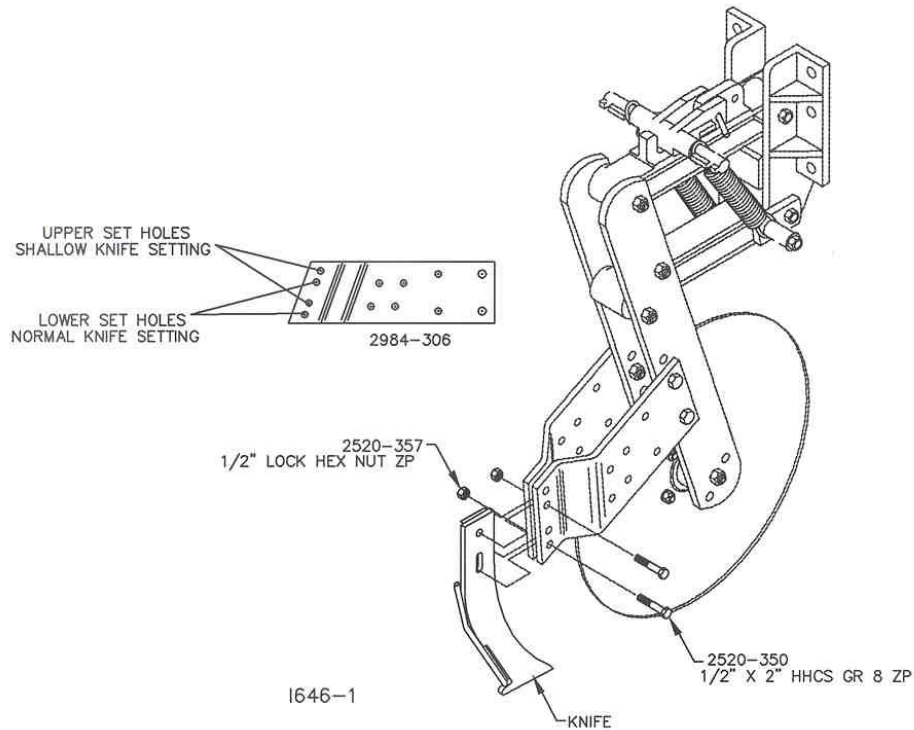

**STEP 10.** Tighten all bolts to recommended torques from table on page 8 of this manual unless the torque is specified.

Note: Do not over tighten the spindle bolt and castle nut. Torque the spindle bolt to 13-15 ft. lbs. or until the hub/blade assembly has a slight drag when turned by hand. Back off the nut one slot position on the castle nut to line up the cotter pin hole. Secure the nut with the 1/8" x 1" cotter pin provided.

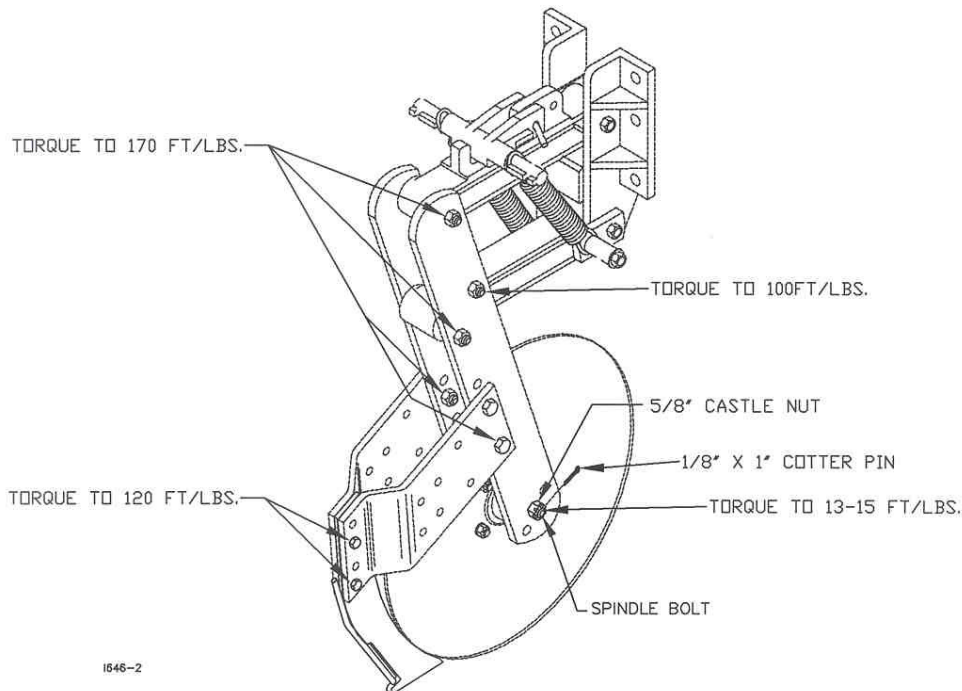

Recheck the torque on these bolts after 10 hours of operation and then every 50 hours after that. Do a routine inspection of the opener at this time for best performance and less down time.

# ASSEMBLY INSTRUCTIONS

## 2984-003 – RESIDUE MANAGER

**STEP 1.** Mount the 2984-313 quick adjust mount plate to the 2967-265 combo arm using 2) 1/2" x 1 1/2" bolts and lock nuts. Mount the 2967-175 quick adjust assembly to the 2984-313 mount plate using 1) 1/2" x 1 1/2" carriage bolt, 1/2" lock washers and 1/2" lock nuts.

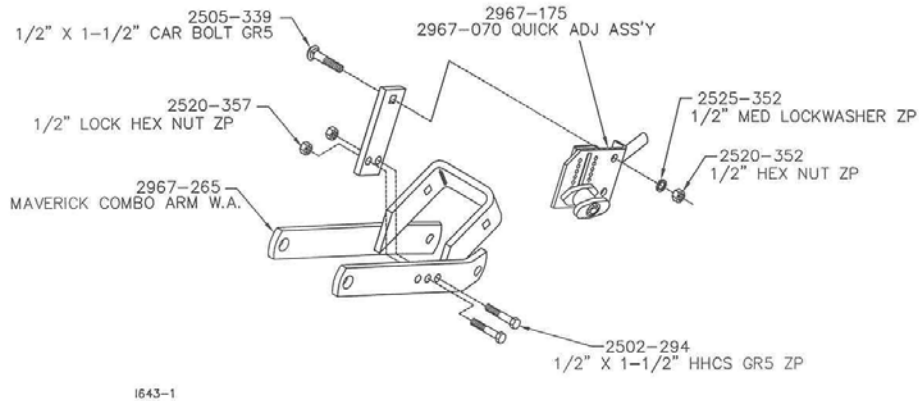

**STEP 2.** Assemble the residue manager spoke wheel (2967-404) to the 2965-352 hub cap and the 2965-128 hub/bearing assembly. Insert the 3" D-bolt through the hub/bearing assembly. Use 4) 5/16 x 1 1/2 carriage bolts and 5/16-18 lock nuts per wheel.

**NOTE:** Assemble one spoke wheel as a right hand wheel rotation and one spoke wheel as a left hand wheel rotation.

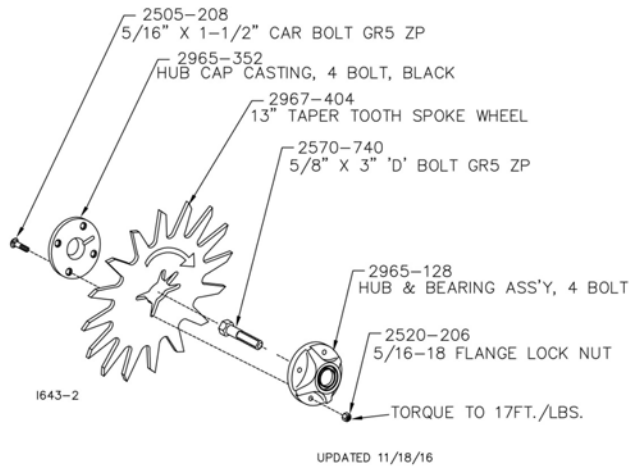
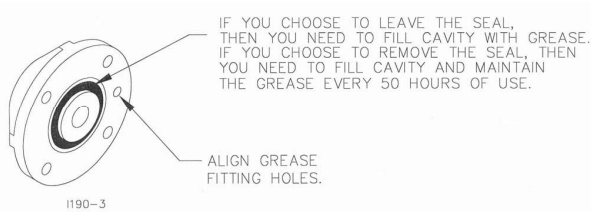

**NOTE:** Be certain to align the grease zerk with the slot in the wheel and the hub cap so that the grease can flow freely.

**STEP 3.** Assemble the 3/8" x 1 1/4" bolt to the 2984-314 lock strap using 3) 3/8 hex nuts. Torque to 40 ft./lbs.

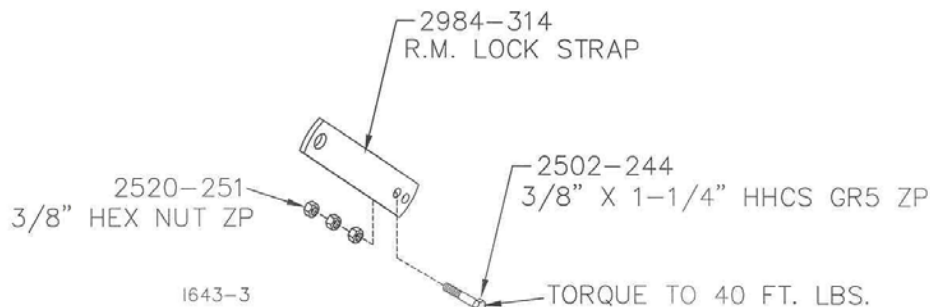

# ASSEMBLY INSTRUCTIONS

## 2984-003 – RESIDUE MANAGER

**STEP 4.** Assemble the 2984-312 stop plate onto the spindle bolt. The stop plate replaces the 1/4" thick flat washers. Install the castle nut, torque to 13-15 ft. lbs. and install the 1/8" x 1" cotter pin.

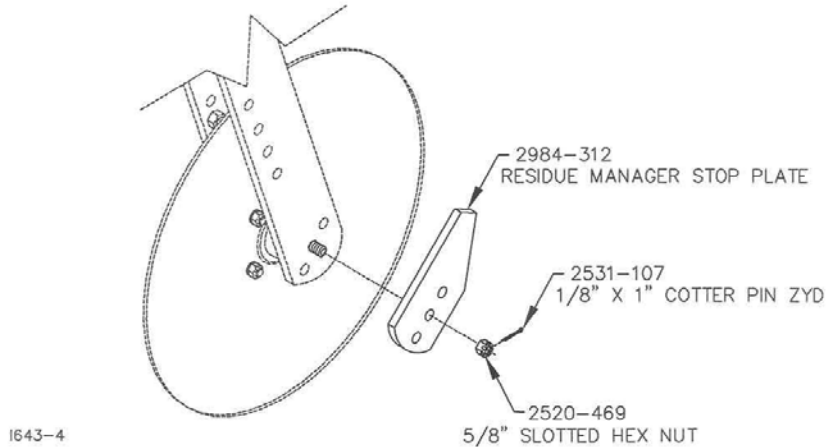

**STEP 5.** Attach the 2967-265 combo arm to the opener. On the right hand side, insert a 5/8" x 3" bolt through 5/8" flat washer, 9/16" bushing, combo arm, lock strap assembly and the lower hole of the R.H. knife mount and secure with 5/8" lock nut.

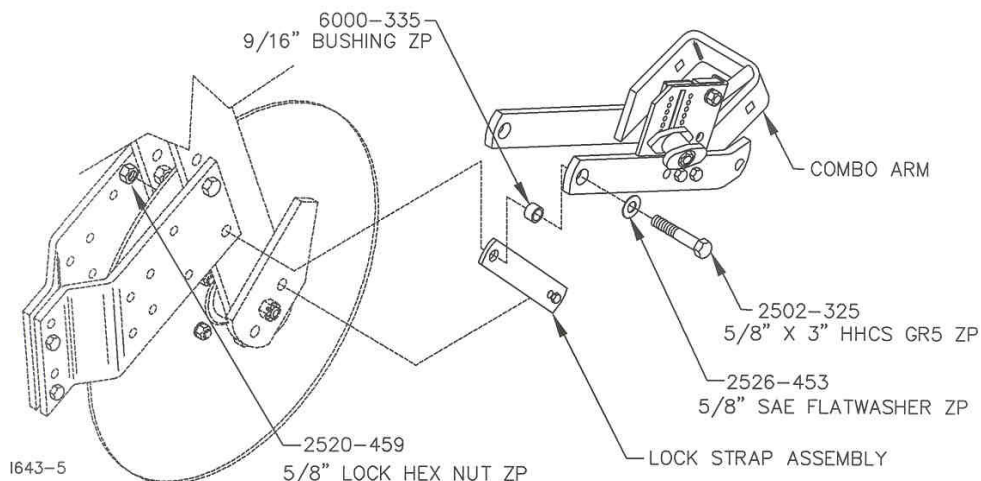

**NOTE:** The position of the 3/8" locator nuts of the lock strap assembly into the hole of the stop plate will depend on which hole the spindle bolt is in. SEE BELOW.

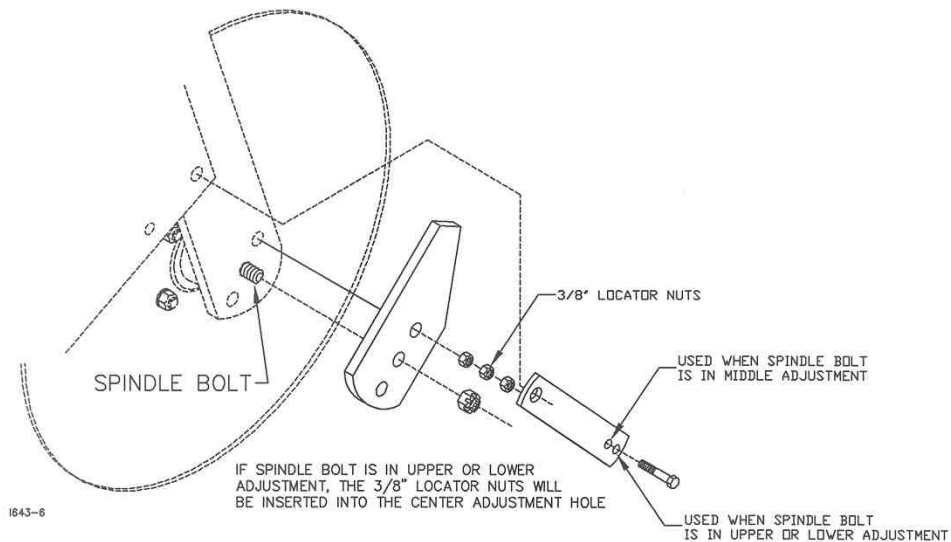

# ASSEMBLY INSTRUCTIONS

## 2984-003 – RESIDUE MANAGER

**STEP 6.** Attach the 2967-265 combo arm to the opener. On the left hand side, insert a 5/8" x 3" bolt through 5/8" flat washer, 9/16" bushing, combo arm, flat washer 21/32" ID x 1 1/4" OD x 1/4" thick and the lower hole of the L.H. knife mount and secure with 5/8" lock nut.

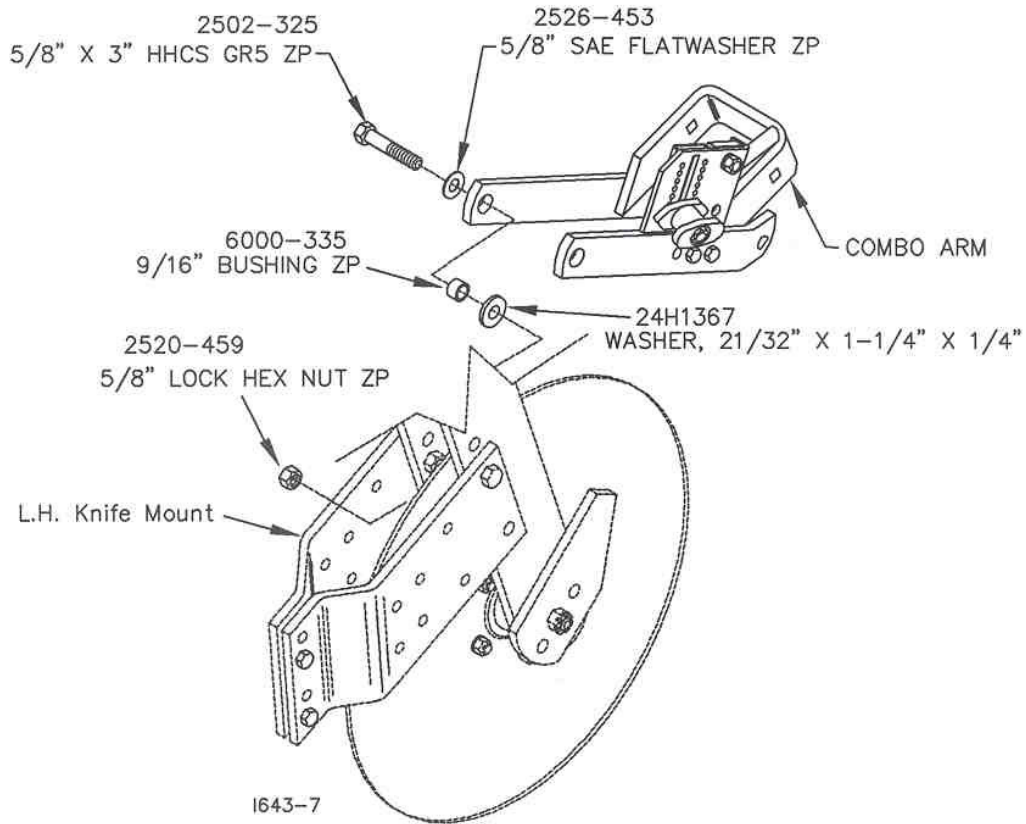

**STEP 7:** Attach the spoke wheel assemblies to the 2967-265 combo arm using 3" D-bolt, 5/8" lock washers and 5/8" hex nuts. Torque 150 ft.lbs.

**NOTE:** The direction of wheel rotation is important. The bevel should be leading.

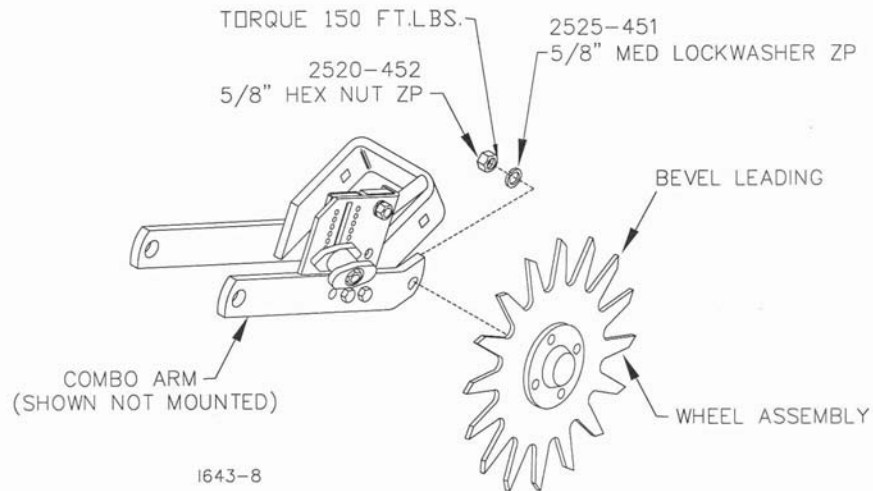

REVISED 02/09/09

# ASSEMBLY INSTRUCTIONS

## 2984-004 – DEPTH CONTROL KIT

**NOTE: A RESIDUE MANAGER KIT (2984-003) IS RECOMMENDED FOR USE WITH THE DEPTH CONTROL KIT**

**STEP 1.** Assemble the 2984-317 poly shoes to the 2984-204 R.H. SKID W.A. and 2984-203 L.H. SKID W.A. using the 4) 3/8" x 1" carriage bolts and 3/8" flanged lock nuts. DO NOT tighten at this time.

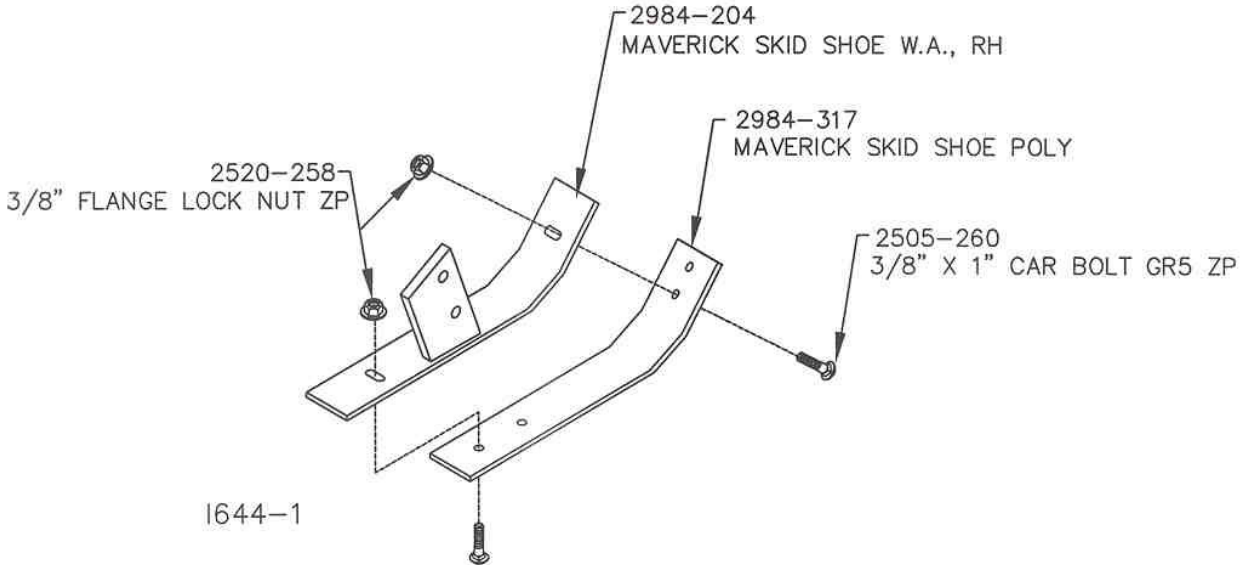

**STEP 2.** Attach the 2984-316 guide plates to the R.H. and L.H. knife mount arms using 4) 1/2" x 2" bolts, 9/16" spacer bushings and 1/2" lock nuts.

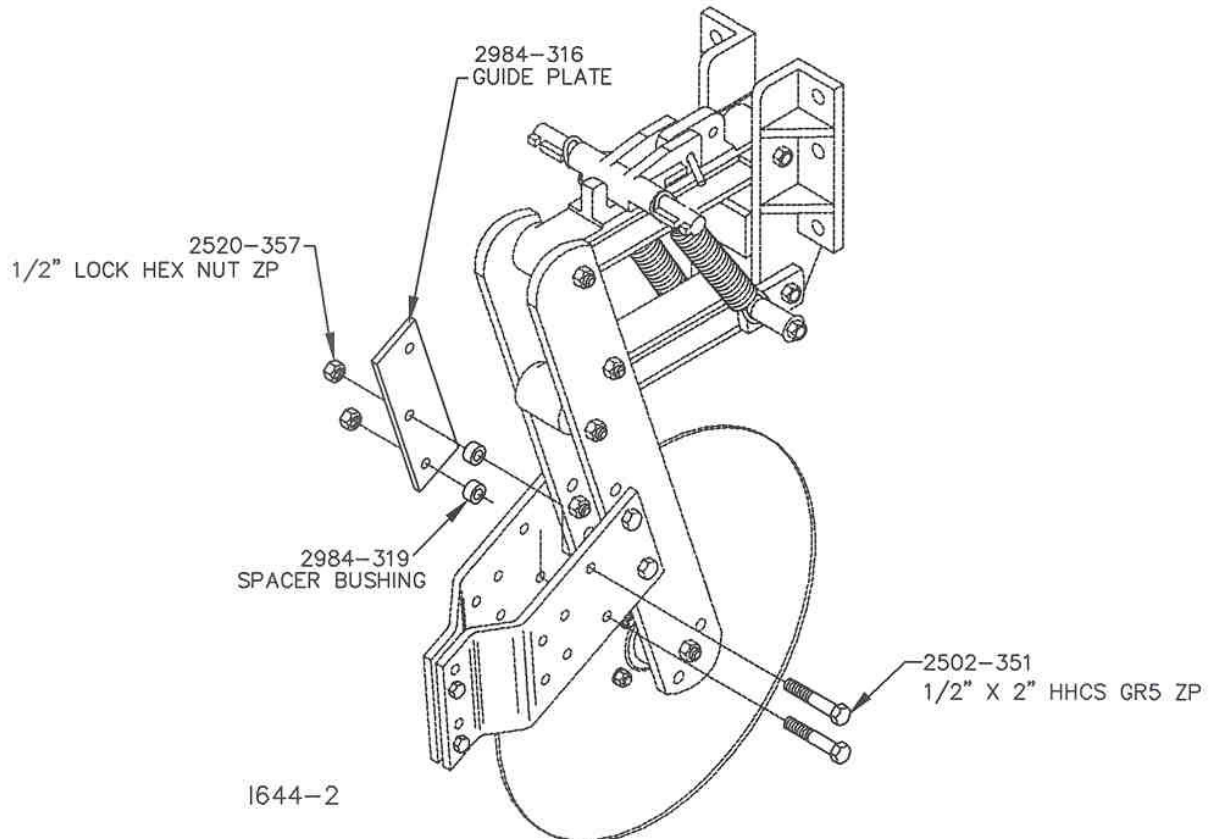

**NOTE: DO NOT TIGHTEN BOLTS AT THIS TIME**



# ASSEMBLY INSTRUCTIONS

## 2984-004 – DEPTH CONTROL KIT

**STEP 3.** Slide the 2984-315 adjustment links between the knife mount plate and the guide plates. Insert the 2984-320 adjustment pin and the 1/8" hairpin. Bolt the adjustment links together using 1) 1/2" x 5" bolt, 2984-318 handle bushing and 1/2" lock nut.

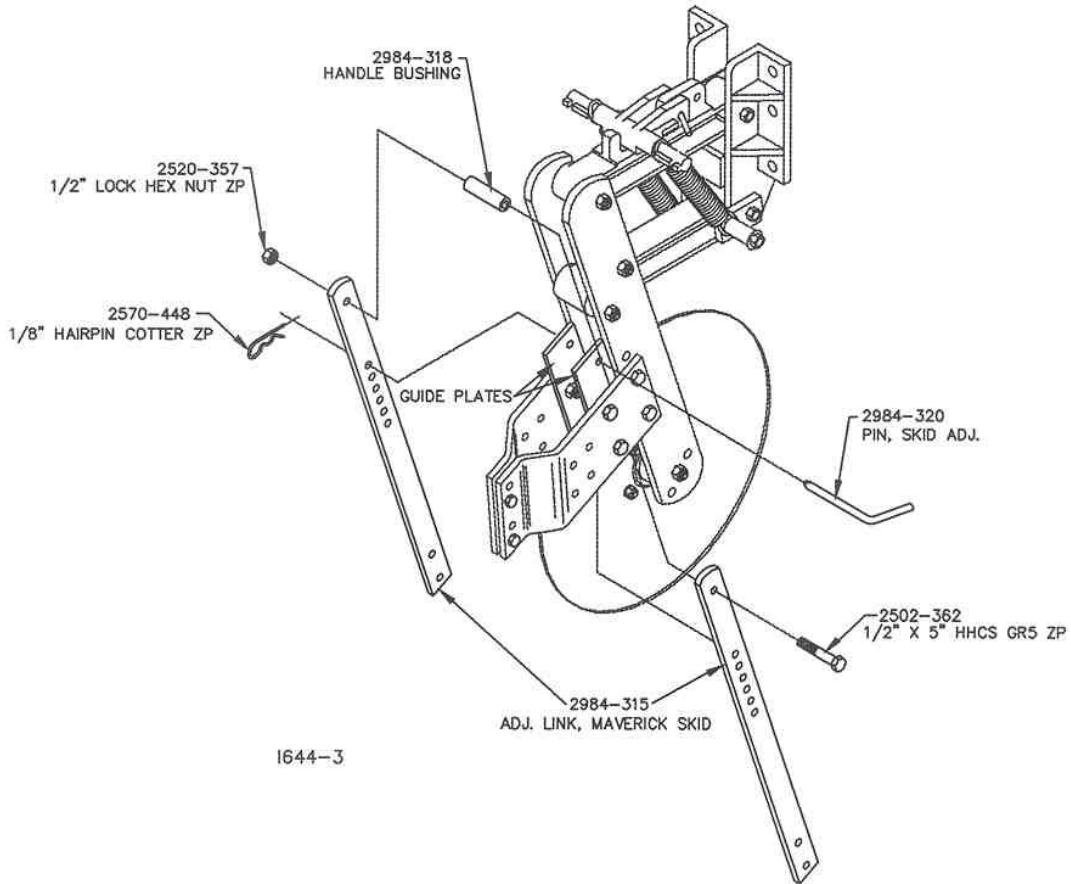

**STEP 4.** Attach the skid shoe assemblies to the adjustment links using 4) 1/2" x 1 1/2" bolts and lock nuts.

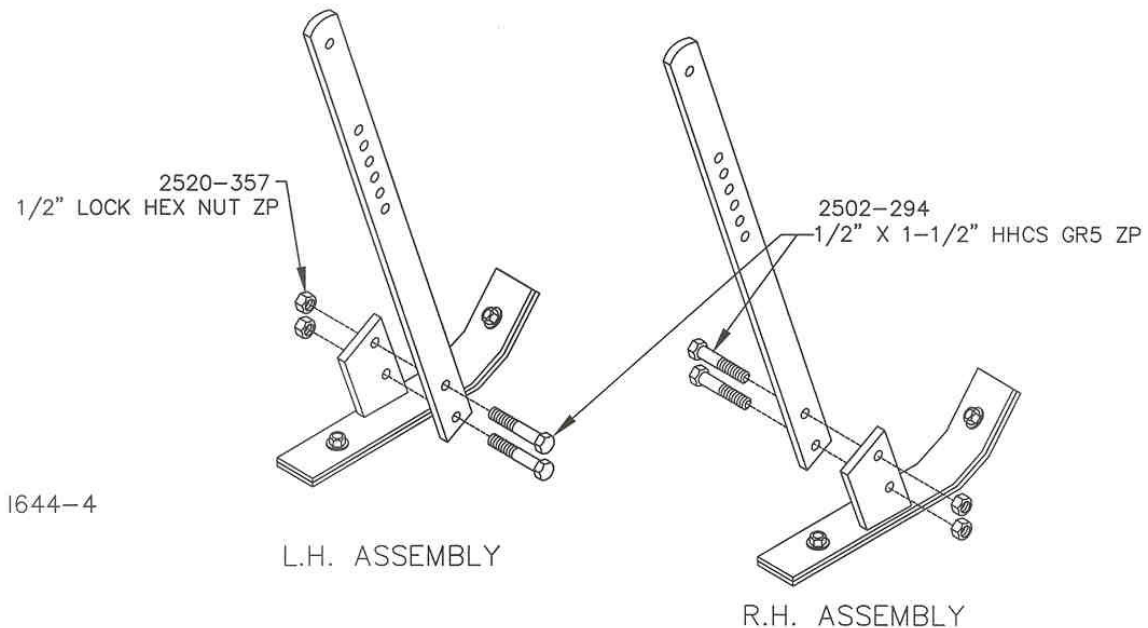

**NOTE:** Assemble with the head of the 1/2" bolt to the inside.

# ASSEMBLY INSTRUCTIONS

## 2984-004 – DEPTH CONTROL KIT

**STEP 5.** Tighten all 1/2" hardware to 80 ft. lbs. of torque. The adjustment pin must work in all the settings (holes). The skid shoes should be even front to back with each other. Adjust (slide) the poly skid side to side to make contact with the coultter blade. Tighten the 3/8" hardware to 40 ft. lbs. of torque.

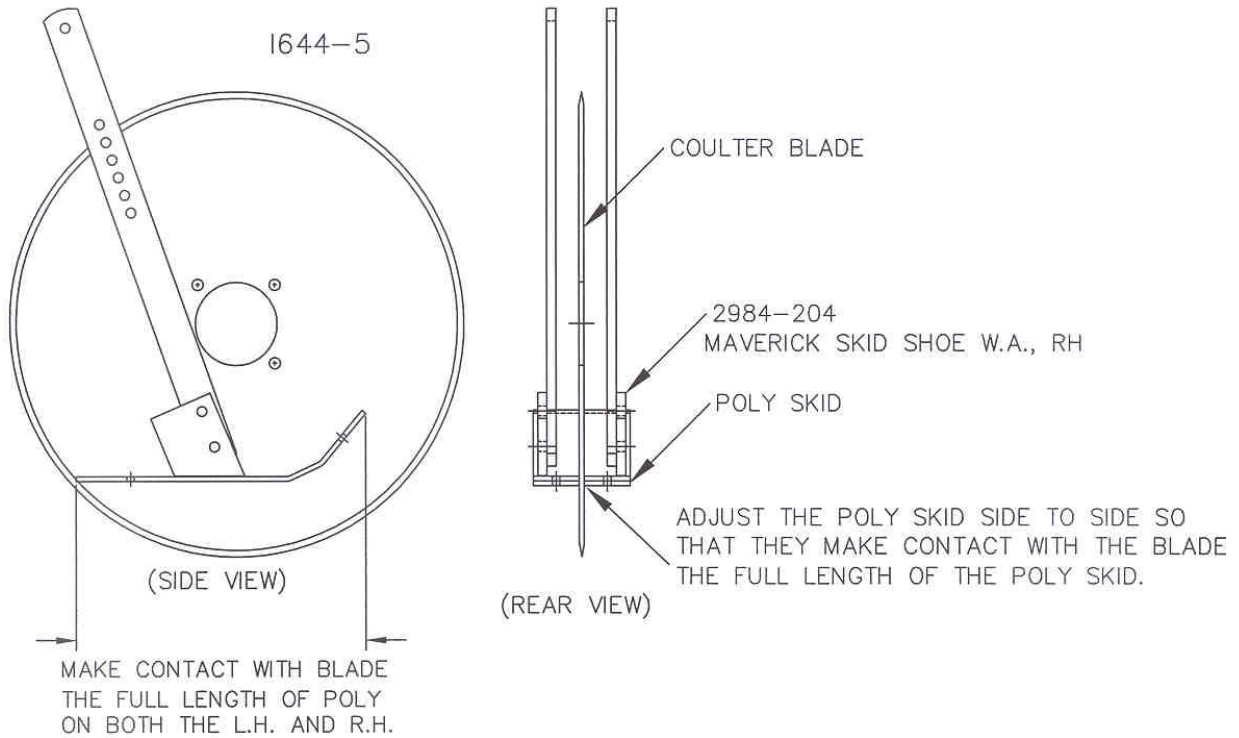

# ASSEMBLY INSTRUCTIONS

## 2984-005 – NOTCHED DISC SEALER KIT 2984-006 – 16" DISC SEALER KIT

**NOTE:** The disc sealer attachment can be mounted at various setting in relationship to the knife.  
I.E. (Front to back, height, side to side and angle of the blades)

**STEP 1.** Attach the 2) 2984-324 mount plates to the outside of the R.H. and L.H. knife mount plates using 4) 1/2" x 1 1/2" bolts and 1/2" lock nuts. Attach the 2984-323 mount bracket to the mount plates using 4) 1/2" x 1 1/4" bolts and 1/2" lock nuts.

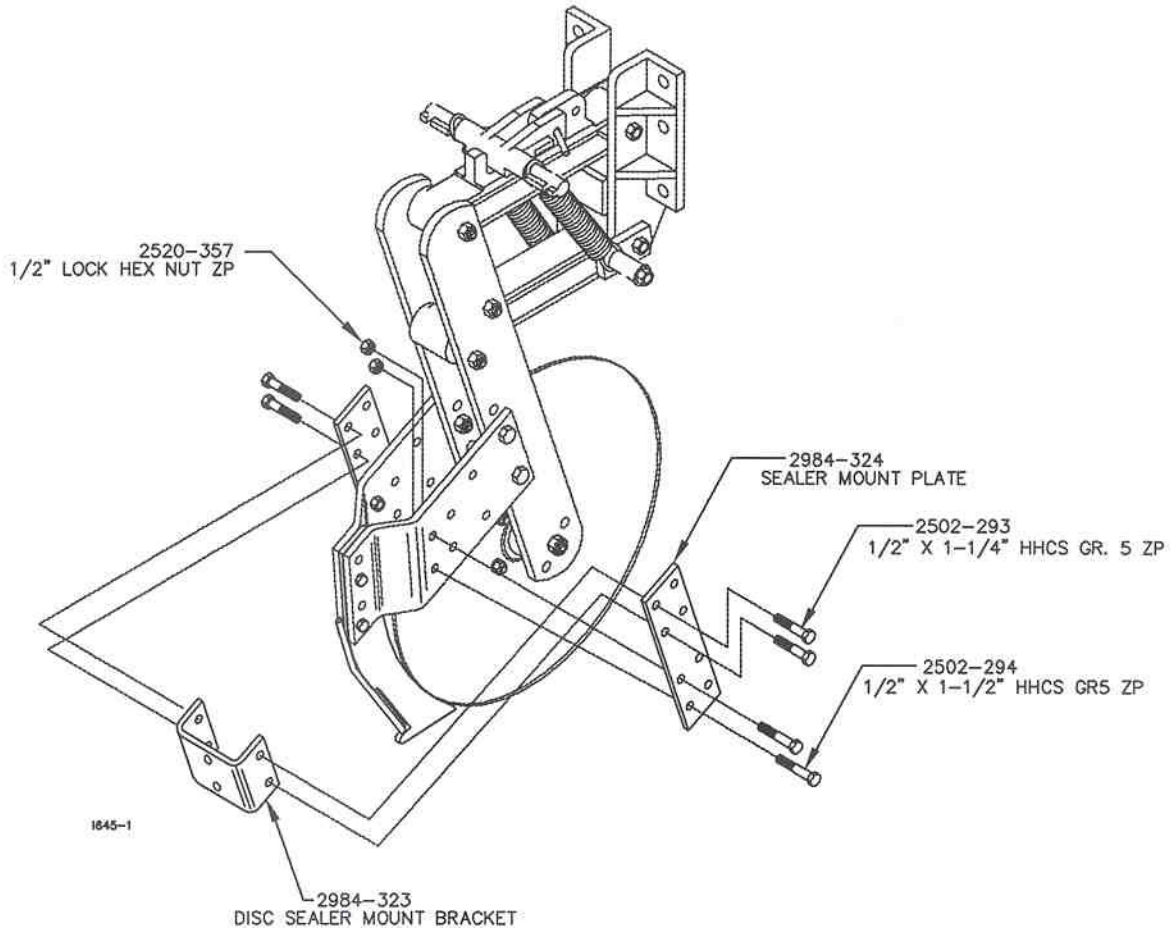

**STEP 2.** Attach the 2920-210 mounting bracket to the 2984-323 sealer mount bracket using 2) 1/2" x 1 1/2" bolts and 1/2" lock nuts.

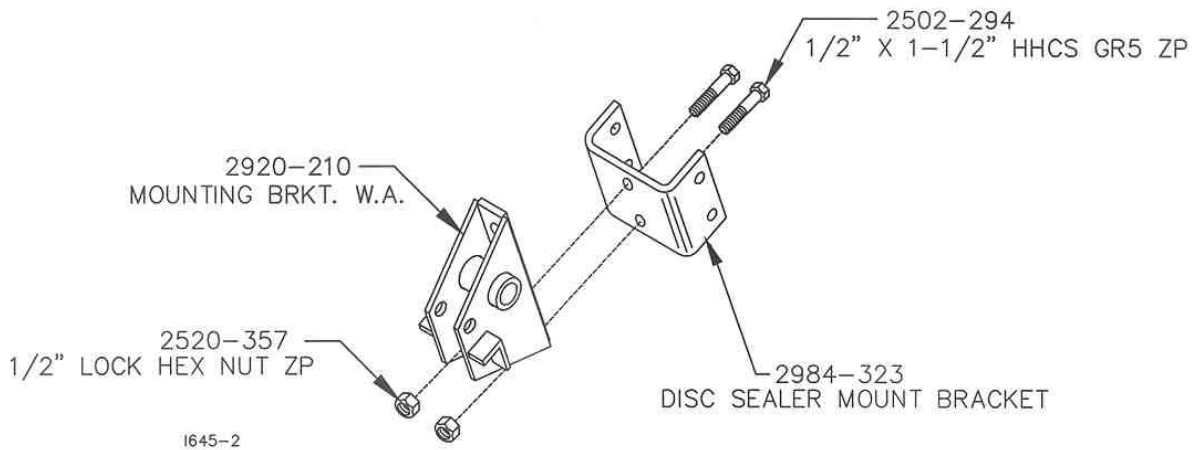

# ASSEMBLY INSTRUCTIONS

## 2984-005 – NOTCHED DISC SEALER KIT 2984-006 – 16" DISC SEALER KIT

**STEP 3.** Insert the 2920-342 pivot bushing (lubricate with anti-seize) into the pivot collar of the 2920-210 mounting bracket. Attach the 2920-324 push rod to the mounting bracket using 1) 5/8" x 2 1/2" bolt and 5/8" jam lock nut.

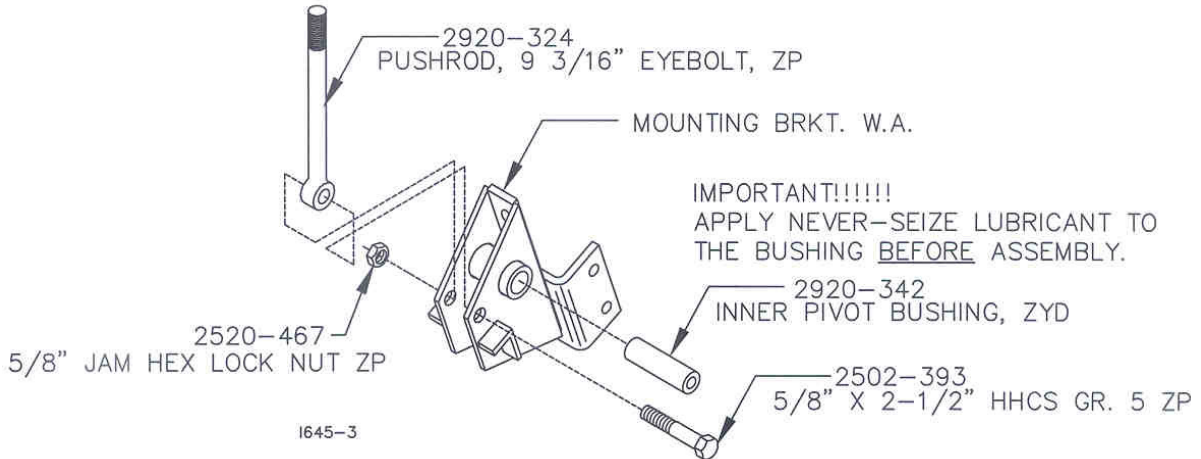

**STEP 4.** Attach the 2920-209 disc sealer bracket to the 2920-210 mounting bracket using 1) 1/2" x 4 1/2" bolt and 1/2" lock nut. Attach the 2) 2920-329 L-brackets to the 2920-209 arm using 4) 1/2" x 2" carriage bolts, 1/2" lock washers and 1/2" hex nuts. Next, assemble the 2920-330 pushrod bracket, 2920-350 spring, 2975-302 spring bushing and 3/4" lock nut on the pushrod.

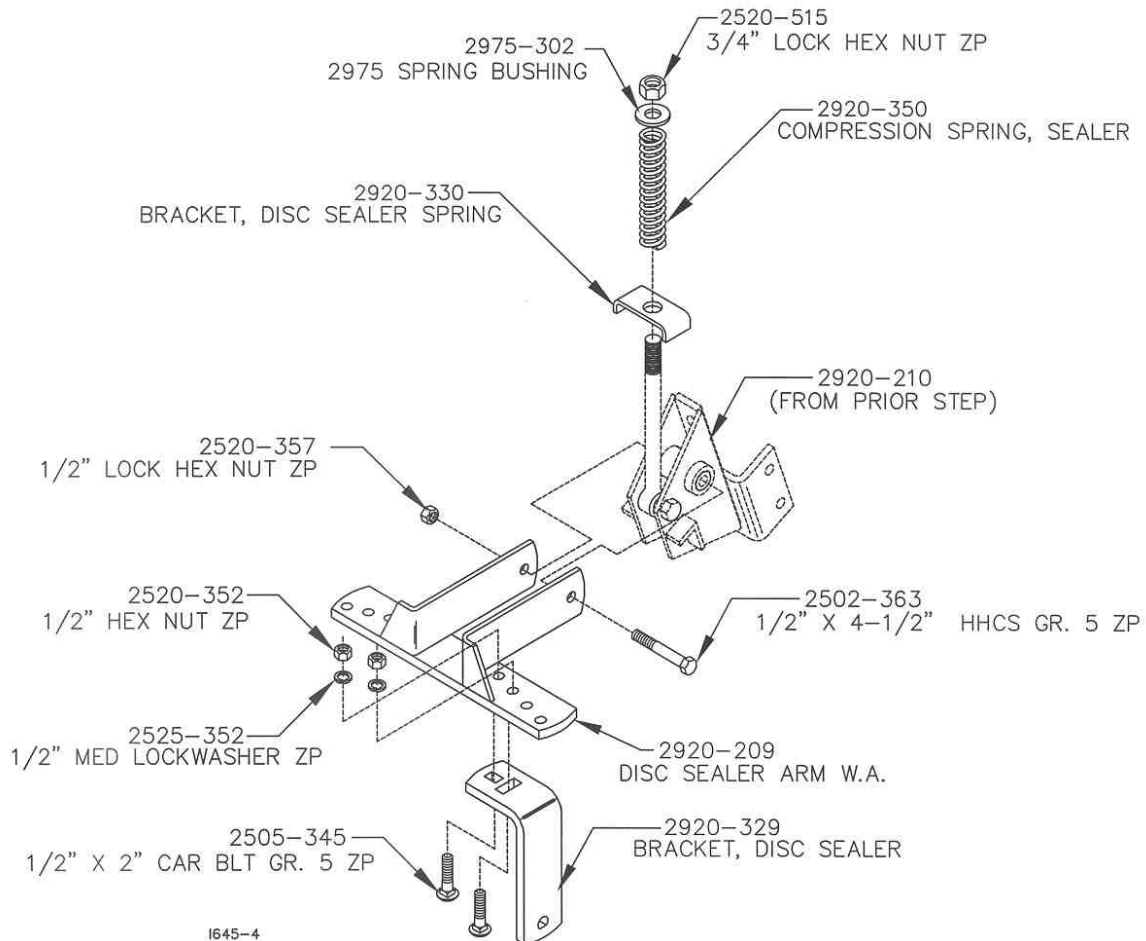

# ASSEMBLY INSTRUCTIONS

2984-005 – NOTCHED DISC SEALER KIT  
2984-006 – 16" DISC SEALER KIT

**STEP 5.** Assemble the blades to the 2965-hub cap, 2965-128 hub and bearing assembly, 5/8" x 4" D-bolt. Bolt the blade and hub assembly together using 4) 5/16" x 1 1/4" carriage bolts and 5/16" lock nuts.

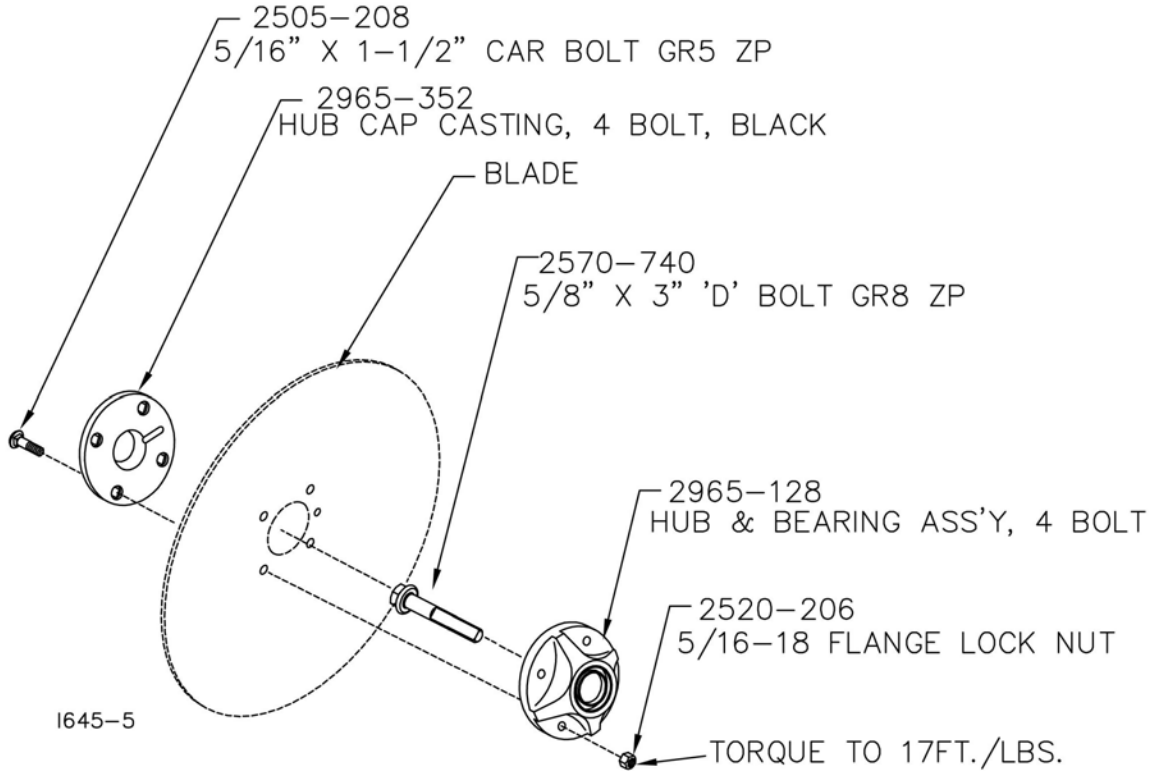

UPDATED 11/18/16

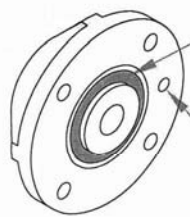

1645-6

**NOTE:** During assembly be sure to align the grease fitting hole in all the components to assure proper lubrication of the bearing. Use a general purpose grease before use of the openers.

# ASSEMBLY INSTRUCTIONS

2984-005 – NOTCHED DISC SEALER KIT

2984-006 – 16" DISC SEALER KIT

**STEP 6.** Attach the blade/hub assembly to the 2920-329 L-bracket using the D-bolt through 1)  $\frac{3}{4}$ " spacer,  $\frac{5}{8}$ " lock washer and  $\frac{5}{8}$ " hex nut. Torque 150 ft.lbs.

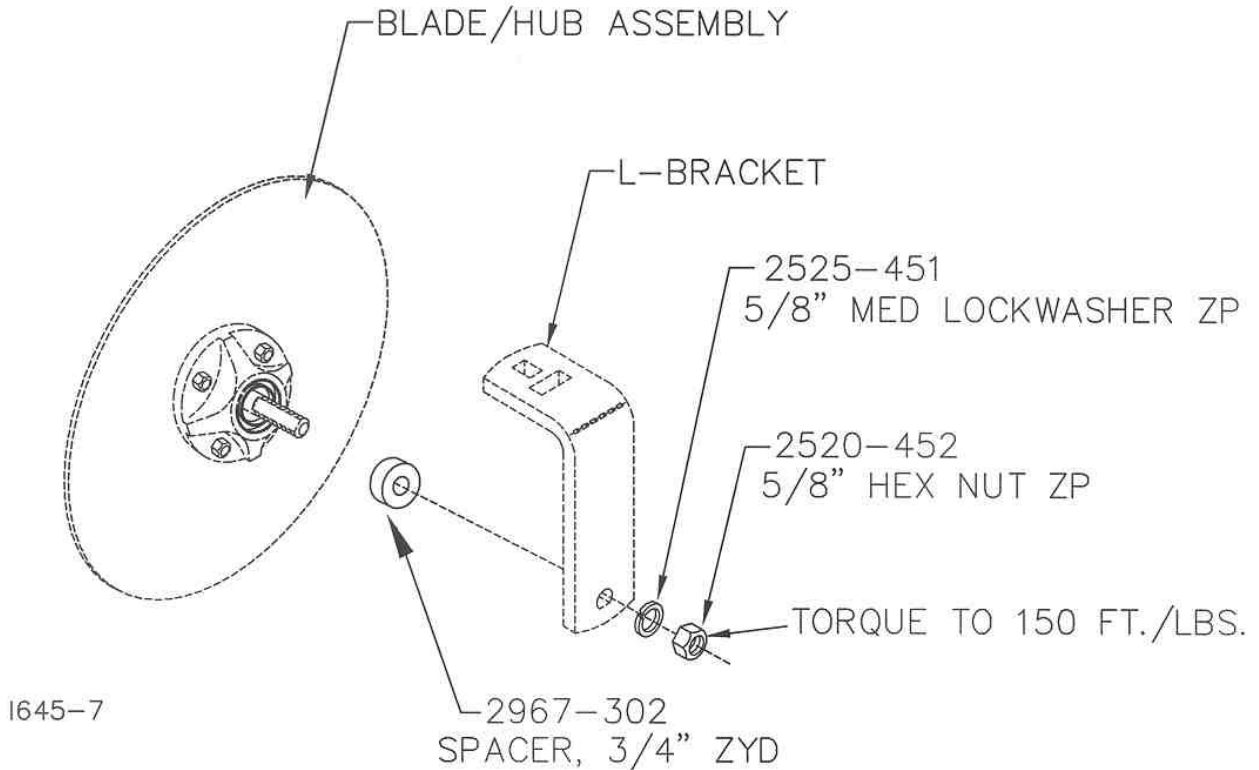

**STEP 7.** Adjust the angle of the disc blades so that the blades are approximately 8" apart and 4" from the center of the knife.

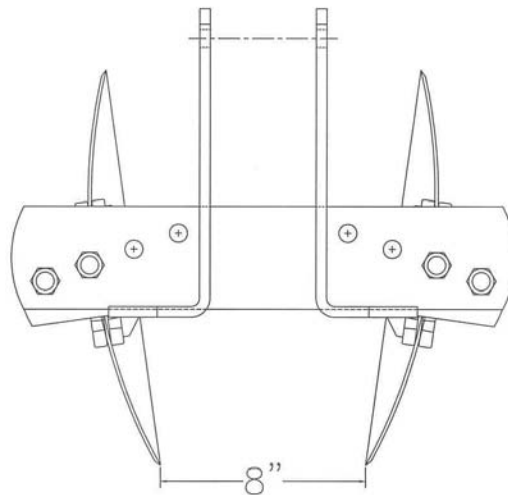

S196

**STEP 8.** Tighten all of the hardware to the recommended torque unless otherwise stated.

# ASSEMBLY INSTRUCTIONS

## 2984-008 – V-CLOSE WHEEL ASSEMBLY

**STEP 1.** Assemble the 6000-002 close wheel kit as shown below in illustration.

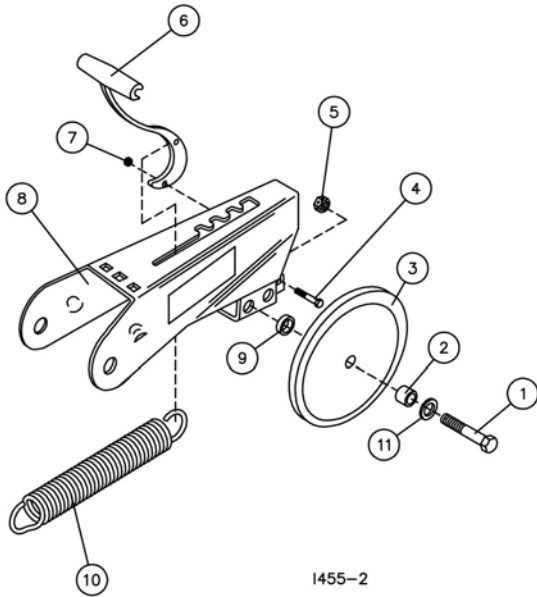

### 6000-002 CLOSE WHEEL KIT ASSEMBLY

KEY	QTY	PART NO.	DESCRIPTION
1	2	2502-336	5/8-11 x 4 HHCS GR. 5 ZP
2	2	6000-335	9/16" BUSHING
3	2	2570-751	1 X 12 NYL CLOSING WHEEL 40MM SMCR
	2	2570-069	BEARING, 40 MM
4	1	2502-206	5/16-18 X 1 1/2 HHCS GR. 5 ZP
5	2	2520-459	5/8-11 LOCK HEX NUT ZP
6	1	6000-524	CLOSE WHEEL LEVER
7	1	2520-205	5/16-18 LOCK HEX NUT ZP
8	1	6000-247	CLOSE WHEEL ARM W.A.
9	2	6000-336	BUSHING PIVOT
10	1	6000-525	CLOSE WHEEL SPRING (PAINTED)
11	2	2526-453	5/8 SAE FLATWASHER

UPDATED 11/21/16

**STEP 2.** Insert the spring hook through the small hole of the 2984-325 spring anchor. Attach the 2570-710 cable clamp onto the outer end of the spring hook and tighten nuts to 10 ft. lbs.

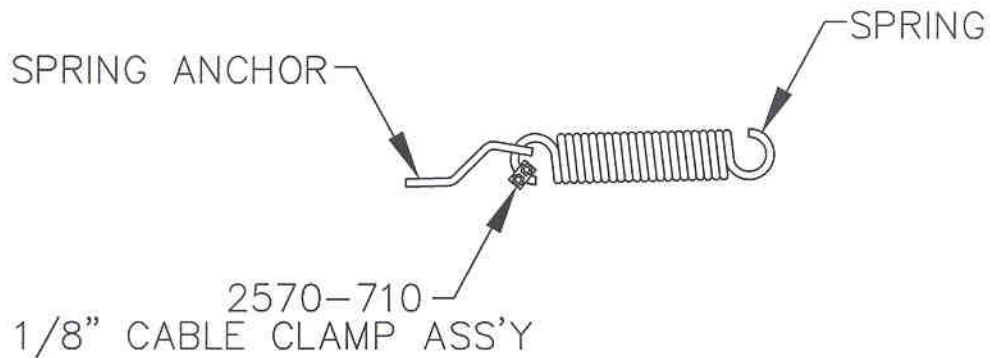

1646-3

# ASSEMBLY INSTRUCTIONS

### 2984-008 – V-CLOSE WHEEL ASSEMBLY

**STEP 3.** Mount the 2) 2984-324 mount plates to the outside of the R.H. and L.H. knife plates using 4) 1/2" x 1 1/2" bolts and 1/2" lock nuts.

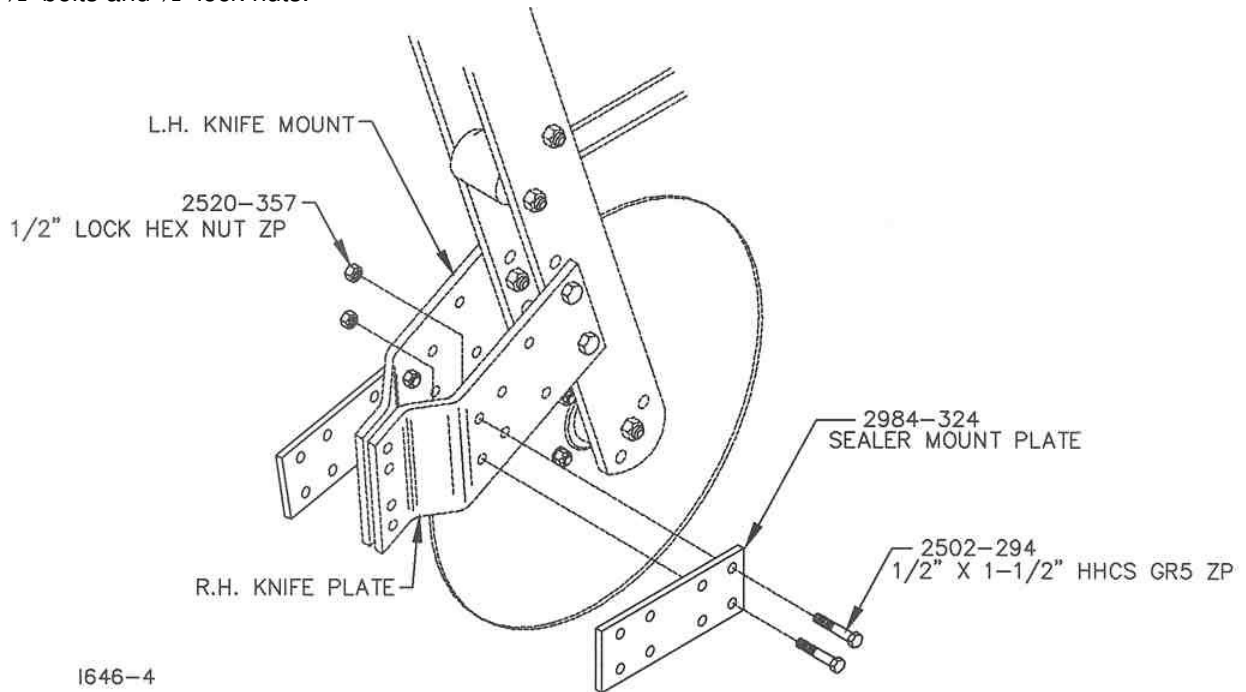

**STEP 4.** Attach the 6000-002 v-close wheel assembly to the mount plates using 2) 1/2" x 1 3/4" bolts, 2) eccentric bushings, 2) 1/2" flat washers and 2) 1/2" lock nuts.

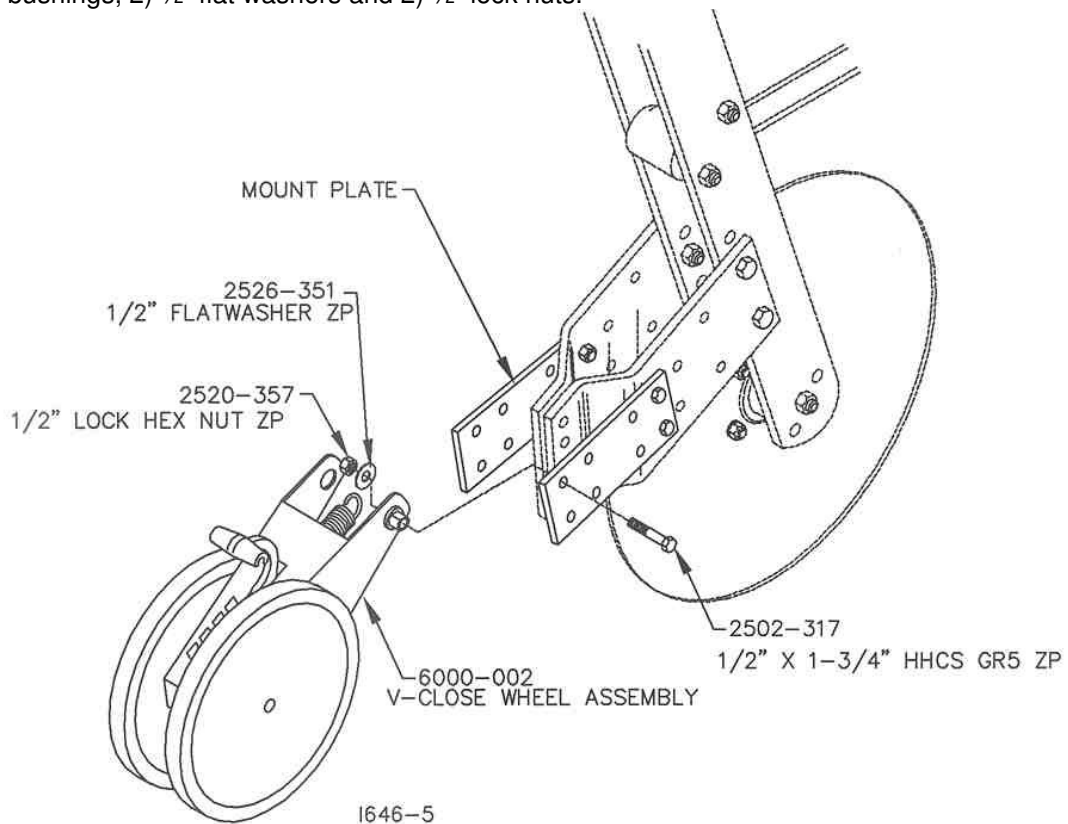

## ASSEMBLY INSTRUCTIONS



## 2984-008 – V-CLOSE WHEEL ASSEMBLY

**STEP 5.** Attach the 2502-346 – 1/2" x 2" full thread bolt to the 2984-324 mount plate through the lower rear hole. This bolt is used as a down stop for the v-close wheel assembly. adjust the bolt side to side so the bolt will stop the down travel of the v-close wheel assembly.

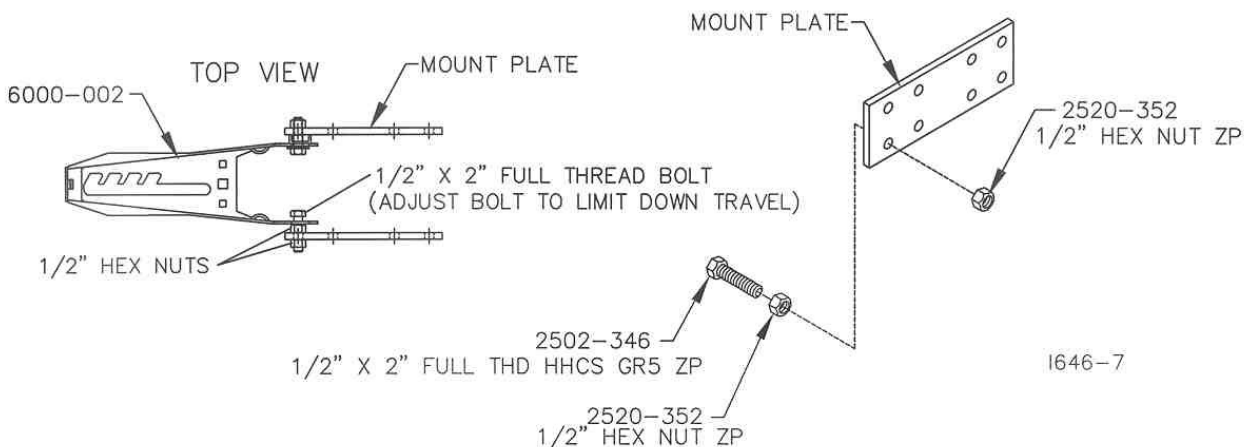

**STEP 6.** Attach the 2984-325 spring anchor (attached to the spring) to the knife mount replacing the bottom bolt of the knife using 1) 1/2" x 2 1/2" GR 8 ZYD bolt and reuse the 1/2" lock nut.

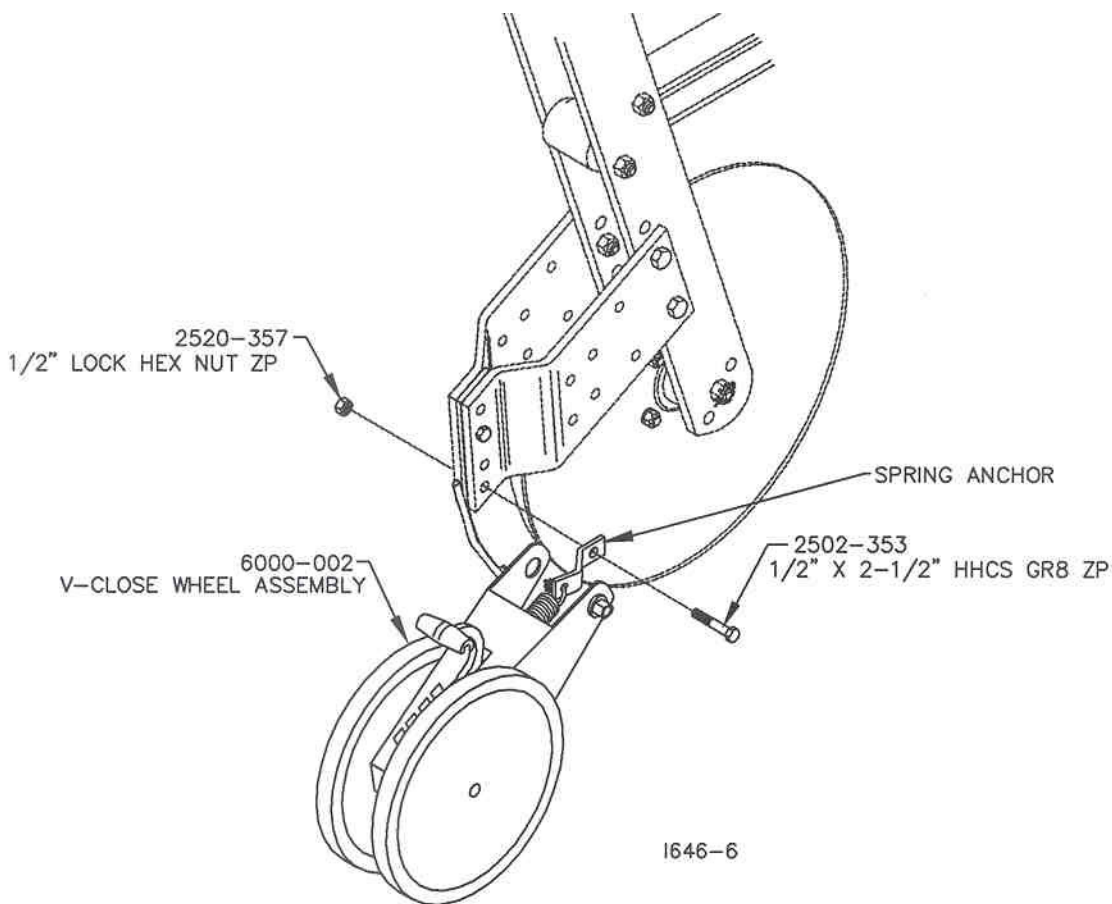

## ASSEMBLY INSTRUCTIONS

**STEP 7.** An eccentric bushing allows centering of the close wheels on the row. To properly apply pressure on both sides of the slot when closing the trench. When adjusted properly, the closing wheels are centered on the trench. To adjust, loosen the ½" x 6 ½" hex bolt that attaches the closing wheel assembly to the wheel mount bracket. Rotate eccentric bushing with wrench to align closing wheel assembly with center of trench. Tighten bolt that attaches closing wheel arm to wheel mount bracket.

(CLOSING WHEEL ASSEMBLY SHOWN NOT ASSEMBLED TO COULTER FOR VISUAL CLARITY)

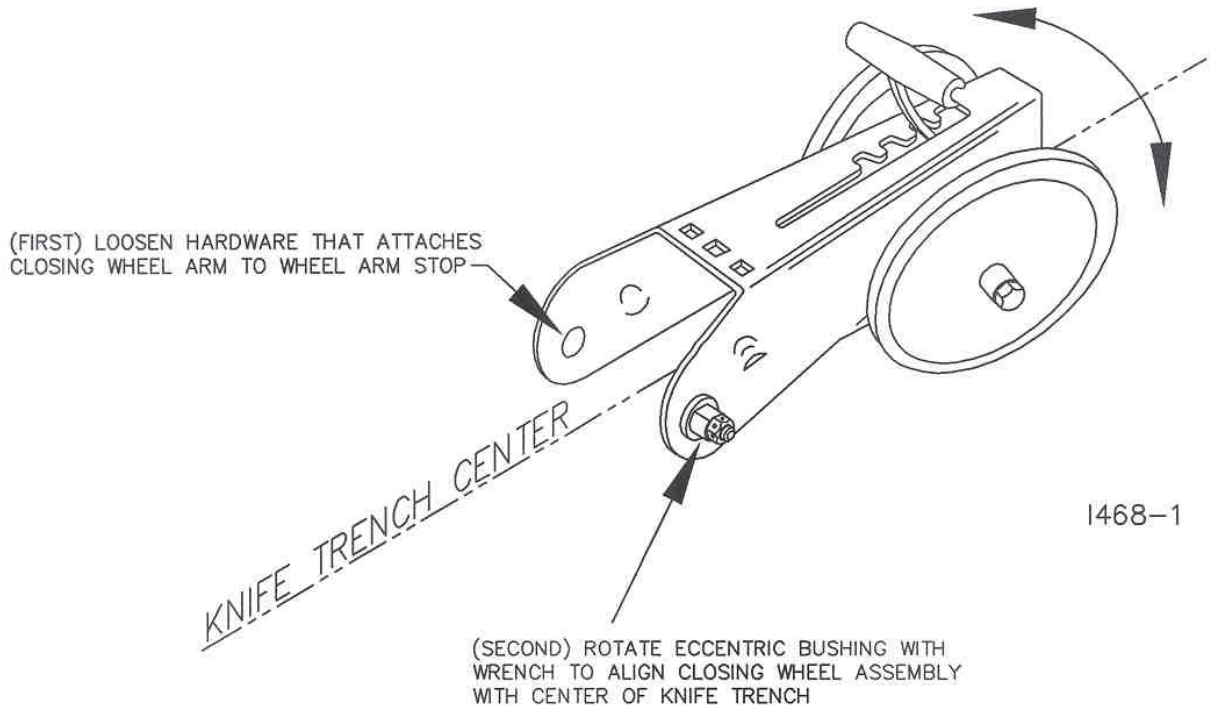

## ASSEMBLY INSTRUCTIONS

2984-009 – SEALING WHEEL KIT

**STEP 1.** Install 2) 2984-324 mount plates onto the R.H. and L.H. knife mounts using 4) 1/2" x 1 1/2" bolts and 1/2" lock nuts.

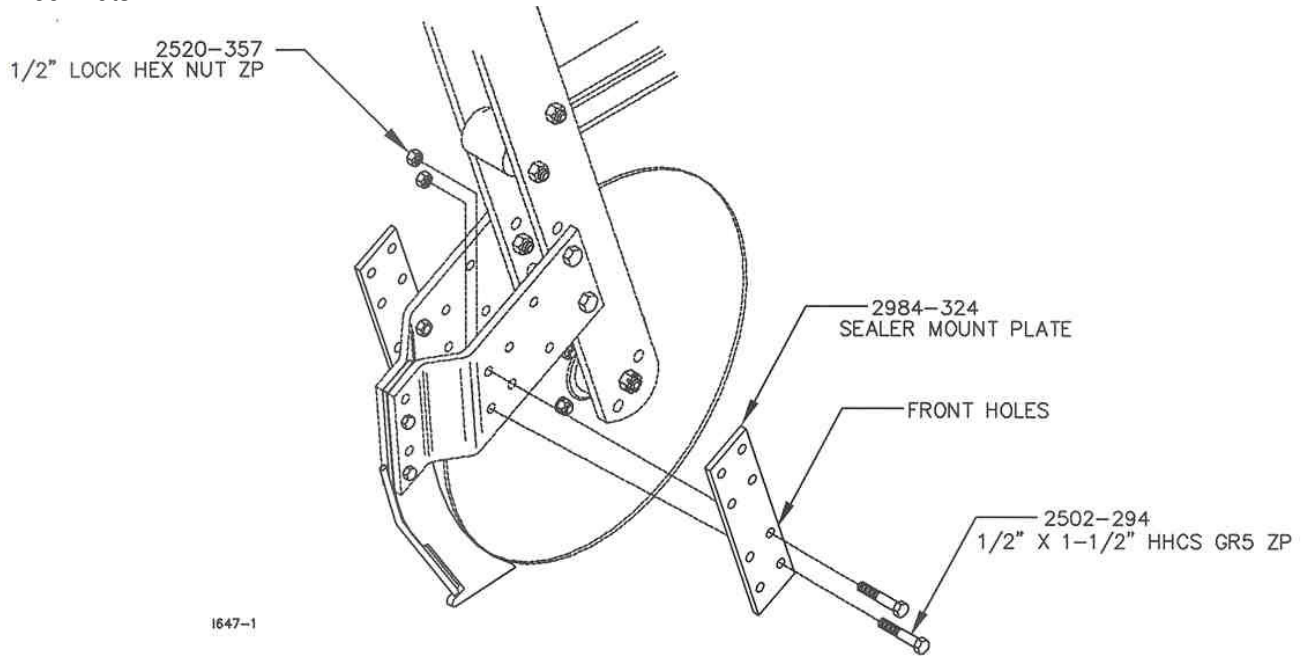

**NOTE:** Use the lower front holes of the mount plate and the rear holes of the knife mounts.

**STEP 2.** Attach the 2984-323 sealer mount bracket to the mount plate on the rear set of holes using 4) 1/2" x 1 1/4" bolts and 1/2" lock nuts.

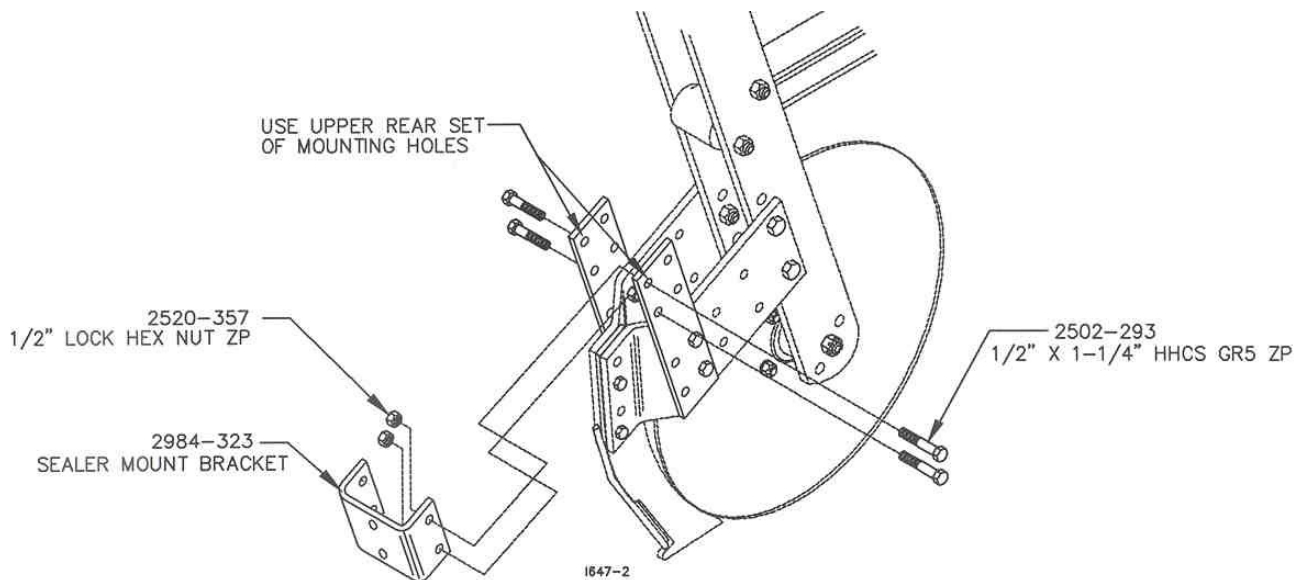

## ASSEMBLY INSTRUCTIONS

2984-009 – SEALING WHEEL KIT

**STEP 3.** Attach 2920-210 mounting bracket to the 2984-323 sealer mount bracket using 2) 1/2" x 1 1/4" bolts and 1/2" lock nuts. Attach the 2920-324 pushrod to the 2920-210 mounting bracket using 1) 5/8" x 2 1/2" bolt and 5/8" jam lock nut. Insert 2920-342 pivot bushing into the 2920-210 mounting bracket – lubricate with anti-seize.

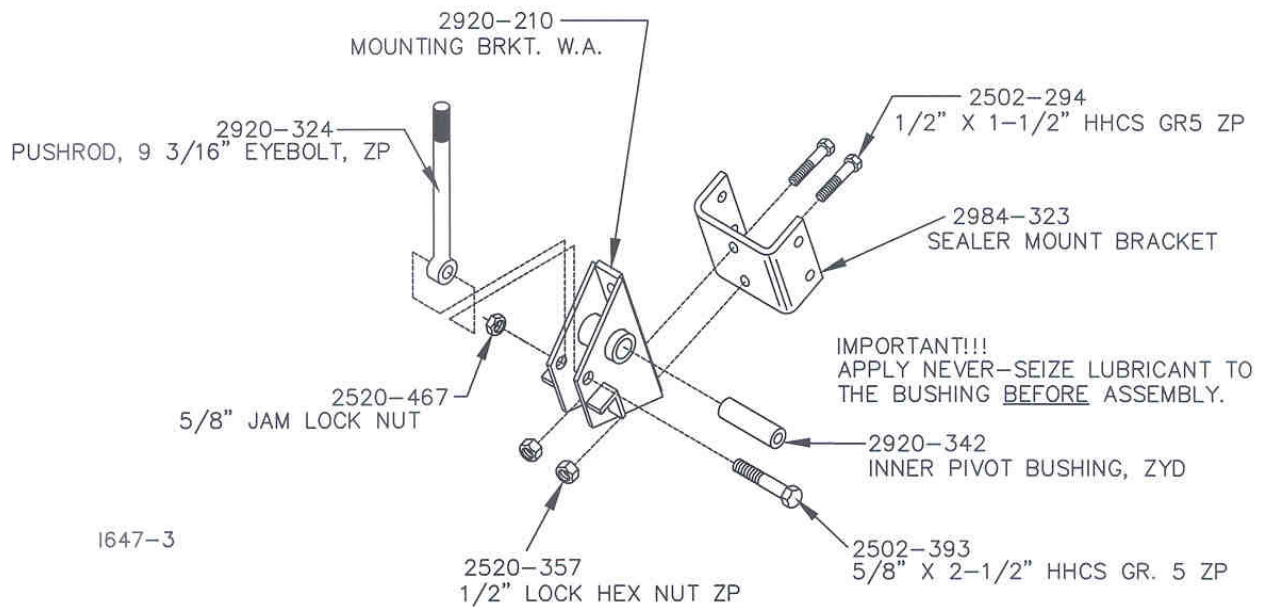

**STEP 4.** Attach the 2984-202 sealer wheel arm to the mounting bracket using 1) 1/2" x 4 1/2" bolt and 1/2" lock nut. Next, assemble the 2920-330 pushrod bracket, 2920-350 spring, 2975-302 spring bushing and 3/4" lock nut onto the pushrod.

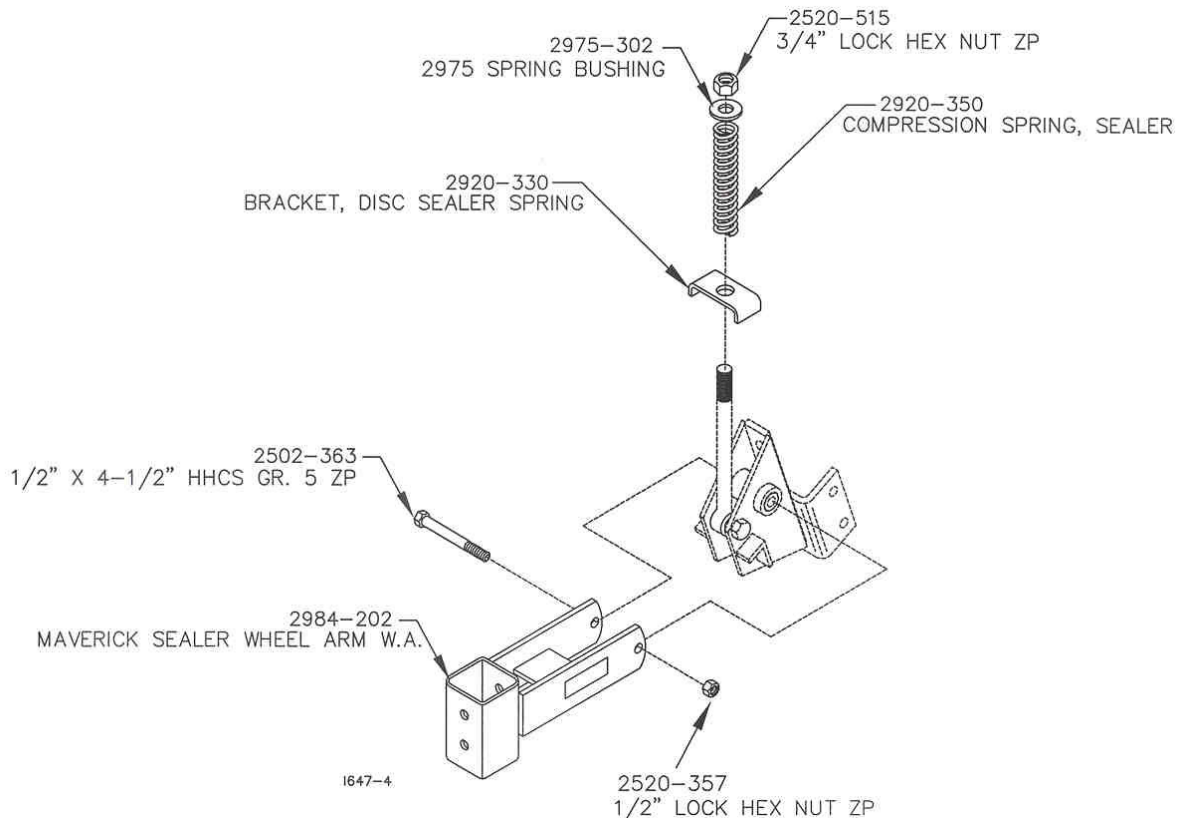

## ASSEMBLY INSTRUCTIONS

### 2984-009 – SEALING WHEEL KIT

**STEP 5.** Attach the 2) 2570-750 4.5" X 16" wheels to the 2925-206 adjustment stem using 2) 5/8" x 4" bolts, 3/4" spacers, 5/8" lock washers and 5/8" hex nuts.

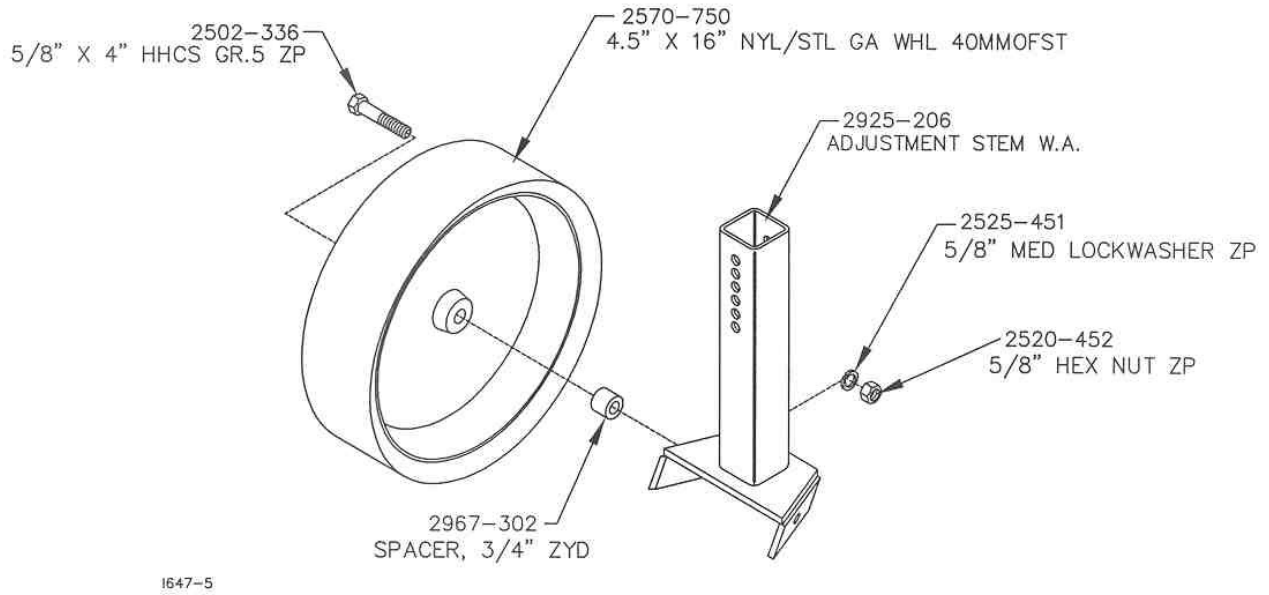

**STEP 6.** Insert the wheel/stem assembly into the wheel arm and hold it in position with the 2925-315 pin and 1/8" hairpin cotter.

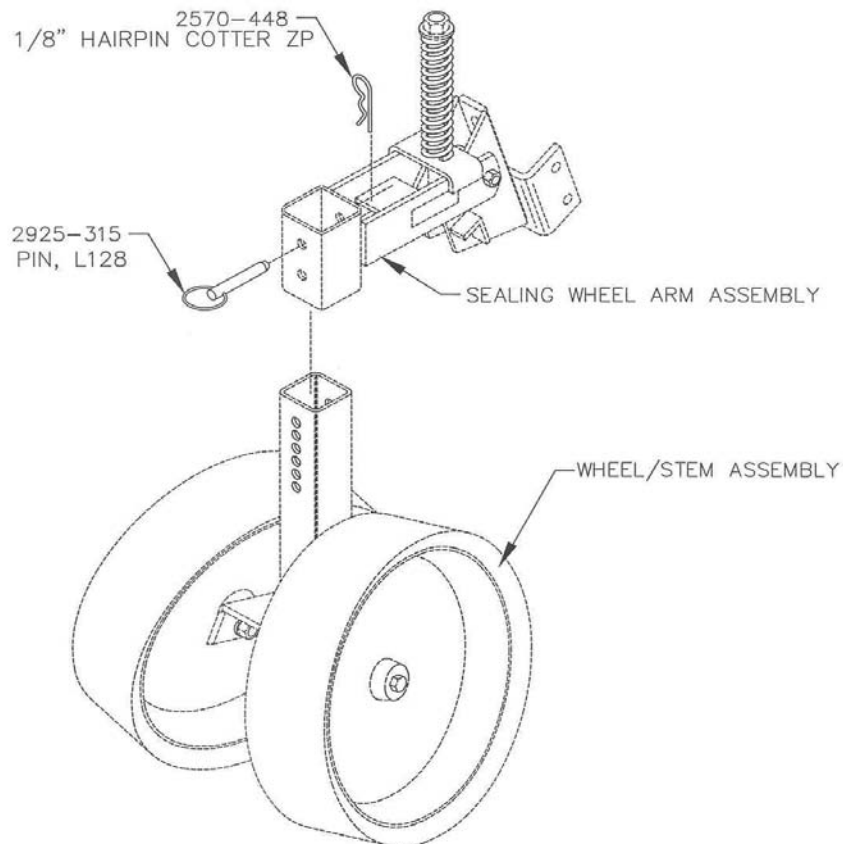

**STEP 7.** Tighten all hardware to the recommended torque setting unless otherwise stated.

## OPERATION

YETTER MODEL 2984 Maverick Opener is a multi-functional tool designed for use in any fertilizer management system. The Maverick Opener fully equipped, is capable of residue management, precision

fertilizer placement, soil tilth and soil berm/mound building all in one pass. Thus creating a seed bed that will increase your Return On Investment.



It is important to know that the Maverick Opener<sup>®</sup> unit is similar to a row crop planter unit in operation, thus it is very important to adjust the frame height and levelness for best performance. Soil conditions (i.e.; frozen soil, rocks, heavy, tough residue) have a major influence on the performance of the Maverick Opener<sup>®</sup>. If damp soil is building up on the wheels, discs or knives than conditions are less than ideal and the Maverick Opener<sup>®</sup> will not perform at its best.

The unit when equipped with sealing wheels is ideal for controlling soil disturbance and leaving a level soil surface with the fertilizer sealed in. The unit equipped with sealing discs may be set up to close the knife slot with the blades pushing or with the blades turned to pull, form a mound or “berm” of soil over the knife slot to seal in the fertilizer.

**CAUTION** Frozen soil or heavy rock population may cause damage to the Maverick Opener<sup>®</sup>.

**IMPORTANT:** For proper operation, the toolbar frame must operate level (for, aft and side to side) and at the correct height, typically 21”-24”.



In hard or rocky soil conditions, the desired operating depth of the knife may not be possible.



Increase the spring pressure to obtain the desired depth rather than lower the toolbar frame below the 21” minimum recommended setting. Toolbar weight may limit operating depth in hard soil conditions, add ballast to the toolbar frame. Example 200#’s per opener have been added to the frame to achieve the desired depth. Operating depth of the Maverick Opener<sup>®</sup> is affected by spring tension, toolbar height, levelness of toolbar and soil tilth. As soil conditions change, toolbar settings and coulters adjustments will need to be changed as well.

Toolbar gauge wheel kits are optional but recommended for use with the Maverick Opener<sup>®</sup> because of toolbar frame height being critical for proper operation, 21”-24”.

1. Set/mount coulters blades to run perpendicular to the soil. Operation depth and blade wear can be affected if the coulters mounted crooked or if the toolbar is not level side to side.
2. After a few hours of use, check all bolts for tightness and proper torque.
3. After a day of use (10-12 hours) check coulters hubs for loose bearings. There should be no end play in the hub bearings allowing the blade to wobble. If necessary, remove cotter pin and adjust the slotted nut to remove wobble, recommended torque of 13 ft. lbs. and re-insert cotter pin. If the wobble or looseness can not be corrected, the bearings, cups and seals will need to be replaced. DO NOT REUSE WORN OR DAMAGED PARTS.

## OPERATION

### WARNING

Never clean, lubricate or adjust a machine that is in motion. Always lower or block the implement before performing service.

If machine must be serviced in the raised position, jack or block it up to prevent it from accidentally falling and injuring someone.

Do not allow riders on the tractor or implement.

Use speeds and caution dictated by the terrain being traversed. Do not operate on any slope steep enough to cause tipping or loss of control.

Be sure all personnel are clear of the immediate area before operating.

Read and understand the operator's manual and require all other persons who will operate the equipment to do the same.

Be familiar with all tractor and implement controls and be prepared to stop engine and implements quickly in an emergency.

## FAILURE TO HEED MAY RESULT IN PERSONAL INJURY OR DEATH.

**NOTE:** Adjustments to the Maverick Opener are best done while in the field where the unit is to be operated.

**STEP 1.** Set the toolbar frame height for 21"-24". 22" from the top of the soil to the bottom of the toolbar seems to work for the best performance of the Maverick Opener. Adjust the toolbar gauge wheels up or down to get the 22" from the bottom of the gauge wheel to the bottom of the toolbar. Adjust the spring tension on the upper parallel arm; forward for lighter setting and rearward for heavier setting (TWO ADDITIONAL SPRINGS ARE AVIALABLE IF NEEDED). The pin must be installed to hold the spring bar at the desired setting. Add or remove weight to the toolbar to achieve the proper toolbar frame height.

**NOTE:** Toolbar frame levelness and height adjustments are very important settings for correct performance of the coulters.

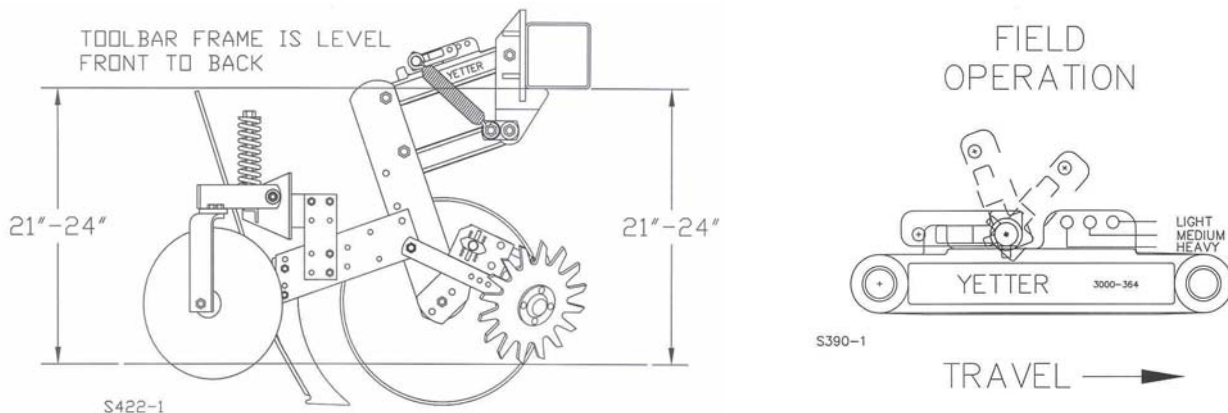

## OPERATION

**STEP 2.** Set the coulters depth based on soil conditions, (i.e. tilth, stones or crop residue). For proper operation of the Maverick Opener, the coulters must cut through crop residues including roots. For best performance 3"-4" depth is recommended. Maximum depth is 6", raising blades helps to cut residue rather

than pushing it ahead and not cutting. Deep blades put the hub and mounting plates close to the surface and create plugging in heavy residue.

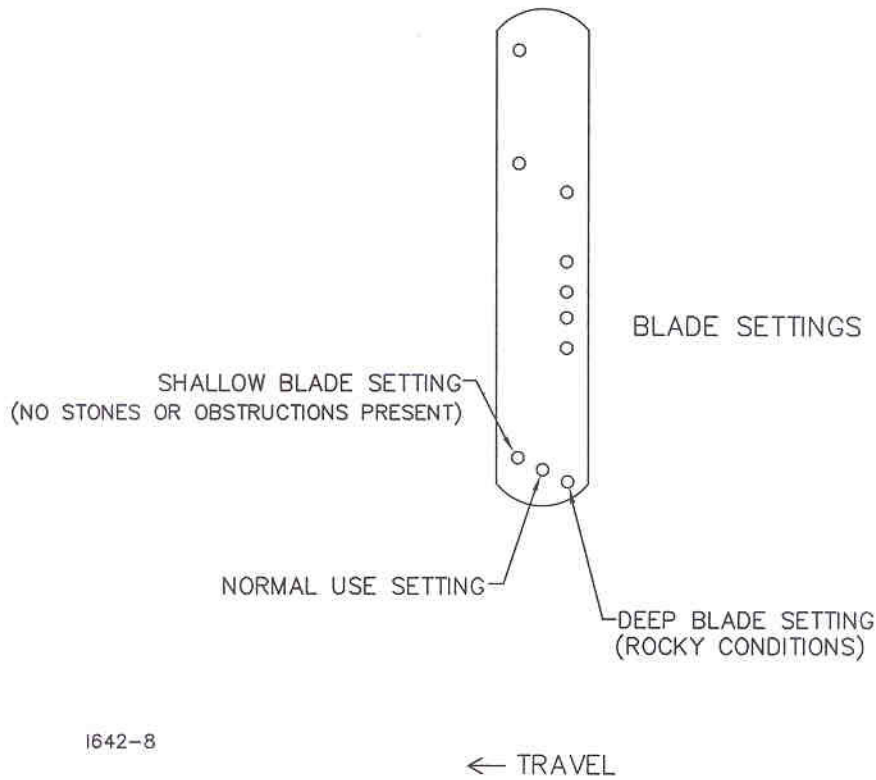

NOTE: When properly adjusted the Maverick Opener Generation II will ride up and over rocks and other obstacles if present in the soil.

**STEP 3.** Set the knife depth for typical application of fertilizer in the lower adjustment holes and for shallow applications use the upper set of holes.

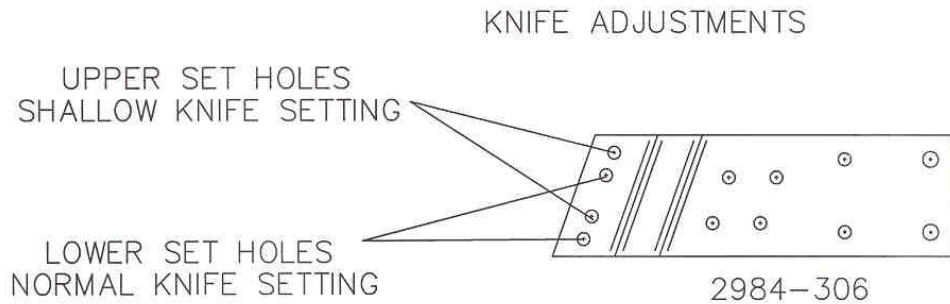

## OPERATION

**STEP 4.** Adjustment of the “SKID SHOE” soil distribution guard/depth control is important for proper placement of fertilizer and keeping soil from sticking to the coulters blade. Depth adjustment setting will depend on coulters blade diameter and coulters blade settings. The lower the “SHOE” is on the blade, the



shallower the fertilizer will be placed. The higher the “SHOE” is on the blade, the deeper the fertilizer will be placed. Soil disruption setting is controlled with the side to side adjustment of the “SHOE”. The poly shoe should just touch the blade, front to back of the “SHOE”.

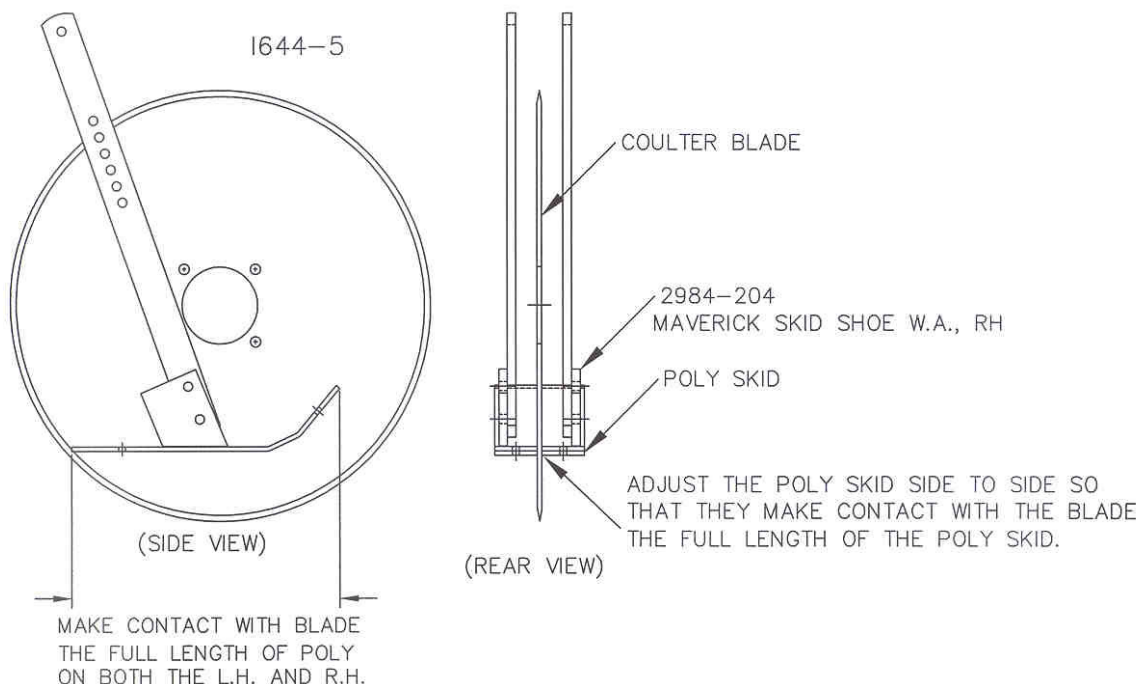

**STEP 5.** Adjust the residue manager to move crop residue aside and not move any soil. Adjustments to the residue manager may have to be made when changing field conditions and type and amount of residue.

#### ROW CLEANER DO's AND DON'T's

1. **DO NOT** move soil, Residue Managers are designed to move crop residue only.
2. **DO NOT** operate toolbar at slow speeds, ground speed affects how aggressive the spoke wheels are; operate at sufficient speed (5-7 mph) to maintain good residue flow.
3. **DO NOT** expect 100% of crop residue to be cleared, it is not necessary and would necessitate engaging the soil. The width of path cleared depends on ground conditions, depth setting and ground speed.
4. **DO** expect to see wheels occasionally quit turning, indicates ideal (shallow) setting which is not moving soil.
5. **DO** adjust toolbar frame height 21"-24" and drawbar correctly. Very important to ensure Maverick Opener will follow ground contours properly.
6. **DO** adjust Maverick Opener down pressure kit correctly to prevent excessive depth.

**STEP 6.** Adjust the Sealing Discs/Wheels. The width and height of the mound/berm depends on ground conditions, depth setting, spring tension, blade angle and ground speed. A popular setting for the blade adjustment is 8" at the rear of the blades, equal distance from the center of the row.

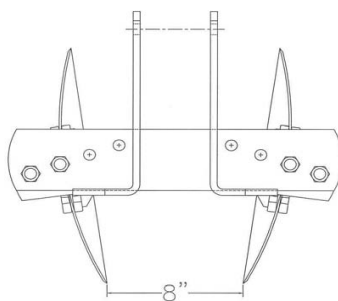

S196

## OPERATION

**STEP 6. CONTINUED**

**CAUTION:** Raise toolbar to transport position and install all safety locks before adjusting the closing wheels.

**CLOSING WHEELS.** Angled closing wheels trail behind the opener to close the trench left by the blade.

Adjustable spring pressure permits proper firming of soil beside the trench rather than directly above it.



An eccentric bushing allows centering of the closing wheel on the row to properly apply pressure on both sides of the slot when closing the trench. When adjusted properly, the closing wheels are centered on the trench.

To adjust, loosen the bolt that attaches the closing wheel arm to wheel mount bracket. Rotate the eccentric bushing with wrench to align the closing wheel assembly with center of trench. Tighten bolt that attaches closing wheel arm to wheel mount bracket.

(CLOSING WHEEL ASSEMBLY SHOWN NOT ASSEMBLED TO COULTER FOR VISUAL CLARITY)

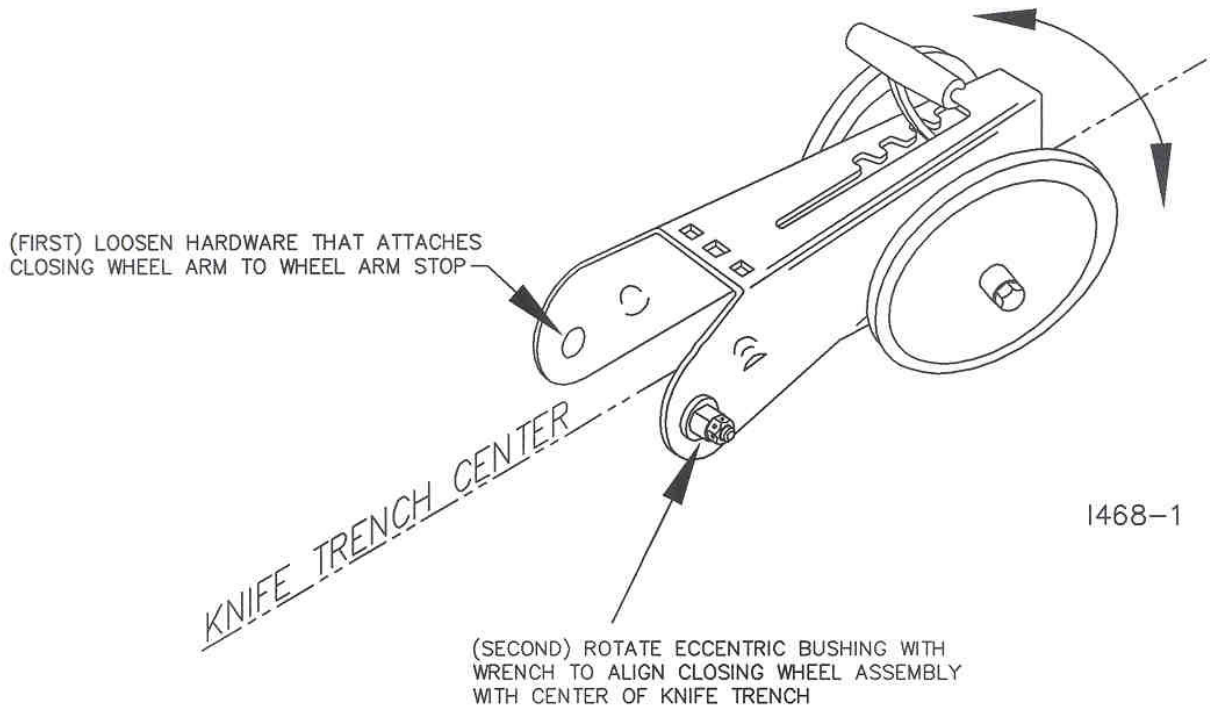

**NOTE:** After setting coulter to correct depth, check operation of closing wheels. The closing wheels must apply enough down pressure to close the trench and insure a good seal at the soil surface.

## OPERATION

## STEP 6. CONTINUED

Proper adjustment of the sealing wheels is that the soil surface is left flat and appears to be virtually undisturbed. To adjust the tension on the spring tightener or loosen the  $\frac{3}{4}$ " lock nut. To adjust the height of the sealing wheels, remove the adjustment pin and raise or lower the stem, reinstall pin in the aligning adjustment holes.

NOTE: For proper operation of the sealing wheels, the narrowest gap between the wheels should be forward and the widest spacing to the rear.

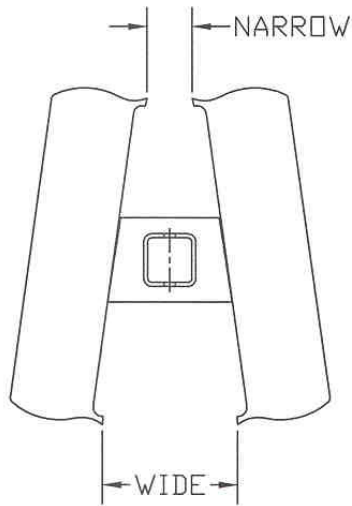

↑ TRAVEL

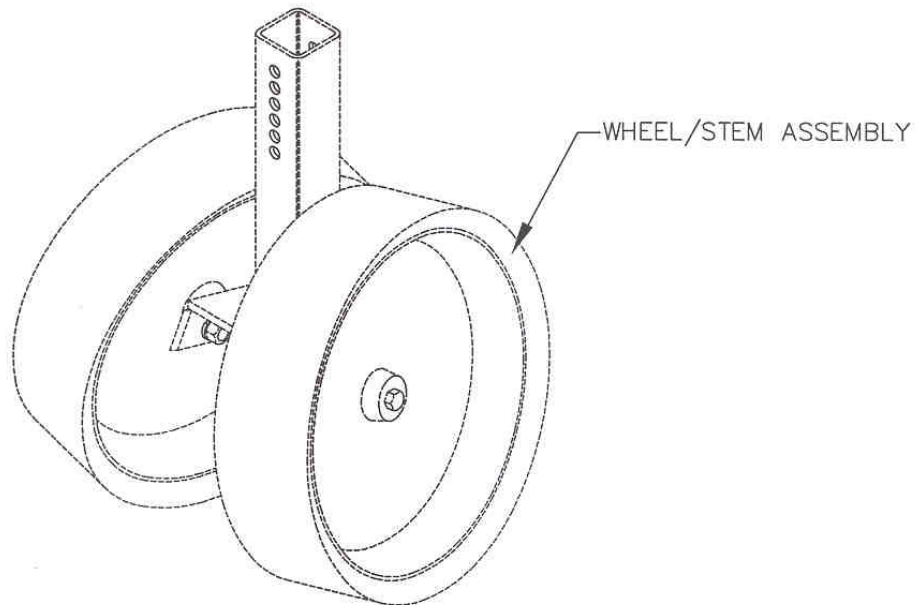

1647-7

**OPERATION  
MAINTENANCE**

## LUBRICATION: USE #2 MULTI-PURPOSE POLYUREA GREASE

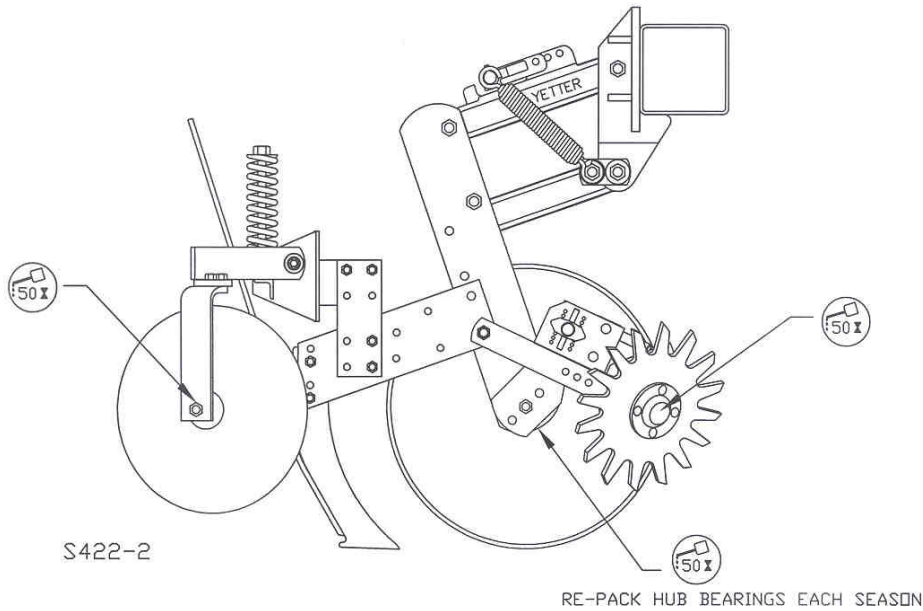

To ensure longevity and reliability of the Maverick Opener, the recommended lubrication schedule should be followed using multi-purpose grease at hourly intervals as indicated.

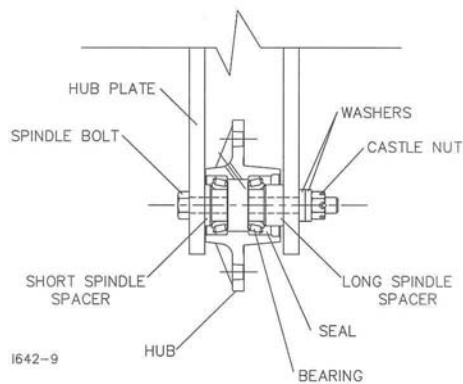

### BEARING ADJUSTMENT:

1. Raise the toolbar until the blade is clear of the ground. Place a safety stand under the toolbar. Remove the cotter pin, slotted nut, washer and bolt from the hub assembly. Remove the blade from the hub assembly.
2. Remove bearing cones and seal from the hub.
3. Wash the old grease from the hub, bearing cups, spindle spacers, seals and bearing cones. Inspect the condition of bearing cups, cones and seals. Replace if necessary.
4. Apply #2 multi-purpose polyurea grease on each bearing. Make sure the space around each roller is filled. Lubricate the bearing cups.
5. Position the bearing in the cup and install the seal. Lubricate the seal lips and proceed with re-assembly of the removed parts including the blade. Blade bolt torque is 90 to 96 ft/lbs.
6. Tighten the slotted nut to 10 to 15 ft/lbs. or until a definite drag is felt when the blade is turned by hand. Back off the nut one slot position to line up the cotter pin hole with a slot. Secure the nut with a new cotter pin.

### KNIFE WEAR:

The lower portion of the knife and tube are subject to wear during operation. The rate of wear will depend on a variety of factors and in abrasive soil conditions the wear will be more rapid.

NOTE: In certain areas, replacement knives should be kept in stock, replacing worn knives as needed.

## MAINTENANCE

### BEARING ASSEMBLY AND LUBRICATION

### Practice Safety

Understand and practice safe service procedures before doing work. Follow ALL the operating, maintenance and safety information in the equipment operator manual. Clear the area of bystanders, especially small children, when performing any maintenance or adjustments. Keep work area clean and dry. Use adequate lighting for the job. Use only tools, jacks and hoists of sufficient capacity for the job.

Never lubricate, service, or adjust machine while it is moving. Keep hands, feet, and clothing from power-driven moving and rotating parts. Disengage all power and operate controls to relieve pressure. Lower equipment to the ground and stop the engine. Remove the key. Wait for all moving parts to stop before servicing, adjusting, repairing or unplugging.

Securely support any machine elements with blocks or safety stands that must be raised for service work.

Keep all parts in good condition and properly installed. Fix damaged equipment immediately. Replace worn or broken parts. Remove any buildup of grease, oil, or debris. Make sure all guards are in place and properly secured when maintenance work is completed.

### Assembly

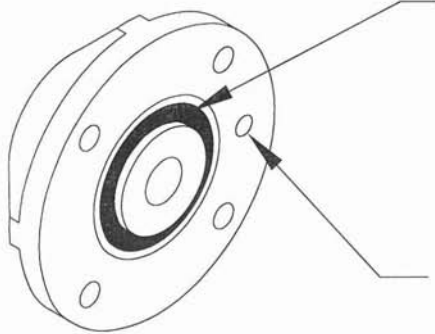

IF YOU CHOOSE TO LEAVE THE SEAL, THEN YOU NEED TO FILL CAVITY WITH GREASE. IF YOU CHOOSE TO REMOVE THE SEAL, THEN YOU NEED TO FILL CAVITY AND MAINTAIN THE GREASE EVERY 50 HOURS OF USE.

ALIGN GREASE FITTING HOLES.

1190-3

## MAINTENANCE

ALIGN THE HUB CAP GROOVE,  
WITH THE WHEEL SLOT AND  
GREASE FITTING

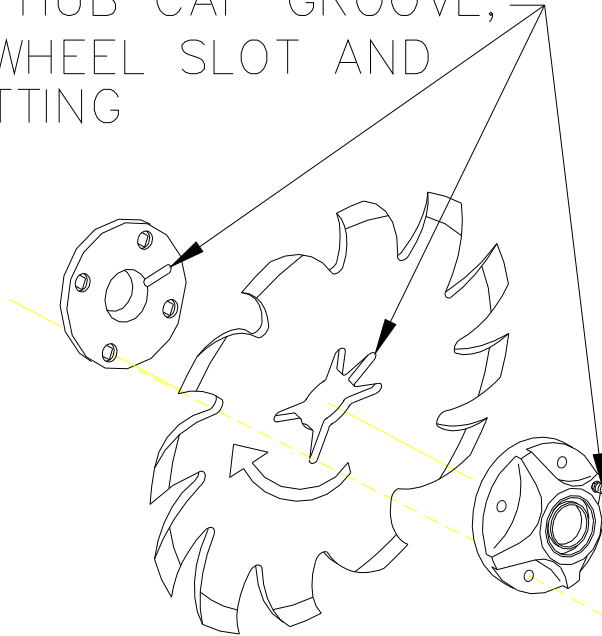

**NOTE:** Be certain to align the grease fitting with the slot in the wheel and the hubcap so that the grease can flow freely.

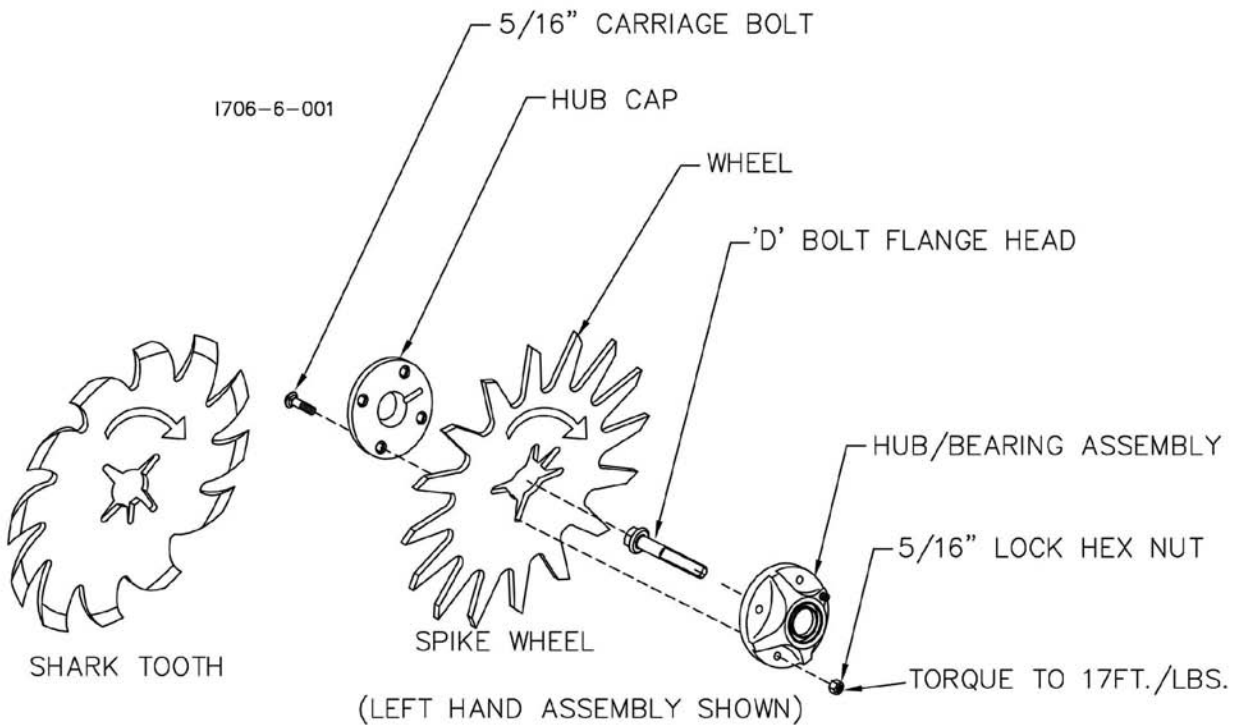

# MAINTENANCE

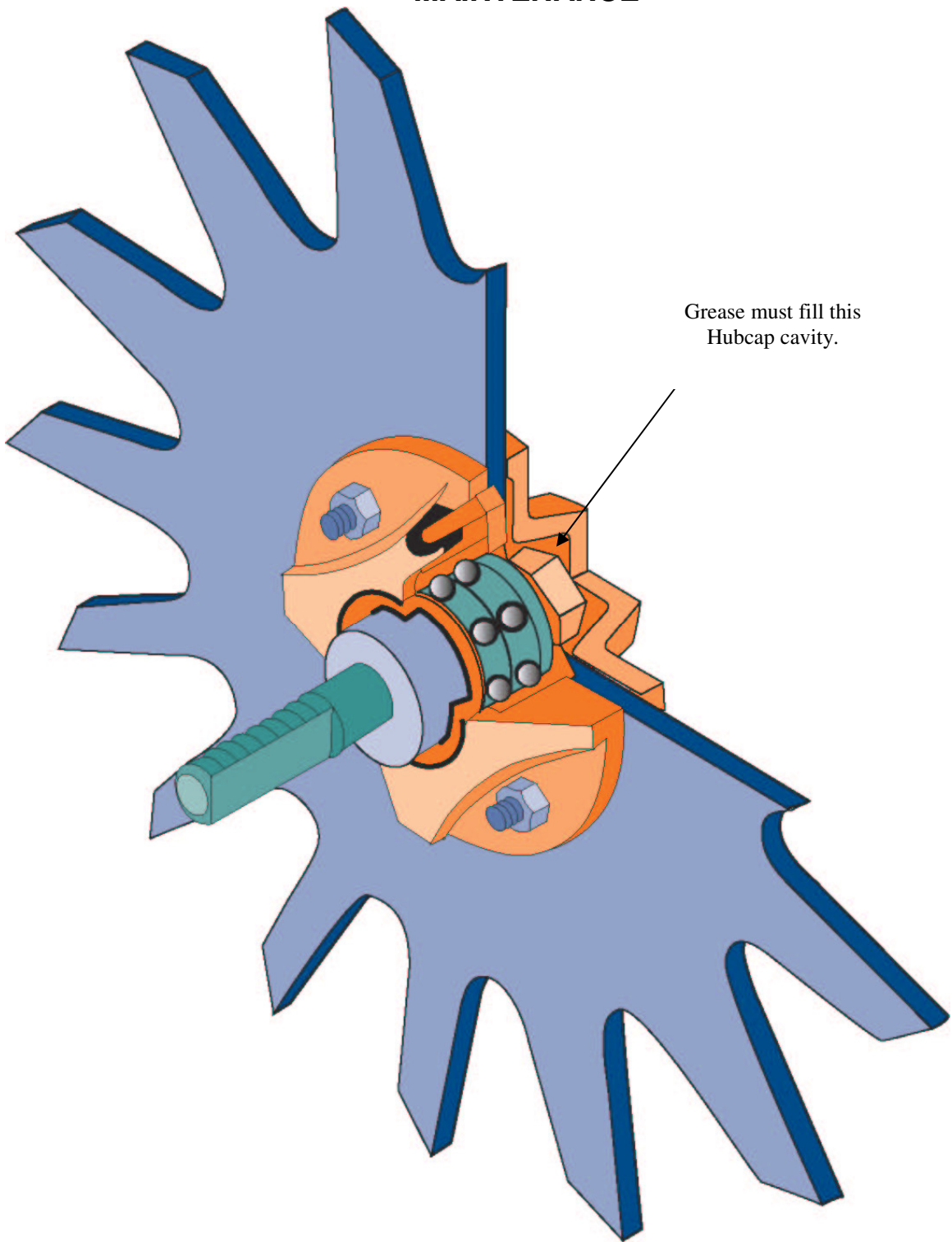

# MAINTENANCE

## Lubrication



**CAUTION:** To help prevent serious injury or death to you or others caused by unexpected movement, service machine on a level surface. Lower machine to ground or sufficiently lock or block raised machine before servicing. If machine is connected to tractor, engage parking brake and place transmission in "PARK", shut off engine and remove key. If machine is detached from tractor, block wheels and use shop stands to prevent movement.



**CAUTION:** Do not clean, lubricate, or adjust machine while in motion.

Use grease based on NLGI consistency numbers and the expected air temperature range during the service interval.

Use a **multi-purpose polyurea, water resistant, moderate speed, and NLGI grade #2** grease.

Other greases may be used if they meet the following **NLGI Performance**

**IMPORTANT:** Some types of grease thickener are not compatible with others. Consult your grease supplier before mixing different types of grease.

## Alternative Lubricants

Conditions in certain geographical areas may require special lubricants and lubrication practices which do not appear in the operator's manual. If there are any questions, consult Yetter Manufacturing Co. to obtain latest information and recommendation.

PART #	DESCRIPTION	OUNCES OF GREASE
2967-404	13" TAPER TOOTH R.M. WHEEL	1.12 OZ
2967-602	13" SHARK TOOTH R.M. WHEEL	1.12 OZ
2967-186	FLOATER WHEEL KIT W/R.M. WHEEL	2.08 OZ
2967-596	HEAVY DUTY OR BEVEL R.M. WHEEL W/ FLOATER WHEEL KIT	2.40 OZ

## Storing Lubricants

Your machine can operate at top efficiency only if clean lubricants are used.

Use clean containers to handle all lubricants.

Store them in an area protected from dust, moisture and other contaminants.



# MAINTENANCE

## Lubrication Symbols



Lubricate with grease at hourly interval indicated on symbol.

## Lubrication Intervals

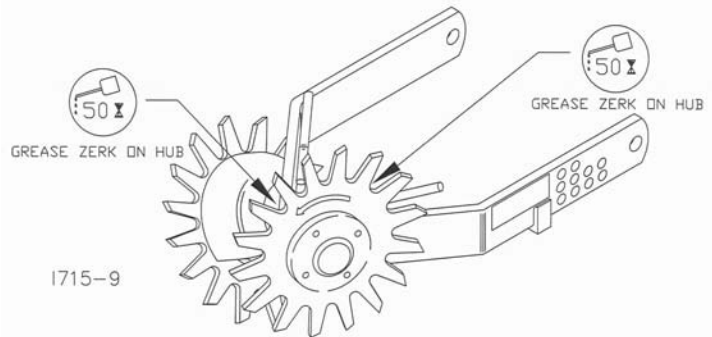

**IMPORTANT: The recommended service intervals are based on normal conditions; severe or unusual conditions may require more frequent lubrication.**

Perform each lubrication and service procedure at the beginning and end of each season.

Clean grease fittings before using grease gun, to avoid injecting dirt and grit into the bearing. Replace any lost or broken fittings immediately. If a fitting fails to take grease, remove and clean thoroughly, replace fitting if necessary. Also check for failure of adjoining parts.

## BEARING REPLACEMENT INSTALLATION

1. If you wish to be able to grease the bearings in the hubs, remove the seal from one side of the bearings as illustrated before assembly. Otherwise the bearings may be left "sealed for life".
2. When assembling the spoke wheels, bearing assembly and hubcap, be sure to align the grease transfer hole in the spoke wheel with the groove in the hubcap and hole in the hub to allow grease passage.
3. Install/assemble the wheels, hubs and caps.
4. Grease the wheel/hub/bearing assembly.

# MAINTENANCE

## Storing the Equipment

Store the machine in an area away from human activity

Store machine in RAISED position.

Install service locks on all wheel cylinders.

At the end of the season, the machine should be thoroughly inspected and prepared for storage. Repair or replace any worn or damaged components to prevent down time at the start of the next season. Store machine under cover with all parts in operating condition.

- Clean machine thoroughly to remove all dirt, debris and crop residue, which would hold moisture and cause rusting.
- Inspect machine for worn or broken parts. See your Yetter Farm Equipment dealer during the off-season so that parts or service can be acquired when machine is not needed in the field.
- Lubricate bearings as outlined in the Lubrication section
- Paint all parts which are chipped or worn and require repainting.
- Store machine in a clean, dry place with the planting unit out of the sun.
- If the machine cannot be stored inside, cover with a waterproof tarpaulin and tie securely in place.
- Do not allow children to play on or around the machine

# PARTS IDENTIFICATION

## 2984-002 - GENERATION II MAVERICK

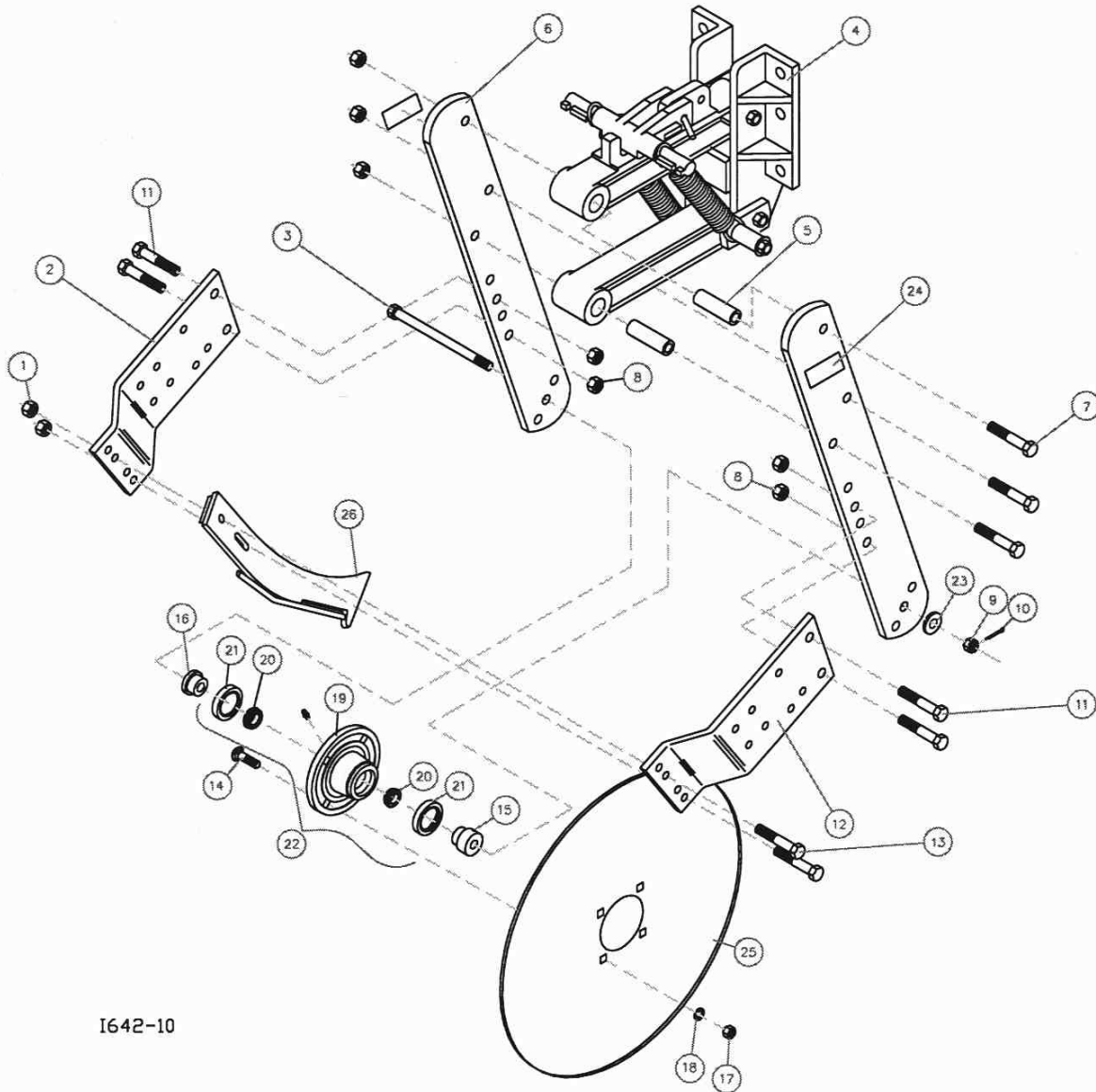

I642-10

DET	QTY	PART NO.	DESCRIPTION
1	2	2520-357	1/2-13 LOCK HEX NUT ZP
2	1	2984-307	FORMED KNIFE MOUNT, LH
3	1	2984-311	MAVERICK SPINDLE BOLT
4	1	3000-122	PARALLEL ARM ASSEMBLY
5	2	2960-370	SPINDLE SPACER, 3-13/64"
6	2	2984-308	MAVERICK HUB PLATE
7	3	2502-397	5/8-11 X 5-1/2 HHCS GR5 ZP
8	7	2520-459	5/8-11 LOCK HEX NUT ZP
9	1	2520-469	5/8-18 SLOTTED HEX NUT, BLACK
10	1	2531-107	1/8 X 1 COTTER PIN ZYD
11	4	2502-331	5/8-11 X 1-3/4" HHCS GR5 ZP
12	1	2984-306	FORMED KNIFE MOUNT, RH
13	2	2502-350	1/2-13 X 2 HHCS GR 8 ZP
14	4	2505-339	1/2-13 X 1-1/2" CAR BLT GR 5 ZP

DET	QTY	PART NO.	DESCRIPTION
15	1	2984-309	HUB SPACER, LONG (1 13/32)
16	1	2984-310	HUB SPACER, SHORT (29/32)
17	4	2520-352	1/2-13 HEX NUT ZP
18	4	2525-352	1/2" LOCKWASHER ZP
19	1	2900-105	HUB PRESSED ASSEMBLY
	1	2533-110	1/4-28 ZERK STRAIGHT SELF-TAP
	2	2550-029	CUP, LM67010
	2	2550-027	CONE, LM6704B
	2	2550-066	TRIPLE LIP SEAL, NTI #1812-4
	1	2984-107	HUB ASSEMBLY (INCLUDES 19,20,21)
	23	24H1367	WASHER 21/32" X 1-1/4" X 1/4"
	24	2565-162	YETTER DECAL, 1-1/2 X 4-1/2
			<u>NOT INCLUDED IN 2984-002</u>
	25	2571-199	.157X20" MULTI HOLE FLAT BLADE
	1	2571-196	.236 X 22" MULTI HOLE COULTER BLADE
	26	2920-204	NH3 KNIFE W/TUBE PROTECTOR

REVISED 03/19/08

# PARTS IDENTIFICATION

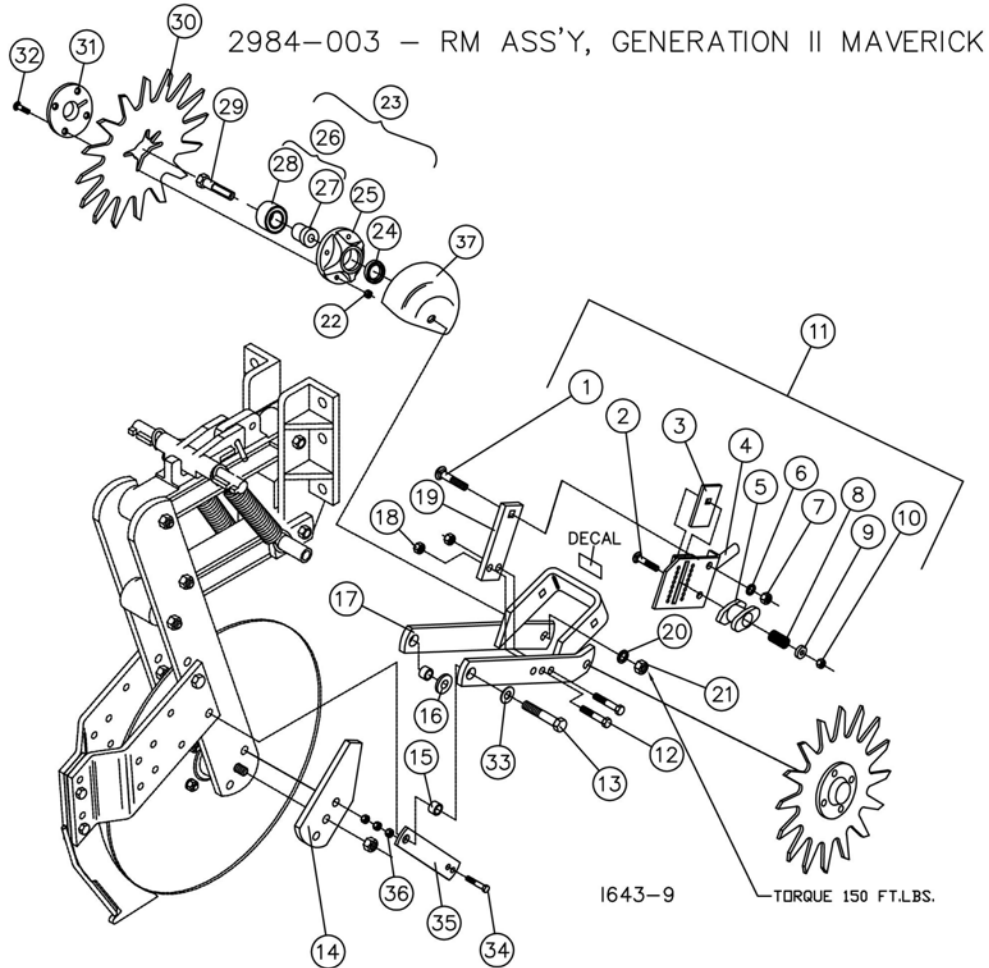

DET	QTY	PART NO.	DESCRIPTION	DET	QTY	PART NO.	DESCRIPTION
1	1	2505-339	1/2-13 X 1-1/2 CAR BOLT GR5	20	2	2525-451	5/8 MED LOCKWASHER ZP
2	1	2505-255	3/8-16 X 2-1/4 CAR BOLT GR5	21	2	2520-452	5/8-11 HEX NUT ZP
3	1	2967-255	STOP PLATE W.A.	22	8	2520-206	5/16-18 FLANGE LOCK NUT
4	1	2967-254	ADJ. PLATE W.A.	23	2	2965-128	HUB & BEARING ASS'Y, 4 BOLT
5	1	2967-249	ADJUSTMENT HANDLE	24	1	2550-069	SEAL, TRIPLE LIP, NTN# 1812-5
6	1	2525-352	1/2 MED LOCKWASHER ZP	25	1	2965-351	HUB CAST., MACHINED, 4 BOLT
7	1	2520-352	1/2-13 HEX NUT ZP	1	1	2533-110	1/4-28 ZERK STRAIGHT SELF-TAP
8	1	2550-769	SPRING, ADJ PIN, ZYD	26	1	2965-127	BEARING & INSERT ASS'Y
9	1	2967-454	3/8 ID X 15/16 OD X 1/4 BUSHING	27	1	2570-715	BEARING INSERT, TRASHMASTER
10	1	2520-255	3/8-16 LOCK HEX NUT ZP	28	1	2570-594	BEARING, 2 ROW NTN# DF0654L
11	1	2967-175	2967-070 QUICK ADJ ASS'Y	29	2	2570-740	5/8-11 X 3" 'D' BOLT GR5 ZP
12	2	2502-294	1/2-13 X 1-1/2 HHCS GR5 ZP	30	2	2967-404	13" TAPER TOOTH SPOKE WHEEL
13	2	2502-325	5/8-11 X 3 HHCS GR5 ZP	31	2	2965-352	HUB CAP CASTING, 4 BOLT, BLACK
14	1	2984-312	STOP PLATE	32	8	2505-208	5/16-18 X 1-1/2 CAR BOLT GR5 ZP
15	2	6000-335	9/16" BUSHING ZP	33	2	2526-453	5/8 SAE FLATWASHER ZP
16	1	2526-455	WASHER, 21/32" X 1-1/4" X 1/4"	34	1	2502-244	3/8-16 X 1-1/4 HHCS GR5 ZP
17	1	2967-265	MAVERICK COMBO ARM W.A.	35	1	2984-314	RM LOCK STRAP
18	2	2520-357	1/2-13 LOCK HEX NUT ZP	36	3	2520-251	3/8-16 HEX NUT ZP
19	1	2984-313	QUICK ADJ. MOUNT PLATE	37	2	2967-392	SHIELD, RM COMBO-PAINTED

REVISED 11/21/16

# PARTS IDENTIFICATION

## 2984-004 - DEPTH CONTROL SOIL DISRUPTION GUARD

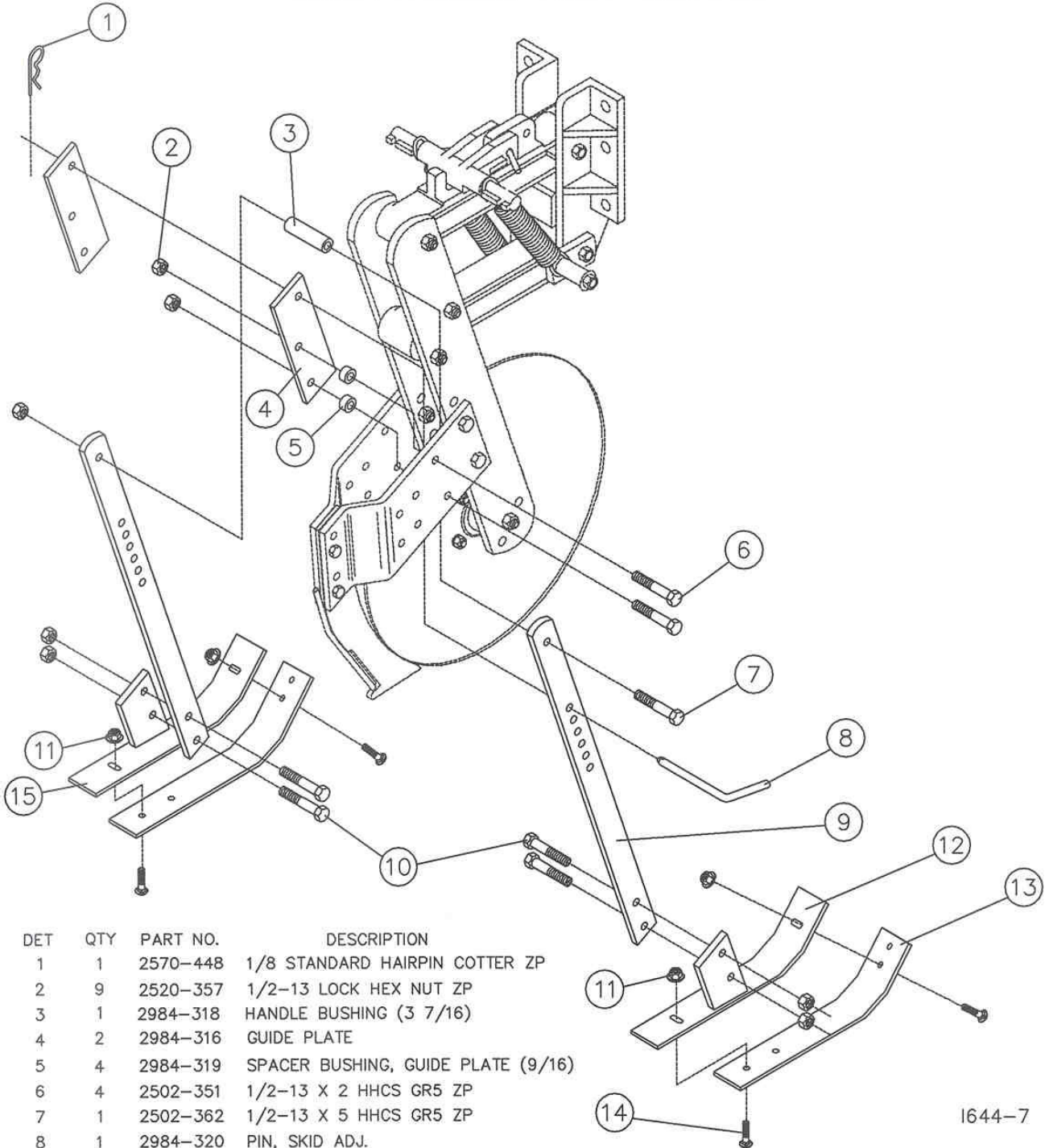

DET	QTY	PART NO.	DESCRIPTION
1	1	2570-448	1/8 STANDARD HAIRPIN COTTER ZP
2	9	2520-357	1/2-13 LOCK HEX NUT ZP
3	1	2984-318	HANDLE BUSHING (3 7/16)
4	2	2984-316	GUIDE PLATE
5	4	2984-319	SPACER BUSHING, GUIDE PLATE (9/16)
6	4	2502-351	1/2-13 X 2 HHCS GR5 ZP
7	1	2502-362	1/2-13 X 5 HHCS GR5 ZP
8	1	2984-320	PIN, SKID ADJ.
9	2	2984-315	ADJ. LINK, MAVERICK SKID
10	4	2502-294	1/2-13 X 1-1/2 HHCS GR5 ZP
11	4	2520-258	3/8-16 HEX FLANGE LOCK NUT ZP
12	1	2984-204	MAVERICK SKID SHOE W.A., RH
13	2	2984-317	MAVERICK SKID SHOE POLY
14	4	2505-260	3/8-16 X 1 CAR BOLT GR5 ZP
15	1	2984-203	MAVERICK SKID SHOE W.A., LH

1644-7

# PARTS IDENTIFICATION

2984-007 – GENERATION II MAVERICK SEALER KIT

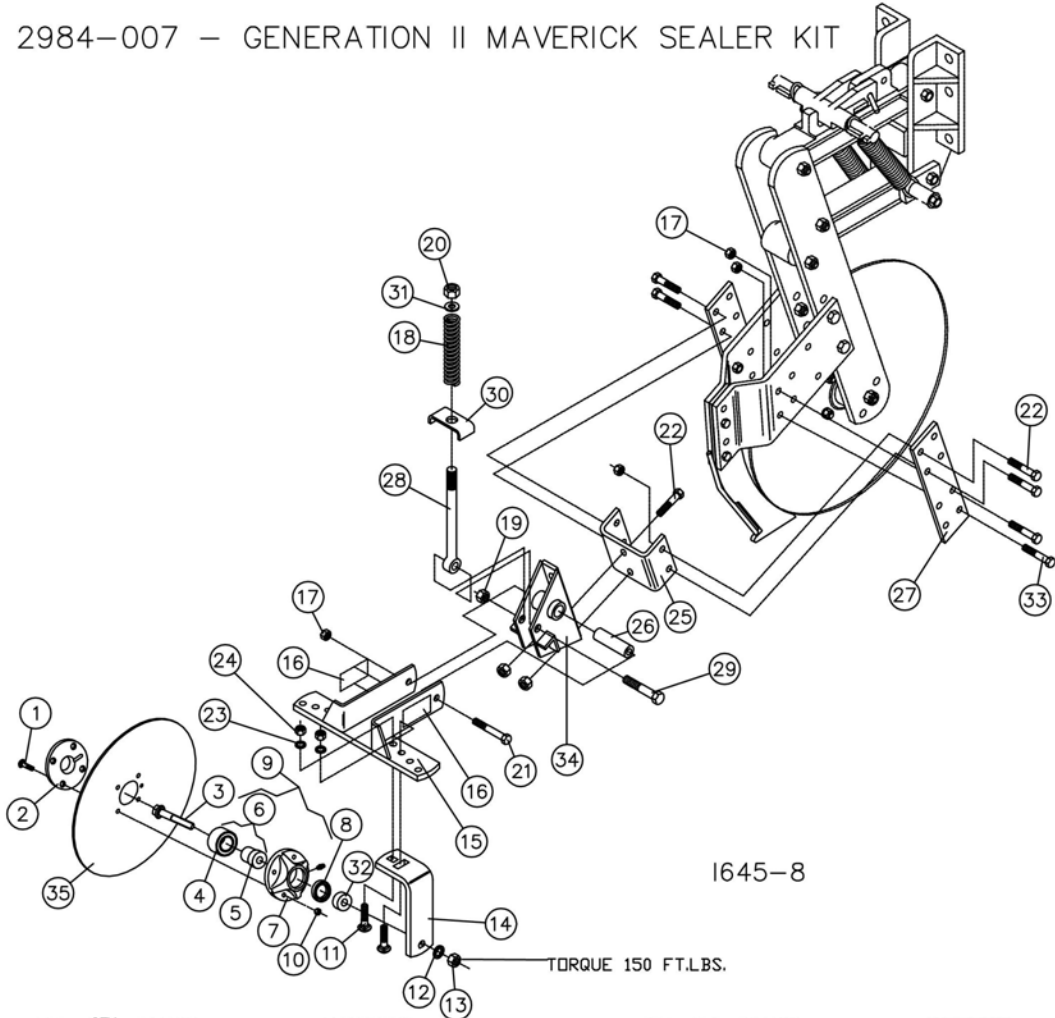

1645-8

TORQUE 150 FT.LBS.

DET	QTY	PART NO.	DESCRIPTION	DET	QTY	PART NO.	DESCRIPTION
1	8	2505-207	5/16-18 X 1 1/4 CAR BLT GR5 ZP	18	1	2920-350	COMPRESSION SPRING, SEALER
2	2	2965-352-DISC	HUB CAP CASTING, 4 BOLT, BLACK	19	1	2520-467	5/8-11 JAM HEX LOCK NUT ZP
3	2	2570-742	5/8-11 X 4" 'D' BOLT GR. 8 ZYD	20	1	2520-515	3/4-10 LOCK HEX NUT ZP
4	2	2570-594	BEARING, 2 ROW NTN# DF0654LU	21	1	2502-363	1/2-13 X 4-1/2 HHCS GR. 5 ZP
5	2	2570-715	BEARING INSERT, TRASHMASTER	22	6	2502-293	1/2-13 X 1-1/4 HHCS GR. 5 ZP
6	2	2965-127	BEARING & INSERT ASS'Y (INCLUDES 4&5)	23	4	2525-352	1/2 MED LOCKWASHER ZP
7	2	2965-351	HUB CAST.,MACHINED, 4 BOLT	24	4	2520-352	1/2-13 HEX NUT ZP
	2	2533-110	1/4-28 ZERK STRAIGHT SELF-TAP	25	1	2984-323	DISC SEALER MOUNT BRACKET
8	2	2550-069	SEAL, TRIPLE LIP, NTN# 1812-5	26	1	2920-342	INNER PIVOT BUSHING, ZYD
9	2	2965-128	HUB AND BEARING ASS'Y.,4 BOLT	27	2	2984-324	SEALER MOUNT PLATE
10	8	2520-206	5/16-18 FLANGE LOCK NUT	28	1	2920-324	PUSHROD, 9 3/16" EYEBOLT, ZP
11	4	2505-345	1/2-13 X 2 CAR BLT GR. 5 ZP	29	1	2502-393	5/8-11 X 2-1/2 HHCS GR. 5 ZP
12	2	2525-451	5/8 MED LOCKWASHER ZP	30	1	2920-330	BRACKET, DISC SEALER SPRING
13	2	2520-452	5/8-11 HEX NUT ZP	31	1	2975-302	2975 SPRING BUSHING "PAINTED"
14	2	2920-329	BRACKET, DISC SEALER	32	2	2967-302	SPACER, 3/4" ZYD
15	1	2920-209	DISC SEALER ARM W.A.	33	4	2502-294	1/2-13 X 1-1/2 HHCS GR5 ZP
16	2	2565-162	YETTER DECAL, 1-1/2 X 4-1/2	34	1	2920-210	MOUNTING BRKT. W.A.
17	11	2520-357	1/2-13 LOCK HEX NUT ZP	<b>OPTIONAL DISCS NOT INCLUDED IN 2984-007</b>			
				35	1	2571-173	DISC, .138 GA. X 16", 4 BOLT (DULL EDGE)
					1	6001-495	MARKER DISC,NOTCH,PUNCH,4 BOLT
					1	2571-181	.098 X 12" DISC, 4 BOLT
					1	2571-187	16" NOTCHED SEALER BLADE

REVISED 10/27/16

# PARTS IDENTIFICATION

2984-008 - V-CLOSING WHEEL KIT GENERATION II MAVERICK

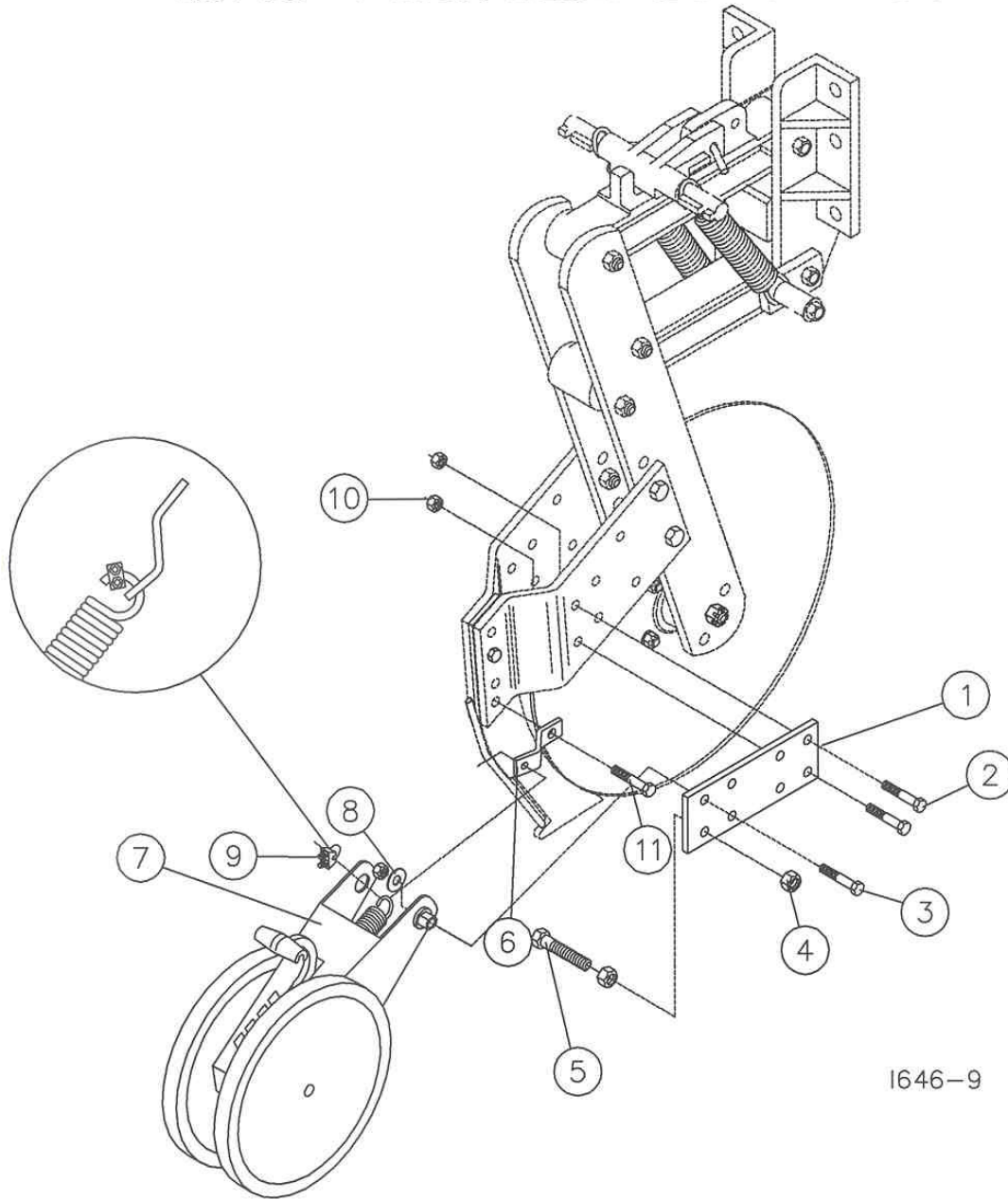

1646-9

KEY	QTY	PART NO.	DESCRIPTION
1	2	2984-324	SEALER MOUNT PLATE
2	4	2502-294	1/2-13 X 1-1/2 HHCS GR5 ZP
3	2	2502-317	1/2-13 X 1-3/4 HHCS GR5 ZP
4	2	2520-352	1/2-13 HEX NUT ZP
5	1	2502-346	1/2-13 X 2 FULL THD HHCS GR5 ZP
6	1	2984-325	V-CLOSING WHEEL SPRING ANCHOR
7	1	6000-002	CLOSE WHEEL KIT
8	2	2526-351	1/2 STANDARD FLATWASHER ZP
9	1	2570-710	1/8" CABLE CLAMP ASS'Y
10	4	2520-357	1/2-13 LOCK HEX NUT ZP
11	1	2502-353	1/2-13 X 2-1/2 HHCS GR8 ZP

# PARTS IDENTIFICATION

6000-002 CLOSE WHEEL KIT ASSEMBLY

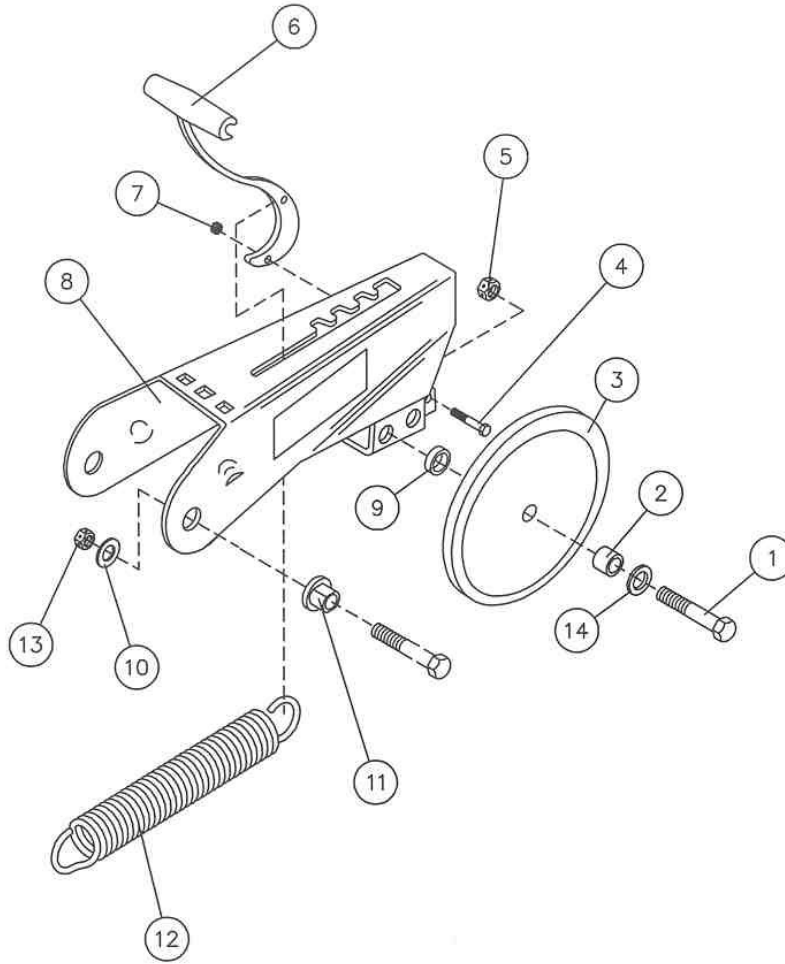

1455-1

KEY	QTY	PART NO.	DESCRIPTION
1	2	2502-336	5/8-11 X 4 HHCS GR. 5 ZP
2	2	6000-335	9/16" BUSHING
3	2	2570-751	1 X 12 NYL CLOSING WHEEL 40MM SMCR
	2	2550-061	BEARING, 40 MM
4	1	2502-206	5/16-18 X 1 1/2 HHCS GR. 5 ZP
5	2	2520-459	5/8-11 LOCK HEX NUT ZP
6	1	6000-524	CLOSE WHEEL LEVER
7	1	2520-205	5/16-18 LOCK HEX NUT ZP
8	1	6000-247	CLOSE WHEEL ARM W.A.
	2	2565-162	YETTER DECAL, 1-1/2 X 4-1/2
9	2	6000-336	BUSHING PIVOT
10	2	2526-351	1/2 STANDARD FLATWASHER ZYD
11	2	6000-523	ECCENTRIC BUSHING CLOSE WHEEL
12	1	6000-525	CLOSE WHEEL SPRING (PAINTED)
13	2	2520-357	1/2-13 LOCK HEX NUT ZP.
14	2	2526-453	5/8 SAE FLATWASHER



# PARTS IDENTIFICATION

2984-009 - GENERATION II MAVERICK SEALING WHEEL KIT

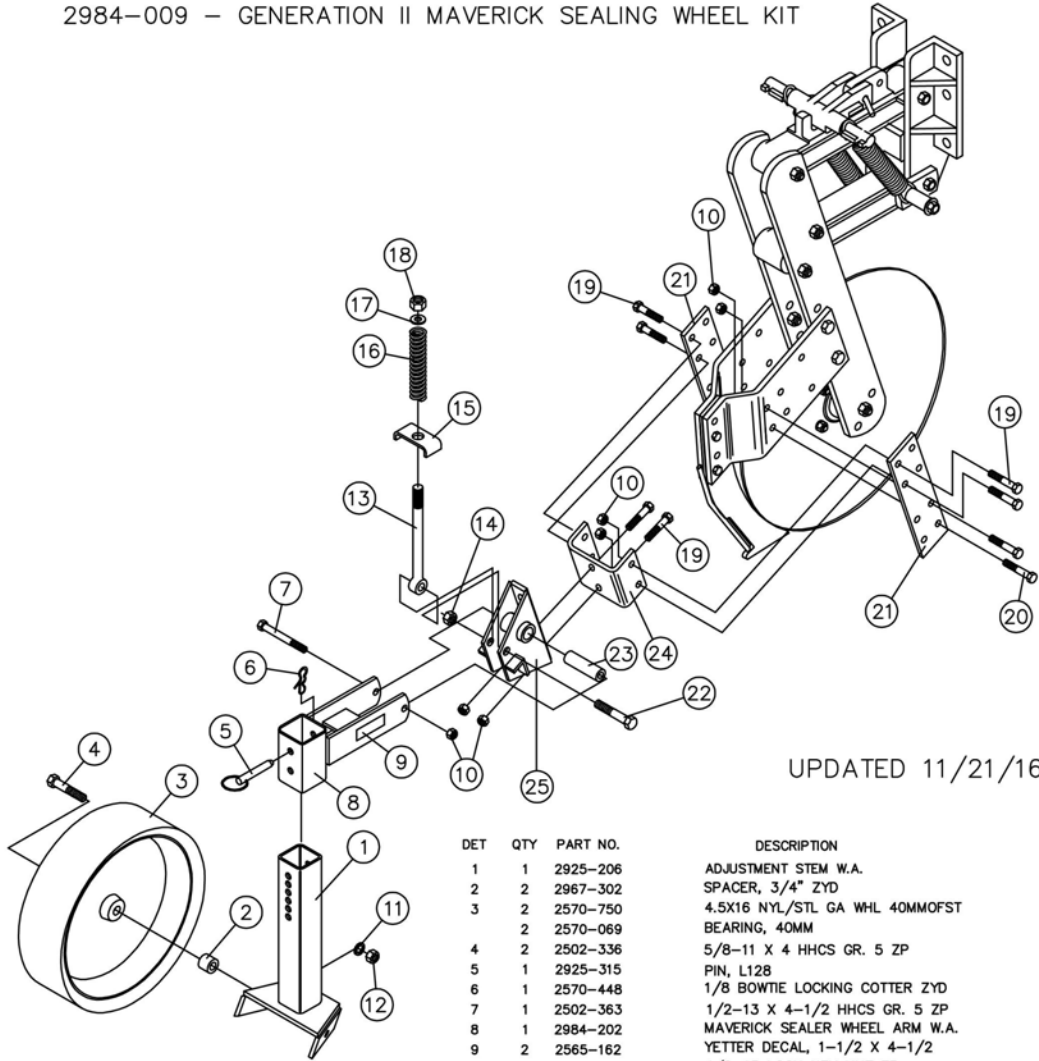

UPDATED 11/21/16

1647-8

DET	QTY	PART NO.	DESCRIPTION
1	1	2925-206	ADJUSTMENT STEM W.A.
2	2	2967-302	SPACER, 3/4" ZYD
3	2	2570-750	4.5X16 NYL/STL GA WHL 40MMOFST
	2	2570-069	BEARING, 40MM
4	2	2502-336	5/8-11 X 4 HHCS GR. 5 ZP
5	1	2925-315	PIN, L128
6	1	2570-448	1/8 BOWTIE LOCKING COTTER ZYD
7	1	2502-363	1/2-13 X 4-1/2 HHCS GR. 5 ZP
8	1	2984-202	MAVERICK SEALER WHEEL ARM W.A.
9	2	2565-162	YETTER DECAL, 1-1/2 X 4-1/2
10	11	2520-357	1/2-13 LOCK HEX NUT ZP
11	2	2525-451	5/8 MED LOCKWASHER ZP
12	2	2520-452	5/8-11 HEX NUT ZP
13	1	2920-324	PUSHROD, 9 3/16" EYEBOLT, ZP
14	1	2520-467	5/8-11 JAM HEX LOCK NUT ZP
15	1	2920-330	BRACKET, DISC SEALER SPRING
16	1	2920-350	COMPRESSION SPRING, SEALER
17	1	2975-302	2975 SPRING BUSHING "PAINTED"
18	1	2520-515	3/4-10 LOCK HEX NUT ZP
19	6	2502-293	1/2-13 X 1-1/4 HHCS GR. 5 ZP
20	4	2502-294	1/2-13 X 1-1/2 HHCS GR5 ZP
21	2	2984-324	SEALER MOUNT PLATE
22	1	2502-393	5/8-11 X 2-1/2 HHCS GR. 5 ZP
23	1	2920-342	INNER PIVOT BUSHING, ZYD
24	1	2984-323	DISC SEALER MOUNT PLATE, FORMED
25	1	2920-210	MOUNTING BRKT. W.A.

## PARTS IDENTIFICATION

### 3000-122 — PARALLEL ARM ASSEMBLY

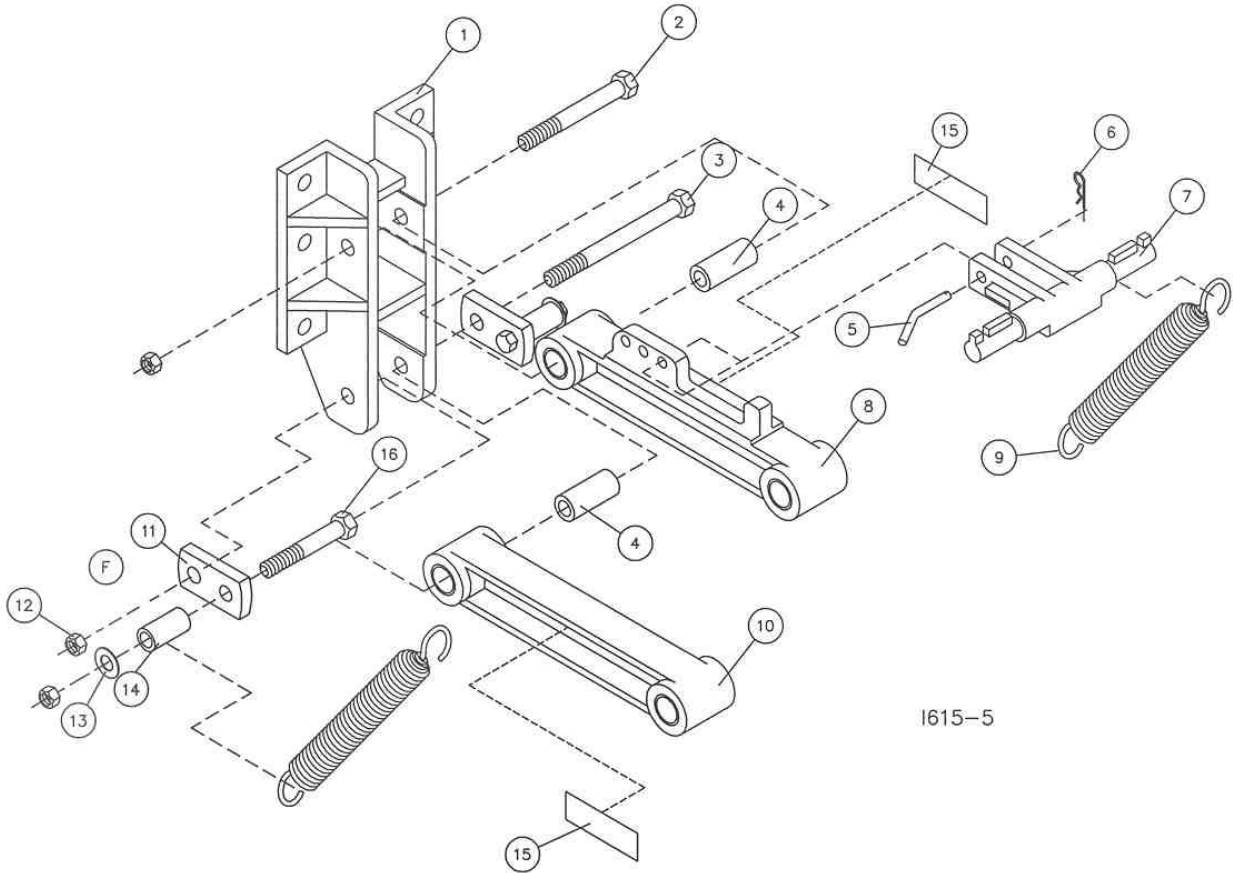

I615-5

DET	QTY	PART NO.	DESCRIPTION
1	1	3000-368	CLAMP BRACKET (MACHINED)
2	1	2502-510	3/4-10 X 6 HHCS GR. 5 ZYD
3	1	2502-509	3/4-10 X 7 HHCS GR. 5 ZYD
4	2	3000-393	PARALLEL ARM BUSHING (1 1/4OD X 3)
5	1	2965-305	PIN, FURROWING ATTACHMENT ZYD
6	1	2570-448	1/8 STD HAIRPIN COTTER
7	1	3000-367	UPPER SPRING BAR
8	1	3000-133	UPPER PARALLEL ARM ASSEMBLY
	2	2528-363	1 1/4IDX1 1/2ODX3 BRONZE BSHNG
9	2	2960-373	EXT. SPRING, 1-5/8 OD X .262 BLK
10	1	3000-134	LOWER PARALLEL ARM ASSEMBLY
	2	2528-363	1 1/4IDX1 1/2ODX3 BRONZE BSHNG
11	2	2984-304	SPRING ANCHOR TAB
12	4	2520-515	3/4-10 LOCK HEX NUT ZP
13	2	2526-504	3/4 SAE FLATWASHER
14	2	2984-305	SPACER, SPRING ANCHOR (1 1/8OD X 2 1/4)
15	2	2565-162	YETTER DECAL, 1-1/2 X 4-1/2
16	2	2502-404	3/4-10 X 4 HHCS GR 5 ZYD

# PARTS IDENTIFICATION

3000-131 PLATE SHIPPING ASSEMBLY

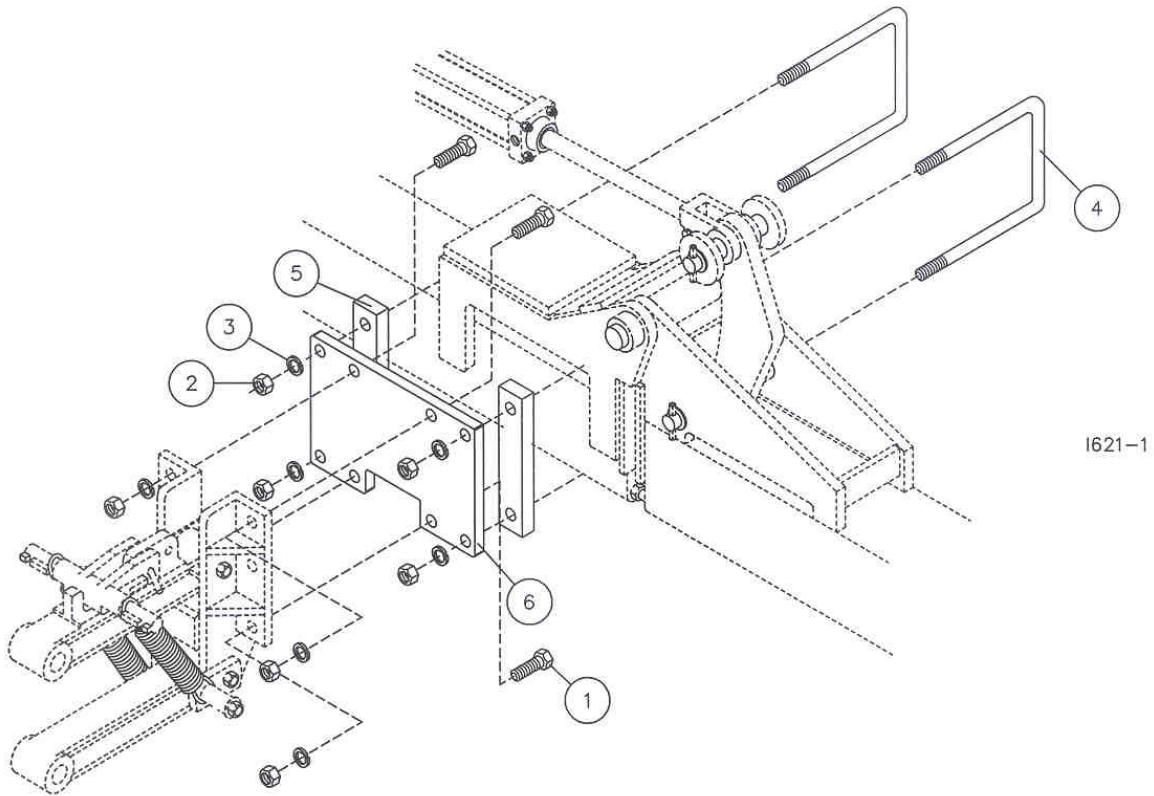

I621-1

KEY	QTY.	PART NO.	DESCRIPTION
1	4	2502-407	3/4-10 X 2-1/2" HHCS GR.5, ZP.
2	8	2520-504	3/4-10 HEX NUT, ZP.
3	8	2525-501	3/4 MED. LOCKWASHER, ZP.
4	2	2570-484	3/4 X 7 X 10 U-BOLT, ZP.
5	2	6001-477	1" SPACER, 7" BAR
6	1	3000-394	MOUNTING PLATE

## TROUBLESHOOTING

Problem	Cause	Solution
Poor overall performance	Toolbar not adjusted correctly	Adjust the toolbar so that during operation it is level and at a height of 21" – 24" from the bottom of the toolbar to the soil surface.
	Unit is not set correctly	See page 34 for proper opener adjustments
Toolbar height too high	Too much down pressure spring tension	Remove two outer springs & set in light pressure setting
	Toolbar gauge wheels adjusted too low	Raise gauge wheels
Shallow knife penetration	Speed too slow	Operate at 5mph min.
	Toolbar height too high	Must have toolbar operating at 21" – 24" above the soil surface
	Insufficient down pressure	Set down pressure spring adjustment to the rear hole Inspect springs for breakage and/or wear Adjust toolbar height lower. Normally 21" – 24"
Disc Sealer blade & hub fall off	Washer not installed in the disc assembly.	See page 20 for proper assembly.
Disc Sealer not creating a mound or too small of a mound	Speed too slow	Operate at 5mph min.
	Blades are not set aggressively enough	Increase the angle of the front edge of blade to the row.
	Down pressure spring is loose	Tighten the coil spring by compressing; tighten the 3/4" hex nut onto the pushrod.
	Toolbar is not level-probably nose down	Level toolbar at a height of 21" – 24" from soil surface.
Wheel Sealer not creating a mound	Not designed to create a mound	The disc sealer option is recommended for mound building.
Wheel Sealer not closing the knife trench	Down pressure spring is loose	Tighten the coil spring by compressing; tighten the 3/4" hex nut onto the pushrod.

# NOTES

# NOTES

# NOTES

# Our name Is getting known

Just a few years ago, Yetter products were sold primarily to the Midwest only. Then we embarked on a program of expansion and moved into the East, the South, the West and now north into Canada. We're even getting orders from as far away as Australia and Africa.

So, when you buy Yetter products . . .you're buying a name that's recognized. A name that's known and respected. A name that's become a part of American agriculture and has become synonymous with quality and satisfaction in the field of conservation tillage.

Thank you.

**YETTER MANUFACTURING CO.**  
Colchester, IL 62326-0358 • 309/776-4111  
Toll Free 800/447-5777  
Fax 309/776-3222  
Website: [www.yetterco.com](http://www.yetterco.com)  
E-mail: [info@yetterco.com](mailto:info@yetterco.com)

2565-679\_REV\_B • 11/16