



*NARROW ROW  
SINGLE WHEEL  
RESIDUE MANAGER*

**YETTER MANUFACTURING CO.**  
*FOUNDED 1930*

Colchester, IL 62326-0358  
Toll free: 800/447-5777  
309/776-3222 (Fax)  
Website: [www.yetterco.com](http://www.yetterco.com)  
E-mail: [info@yetterco.com](mailto:info@yetterco.com)

**YETTER**

## FOREWORD

You've just joined an exclusive but rapidly growing club.

For our part, we want to welcome you to the group and thank you for buying a Yetter Product.

We hope your new Yetter products will help you achieve both increased productivity and increased efficiency so that you may generate more profit. This operator's manual has been designed into six major sections.

Foreword, Safety Precautions, assembly instructions, Operation, parts identification and troubleshooting.

Throughout the manual references may be made to left side and right side. These terms are used as viewed from the operator's seat facing the front of the tractor.

 This **SAFETY ALERT SYMBOL** indicates important safety messages in the manual. When you see this symbol, be alert to the possibility of **PERSONAL INJURY** and carefully read the message that follows.

The word **NOTE** is used to convey information that is out of context with the manual text. It contains special information such as specifications, techniques, reference information and other information of a supplementary nature.

The word **IMPORTANT** is used in the text when immediate damage will occur to the machine due to improper technique or operation. Important will apply to the same information as specified by note only of an immediate and urgent nature.

 It is the responsibility of the user to read the operator's manual and comply with the safe and correct operating procedure and to lubricate and maintain the product according to the maintenance schedule in the operator's manual.

The user is responsible for inspecting his machine and for having parts repaired or replaced when continued use of the product would cause damage or excessive wear to the other parts.

It is the user's responsibility to deliver his machine to the Yetter dealer who sold him the product for service or replacement of defective parts that are covered by the warranty policy.

If you are unable to understand or follow the instructions provided in the publication, consult you local Yetter dealer or contact:

**YETTER MANUFACTURING CO.**  
309/776-4111  
800/447-5777  
309/776-3222 (FAX)  
Website: [www.yetterco.com](http://www.yetterco.com)  
E-mail: [info@yetterco.com](mailto:info@yetterco.com)

### WARRANTY POLICY

Yetter Manufacturing warrants all products manufactured and sold by it against defects in material. This warranty being expressly limited to replacement at the factory of such parts or products as will appear to be defective after inspection. This warranty does not obligate the Company to bear cost of labor in replacement of parts. It is the policy of the company to make improvements without incurring obligations to add them to any unit already sold. No warranty is made or authorized to be made, other than herein set forth. This warranty is in effect for one year after purchase.

DEALER \_\_\_\_\_

Yetter Manufacturing warrants its own products only and cannot be responsible for damage to equipment on which mounted.

# SAFETY

**A brief description of signal words that may be used in this manual:**

**CAUTION:** Used as a general reminder of good safety practices or to direct attention to unsafe practices.

**WARNING:** Denotes a specific potential hazard.

**DANGER:** Denotes the most serious specific potential hazard.

## SAFETY PRECAUTIONS

You can make your farm a safer place to live and work if you observe the safety precautions given. Study these precautions carefully and insist that they be followed by those working with you and for you.



### WARNING

Never clean, lubricate or adjust a machine that is in motion. Always lower or block the implement before performing service.

If machine must be serviced in the raised position, jack or block it up to prevent it from accidentally falling and injuring someone.

Do not allow riders on the tractor or implement.

Use speeds and caution dictated by the terrain being traversed. Do not operate on any slope steep enough to cause tipping or loss of control.

Be sure all personnel are clear of the immediate area before operating.

Read and understand the operator's manual and require all other persons who will operate the equipment to do the same.

Be familiar with all tractor and implement controls and be prepared to stop engine and implements quickly in an emergency.



### CAUTION

Consult your implement and tractor operator's manual for correct and safe operating practices.

Beware of towed implement width and allow safe clearance.

**FAILURE TO HEED MAY RESULT IN PERSONEL INJURY OR DEATH.**

## **INSTALLATION**

1. Before assembling the spoked wheels, remove the seal from the exposed side of the bearing in the hub and bearing assembly if you wish to use the zerk to grease the bearing. If you do not remove the seal the bearing is sealed and cannot be greased through the zerk.
2. If you remove the seal, fill the bearings and hubs with general purpose grease before completing the assembly.
3. When assembling the spoked wheels, be sure to align the grease fitting hole with the hole or slot in the spoke wheels and the groove in the hub cap to assure proper greasing of the entire bearing and hub assembly.
4. When assembling the spoke wheels be sure to assemble an equal number of left hand and right hand assemblies. Left hand and right hand are determined by where the bearing is located in relation to the bevel on the spoke wheel. For proper operation the bevel must always lead as shown in the illustration.

## **MAINTENANCE**

After a few hours of use, check all bolts to make sure they are tight.

To ensure longevity and reliability of the product, grease each hub and bearing assembly every 50 hours of use.

# MAINTENANCE

## BEARING ASSEMBLY AND LUBRICATION

### Practice Safety

Understand and practice safe service procedures before doing work. Follow ALL the operating, maintenance and safety information in the equipment operator manual. Clear the area of bystanders, especially small children, when performing any maintenance or adjustments. Keep work area clean and dry. Use adequate lighting for the job. Use only tools, jacks and hoists of sufficient capacity for the job.

Never lubricate, service, or adjust machine while it is moving. Keep hands, feet, and clothing from power-driven moving and rotating parts. Disengage all power and operate controls to relieve pressure. Lower equipment to the ground and stop the engine. Remove the key. Wait for all moving parts to stop before servicing, adjusting, repairing or unplugging.

Securely support any machine elements with blocks or safety stands that must be raised for service work.

Keep all parts in good condition and properly installed. Fix damaged equipment immediately. Replace worn or broken parts. Remove any buildup of grease, oil, or debris. Make sure all guards are in place and properly secured when maintenance work is completed.

### Assembly

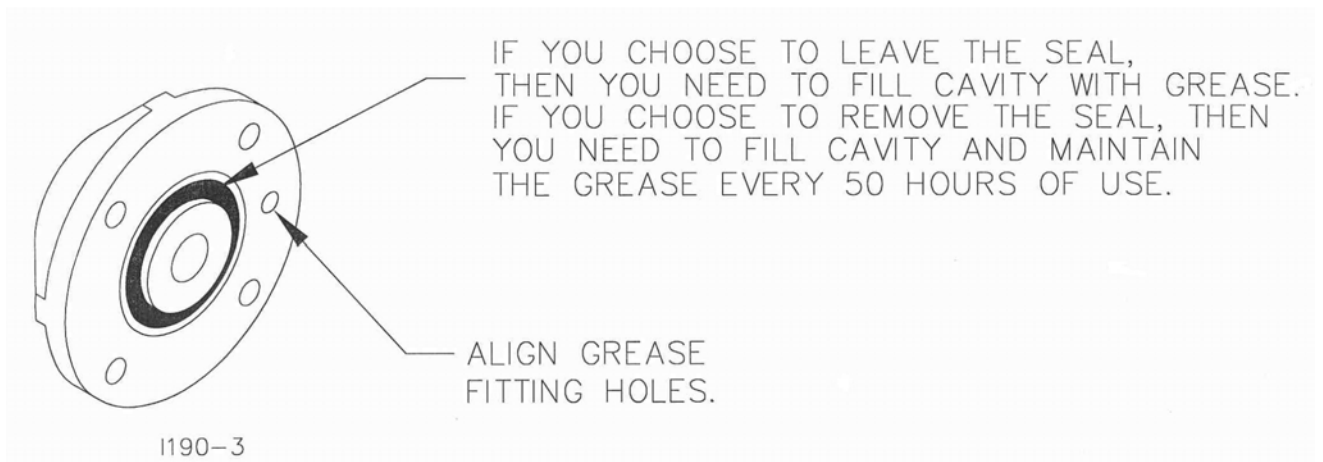

## MAINTENANCE

ALIGN THE HUB CAP GROOVE,  
WITH THE WHEEL SLOT AND  
GREASE FITTING

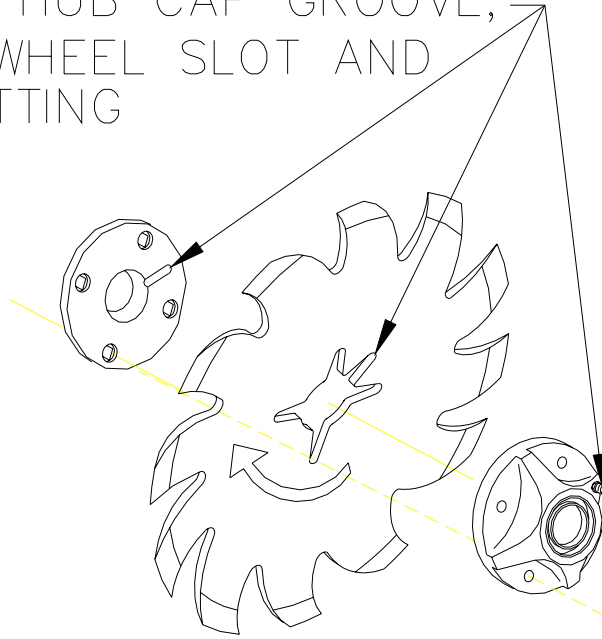

**NOTE:** Be certain to align the grease fitting with the slot in the wheel and the hubcap so that the grease can flow freely.

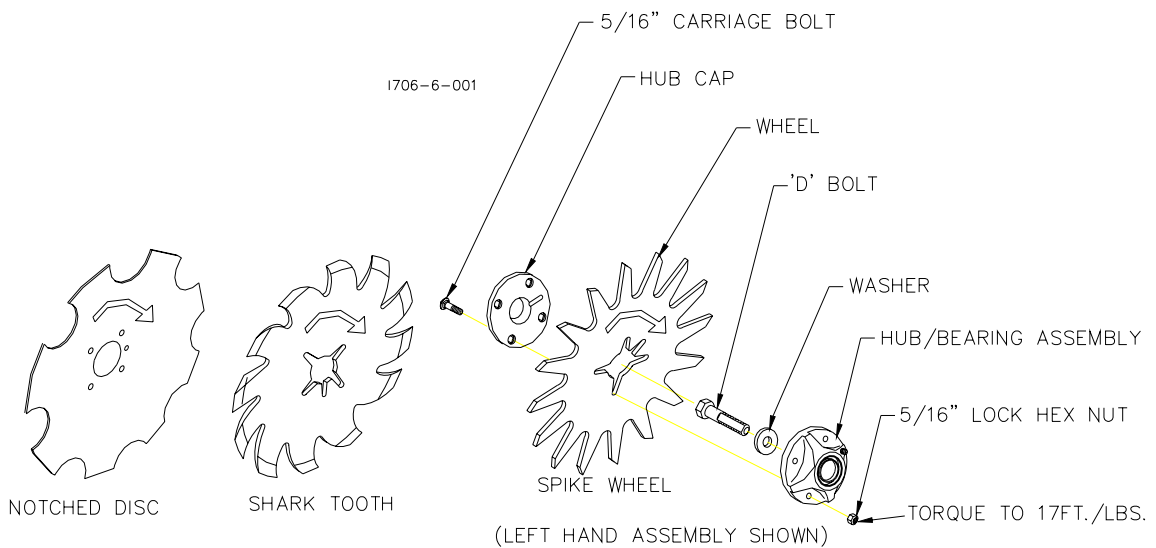

**IMPORTANT:** THE 2527-530 WASHER MUST BE INSTALLED OR THE WHEEL AND HUB ASSEMBLY WILL FALL OFF DURING USE.

# MAINTENANCE

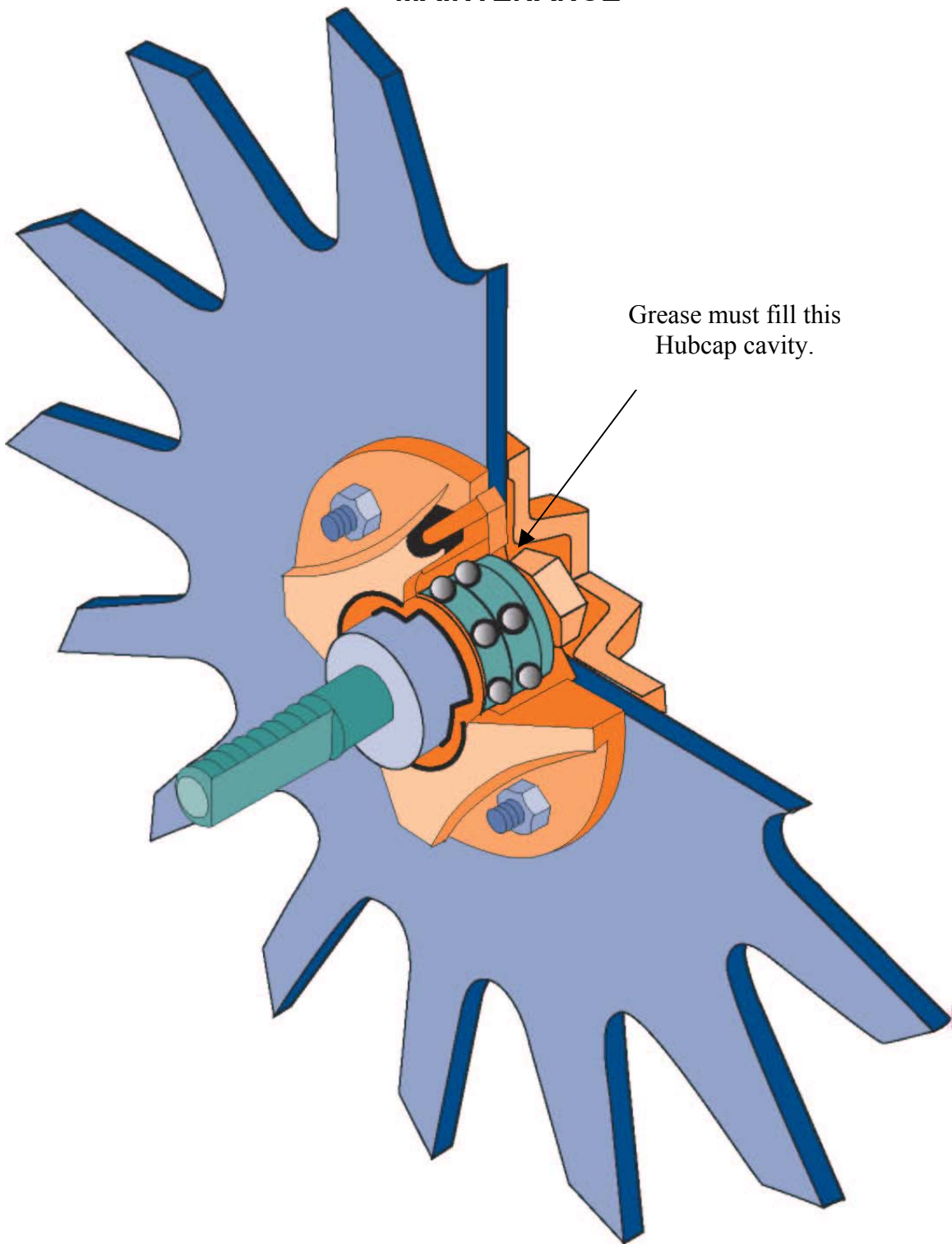

## MAINTENANCE

### Lubrication



**CAUTION:** To help prevent serious injury or death to you or others caused by unexpected movement, service machine on a level surface. Lower machine to ground or sufficiently lock or block raised machine before servicing. If machine is connected to tractor, engage parking brake and place transmission in "PARK", shut off engine and remove key. If machine is detached from tractor, block wheels and use shop stands to prevent movement.



**CAUTION:** Do not clean, lubricate, or adjust machine while in motion.

Use grease based on NLGI consistency numbers and the expected air temperature range during the service interval.

Use a **multi-purpose lithium, water resistant, moderate speed, and NLGI grade #2** grease.

Other greases may be used if they meet the following **NLGI Performance Classification: GC-LB**

**IMPORTANT:** Some types of grease thickener are not compatible with others. Consult your grease supplier before mixing different types of grease.

#### Alternative Lubricants

Conditions in certain geographical areas may require special lubricants and lubrication practices which do not appear in the operator's manual. If there are any questions, consult Yetter Manufacturing Co. to obtain latest information and recommendation.

PART #	DESCRIPTION	OUNCES OF GREASE
2967-404	13" TAPER TOOTH R.M. WHEEL	1.12 OZ
2967-602	13" SHARK TOOTH R.M. WHEEL	1.12 OZ
2967-186	FLOATER WHEEL KIT W/R.M. WHEEL	2.08 OZ
2967-596	HEAVY DUTY OR BEVEL R.M. WHEEL W/ FLOATER WHEEL KIT	2.40 OZ

#### Storing Lubricants

Your machine can operate at top efficiency only if clean lubricants are used.

Use clean containers to handle all lubricants.

Store them in an area protected from dust, moisture and other contaminants.



## MAINTENANCE Lubrication Symbols

 Lubricate with grease at hourly interval indicated on symbol.

### Lubrication Intervals

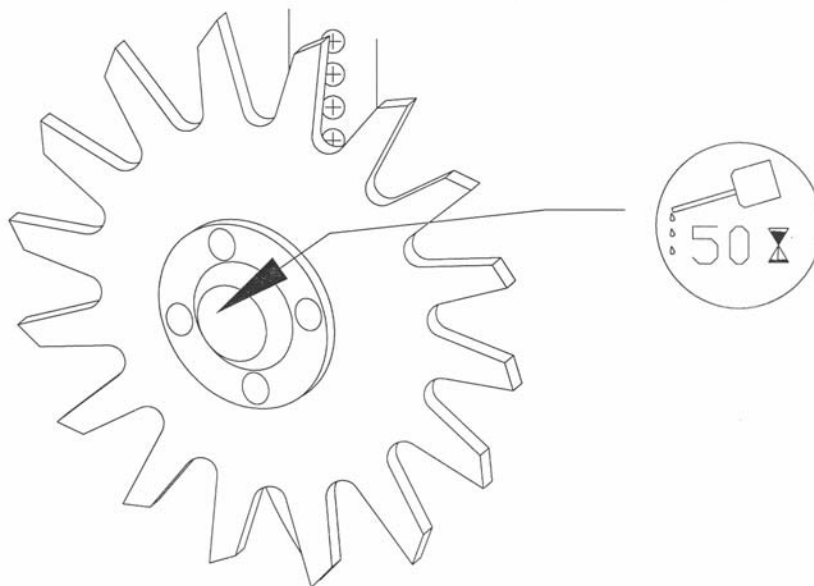

S422-7

**IMPORTANT: The recommended service intervals are based on normal conditions; severe or unusual conditions may require more frequent lubrication.**

Perform each lubrication and service procedure at the beginning and end of each season.

Clean grease fittings before using grease gun, to avoid injecting dirt and grit into the bearing. Replace any lost or broken fittings immediately. If a fitting fails to take grease, remove and clean thoroughly, replace fitting if necessary. Also check for failure of adjoining parts.

## BEARING REPLACEMENT INSTALLATION

1. If you wish to be able to grease the bearings in the hubs, remove the seal from one side of the bearings as illustrated before assembly. Otherwise the bearings may be left "sealed for life".
2. When assembling the spoke wheels, bearing assembly and hubcap, be sure to align the grease transfer hole in the spoke wheel with the groove in the hubcap and hole in the hub to allow grease passage.
3. Install/assemble the wheels, hubs and caps. **IMPORTANT: THE 2527-530 WASHER MUST BE INSTALLED OR THE WHEEL AND HUB ASSEMBLY WILL FALL OFF DURING USE.**
4. Grease the wheel/hub/bearing assembly.

# MAINTENANCE

## Storing the Equipment

Store the machine in an area away from human activity

Store machine in RAISED position.

Install service locks on all wheel cylinders.

At the end of the season, the machine should be thoroughly inspected and prepared for storage. Repair or replace any worn or damaged components to prevent down time at the start of the next season. Store machine under cover with all parts in operating condition.

- Clean machine thoroughly to remove all dirt, debris and crop residue, which would hold moisture and cause rusting.
- Inspect machine for worn or broken parts. See your Yetter Farm Equipment dealer during the off-season so that parts or service can be acquired when machine is not needed in the field.
- Lubricate bearings as outlined in the Lubrication section
- Paint all parts which are chipped or worn and require repainting.
- Store machine in a clean, dry place with the planting unit out of the sun.
- If the machine cannot be stored inside, cover with a waterproof tarpaulin and tie securely in place.
- Do not allow children to play on or around the machine

## PARTS IDENTIFICATION

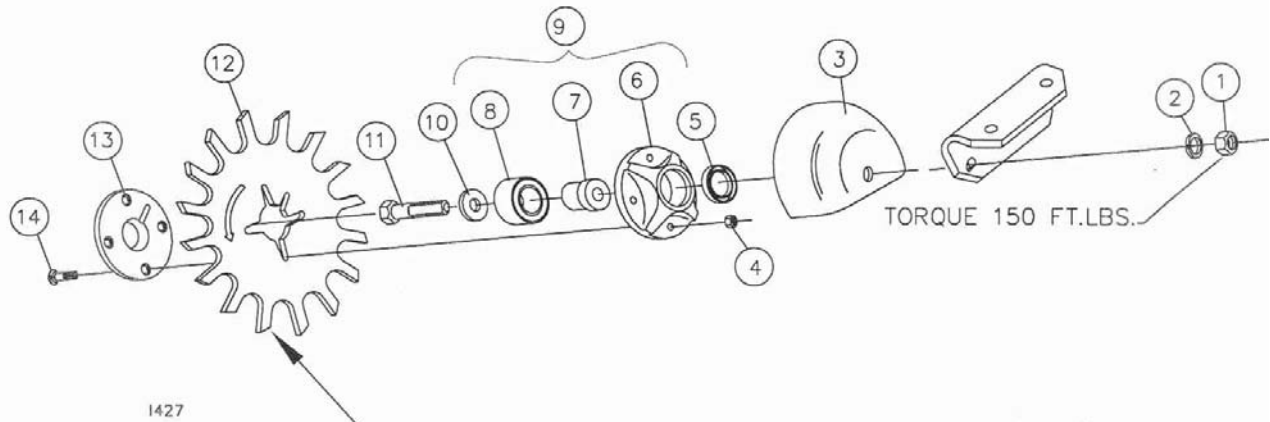

NOTE: DIRECTION OF WHEEL ROTATION  
BEVELS LEADING

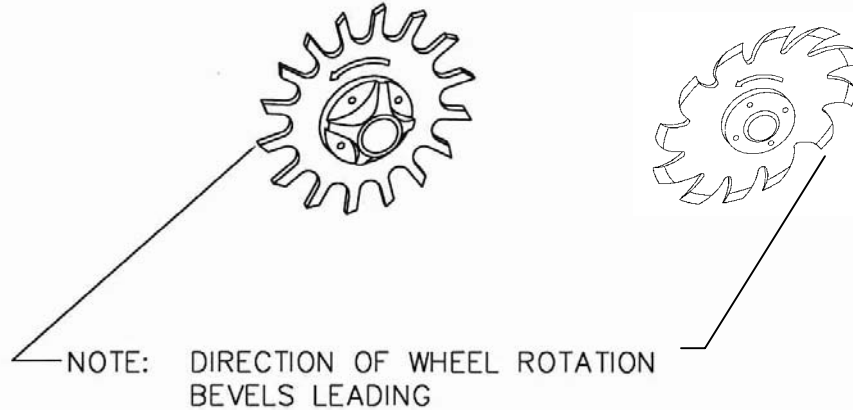

NOTE: DIRECTION OF WHEEL ROTATION  
BEVELS LEADING

### 2967 SERIES RESIDUE MANAGER ASSEMBLY

KEY	QTY	PART NO.	DESCRIPTION
1	1	2520-452	5/8-11 Hex Nut ZP
2	1	2525-451	5/8 Med. Lockwasher ZP
3	1	2967-392	Shield, RM Combo Painted
4	4	2520-205	5/16-18 Lock Hex Nut ZP
5	1	2550-052	Seal
6	1	2965-351	Hub Casting, Machined
7	1	2570-715	Bearing Insert, Trashmaster
8	1	2570-594	Bearing, 2 Row
9	1	2965-128	Hub & Bearing Assembly, 4 Bolt
10	1	2527-530	1-1/2 O.D. X 21/32 I.D. X 3/16 Thk. Mach. Bushing
11	1	2570-740	5/8-11 X 3" "D" Bolt
12	1	2967-404	13" Taper Tooth Spoke Wheel
	1	2967-596	13" X 3/8" Taper Tooth Spoke Wheel
	1	2967-602	13" Shark Tooth Wheel
13	1	2965-353	Hub Cap Casting, 4 Bolt, Black
14	4	2505-208	18 X 1-1/2" Car. Blt. GR. 5 ZP

# PARTS IDENTIFICATION

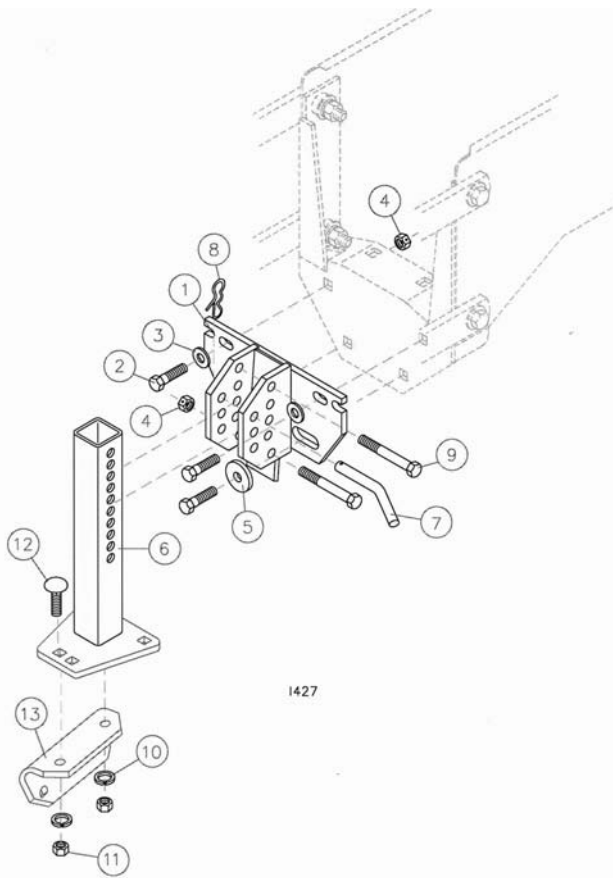

## 2967-017

**FITS: YETTER, J.D. 7000, 7200,  
KINZE, NEW IDEA, WHITE 6100**

KEY	QTY	PART NO.	DESCRIPTION
1	1	2967-211	Mounting Bracket, Trimmed W.A.
2	3	2502-294	1/2-13 X 1-1/2" HHCS GR 5 ZP
3	2	2526-355	1/2" Flatwasher, Hardened
4	5	2520-357	1/2-13 Lock Hex Nut ZP
5	1	2526-402	9/16 I.D. X 1-3/4 O.D. X 1/4" M.B. ZP
6	1	2967-234	Single Wheel Arm W.A.
7	1	2965-305	Pin, Furrowing Attachment ZP
8	1	2570-448	1/8" STD. Hairpin Cotter ZP
9	2	2502-316	1/2-13 X 3-1/2" HHCS GR 5 ZP
10	2	2525-352	1/2 Medium Lockwasher LP
11	2	2520-352	1/2-13 Hex Nut ZP
12	2	2505-339	1/2-13 X 1-1/2 Car. Blt. GR 5 ZP
13	1	2967-405	Wheel Mount

(Illustrations show Right hand assemblies-Reverse #13 for Left hand assemblies)

1427

## 2967-018

**FITS: CASE IH 800/900  
CYCLO PLANTER**

KEY	QTY	PART NO.	DESCRIPTION
1	1	2965-203	Furrower Mounting Bracket, 800
2	2	2520-357	1/2-13 Lock Hex Nut ZP
3	2	2526-355	1/2 Flatwasher Hardened ZP
4	2	2502-315	1/2-13 X 3-1/2" HHCS GR 5 ZP
5	1	2967-234	Single Wheel Arm W.A.
6	1	2570-448	1/2" STD. Hairpin Cotter ZP
7	2	2525-352	1/2 Medium Lockwasher ZP
8	2	2505-339	1/2-13 X 1-1/2 Car. Clt. GR 5 ZP
9	1	2967-405	Wheel Mount
10	2	2520-352	1/2-13 Hex Nut ZP

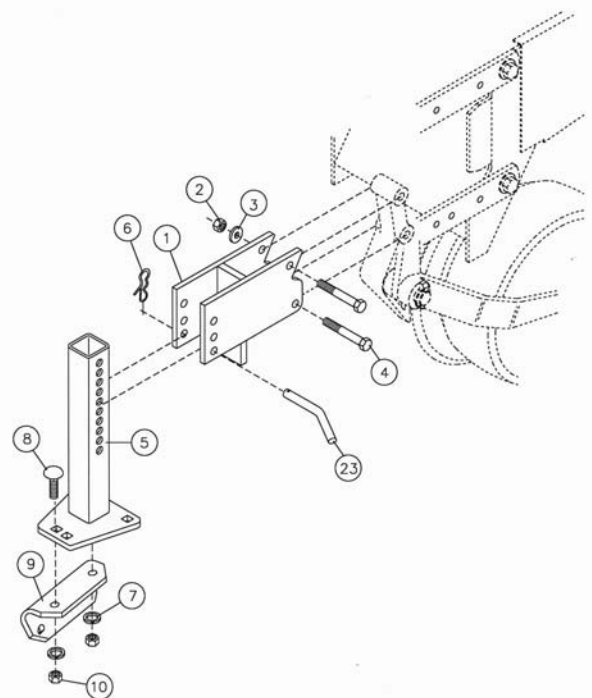

1428

# PARTS IDENTIFICATION

## 2967-019 SINGLE WHEEL R.M. – MONOSEM BRKT

DET.	QTY.	PART NO.	DESCRIPTION
1	3	2520-251	3/8-16 HEX NUT ZP
2	3	2525-251	3/8 MED. LOCKWASHER ZP
3	1	2570-448	.120 BOWTIE LOCKING COTTER
4	1	2967-245	MONOSEM MOUNT BRACKET W.A.
5	3	2502-245	3/8-16 X 1-3/4 HHCS GR 5 ZP
6	1	2965-305	PIN, FURROWING ATTACHMENT ZP
7	1	2967-234	SINGLE WHEEL ARM WA
8	7	2505-339	1/2-13 X 1-1/2 CAR BLT GR 5
9	1	2967-405	WHEEL MOUNT
10	2	2525-352	1/2 MED LOCKWASHER ZP
11	2	2520-352	1/2-13 HEX NUT ZP
12	1	2520-452	5/8-11 HEX NUT ZP
13	1	2525-451	5/8 MED LOCKWASHER ZP
14	1	2967-392	SHEILD, RM COMBO-PAINTED
15	1	2965-128	HUB AND BEARING ASS'Y., 4 BOLT
16	1	2570-594	BEARING, 2 ROW NTN# DF0654L
17	1	2570-715	BEARING INSERT, TRASHMASTER
18	1	2965-351	HUB CAST., MACHINED, 4 BOLT
19	1	2550-052	SEAL, CR# 13548
20	4	2520-205	5/16-18 LOCK HEX NUT ZP
21	1	2527-530	1.50D X 21/32ID 3/16TK MA B
22	1	2570-740	5/8-11 X 3" 'D' BOLT GR 5 ZP
23	1	2967-404	13" TAPER TOOTH SPOKE WHEEL
24	1	2965-352	HUB CAP CASTING, 4 BOLT, BL
25	4	2505-208	5/16-18 X 1-1/2 CAR BLT GR5

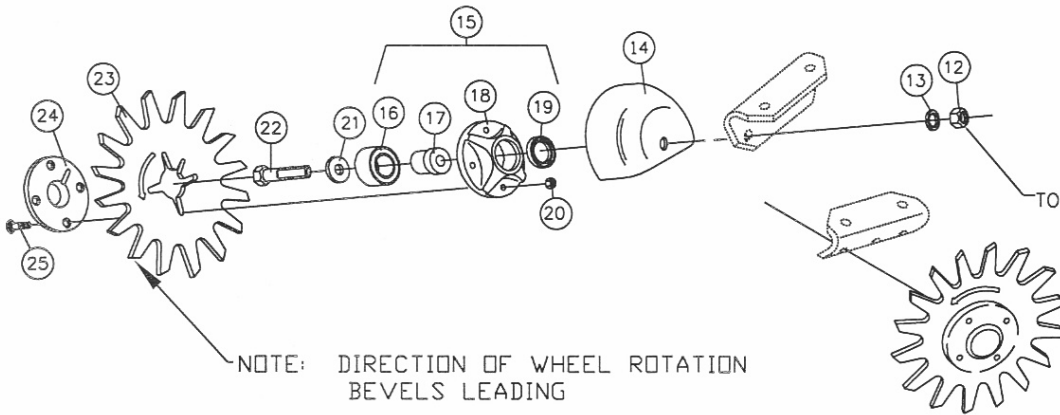
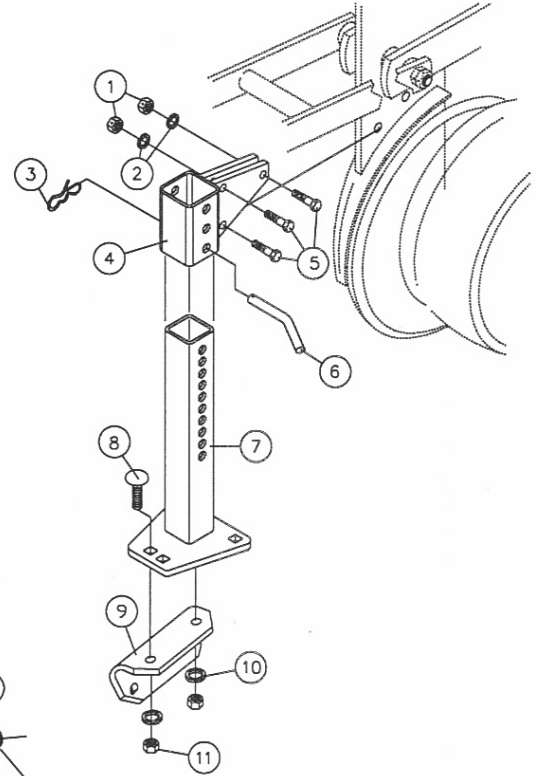

TORQUE 150 FT.LBS.

I757

UPDATED 03/12/09

# TROUBLESHOOTING

PROBLEM	CAUSE	SOLUTION
Overall settings	Planter not set correctly	Ensure that in operation the planter frame is at correct height (20" 22") and level the tool bar.
Cannot set shallow enough	Planter not set correctly	See above
Spoke wheels not turning continuously	Spoke wheels not engaging residue.	Lower wheels to ensure rotation at all times, <b>DO NOT</b> engage solid part of wheel in dirt.
Residue wheel continuously plugs with trash.	Wheel not mounted correctly	Verify direction of bevel
Damage to Residue Manager or Planting Unit.	Speed too fast	Verify speed setting.
	Speed too slow	Verify speed setting.

## NOTES:

# Our name Is getting known

Just a few years ago, Yetter products were sold primarily to the Midwest only. Then we embarked on a program of expansion and moved into the East, the South, the West and now north into Canada. We're even getting orders from as far away as Australia and Africa.

So, when you buy Yetter products . . .you're buying a name that's recognized. A name that's known and respected. A name that's become a part of American agriculture and has become synonymous with quality and satisfaction in the field of conservation tillage.

Thank you.

**YETTER MANUFACTURING CO.**

Colchester, IL 62326-0358 ☎ 309/776-4111

Toll Free 800/447-5777

Fax 309/776-3222

Website: [www.yetterco.com](http://www.yetterco.com)

E-mail: [info@yetterco.com](mailto:info@yetterco.com)

2565-399\_REV\_A ☎ 03/09