



**FLOATING RESIDUE MANAGER**  
**INSTRUCTION MANUAL**  
**PARTS IDENTIFICATION**  
2565-415\_REV\_A – UPDATED 03/09

**YETTER MANUFACTURING CO.**  
*FOUNDED 1930*  
Colchester, IL 62326-0358  
Toll free: 800/447-5777  
309/776-3222 (Fax)  
Website: [www.yetterco.com](http://www.yetterco.com)  
E-mail: [info@yetterco.com](mailto:info@yetterco.com)

**YETTER**

## FOREWORD

You've just joined an exclusive but rapidly growing club.

For our part, we want to welcome you to the group and thank you for buying a Yetter product.

We hope your new Yetter products will help you achieve both goals-increase your productivity and increase your efficiency so that you may generate more profit.

This operator's manual has been designed into four major sections: Foreword, Safety Precautions, Installation Instructions and Parts Breakdown.



This **SAFETY ALERT SYMBOL** indicates important safety messages in the manual. When you see this symbol, be alert to the possibility of **PERSONAL INJURY** and carefully read the message that follows.

The word **NOTE** is used to convey information that is out of context with the manual text. It contains special information such as specifications, techniques and reference information of a supplementary nature.

The word **IMPORTANT** is used in the text when immediate damage will occur to the machine due to improper technique or operation. Important will apply to the same information as specified by note

only of an immediate and urgent nature.

It is the responsibility of the user to read the operator's manual and comply with the safe and correct operating procedure and to lubricate and maintain the product according to the maintenance schedule in the operator's manual.

The user is responsible for inspecting his machine and for having parts repaired or replaced when continued use of the product would cause damage or excessive wear to the other parts.

It is the user's responsibility to deliver his machine to the Yetter dealer who sold him the product for service or replacement of defective parts, which are covered by the warranty policy.

If you are unable to understand or follow the instructions provided in this publication, consult your local Yetter dealer or contact:

### YETTER MANUFACTURING CO.

309/776-4111

800/447-5777

309/776-3222 (FAX)

Website: [www.yetterco.com](http://www.yetterco.com)

E-mail: [info@yetterco.com](mailto:info@yetterco.com)

## WARRANTY

Yetter Manufacturing warrants all products manufactured and sold by it against defects in material. This warranty being expressly limited to replacement at the factory of such parts or products as shall appear to be defective after inspection. This warranty does not obligate the Company to bear cost of labor in replacement of parts. It is the policy of the Company to make improvements without incurring obligations to add them to any unit already sold. No warranty is made or authorized to be made, other than herein set forth. This warranty is in effect for one year after purchase.

Dealer \_\_\_\_\_

Yetter Manufacturing warrants its own products only and cannot be responsible for damages to equipment on which mounted.

## **SAFETY**

### **A brief description of signal words that may be used in this manual:**

**CAUTION:** Used as a general reminder of good safety practices or to direct attention to unsafe practices.

**WARNING:** Denotes a specific potential hazard.

**DANGER:** Denotes the most serious specific potential hazard.

## **SAFETY PRECAUTIONS**

You can make your farm a safer place to live and work if you observe the safety precautions given. Study these precautions carefully and insist that they be followed by those working with you and for you.

Finally, remember this: an accident is usually caused by someone's carelessness, neglect or oversight.



### **WARNING**

Never clean, lubricate or adjust a machine that is in motion. Always lower or block the implement before performing service.

If machine must be serviced in the raised position, jack or block it up to prevent it from accidentally falling and injuring someone.

Do not allow riders on the tractor or implement.

Use speeds and caution dictated by the terrain being traversed. Do not operate on any slope steep enough to cause tipping or loss of control.

Be sure all personnel are clear of the immediate area before operating.

Read and understand the operator's manual and require all others persons who will operate the equipment to do the same.

Be familiar with all tractor and implement controls and be prepared to stop engine and implements quickly in an emergency.



### **CAUTION**

Consult your implement and tractor operator's manual for correct and safe operating practices.

Beware of towed implement width and allow safe clearance.

**FAILURE TO HEED MAY RESULT IN PERSONAL INJURY OR DEATH.**

## ASSEMBLY

### 2910/2995/2996 MOUNTING BRACKET

1. Remove 3/8 x 2-1/2" roll pin from end of 1-1/2" diameter shank and remove coultter.
2. 2910 Coultter-Bolt the top mount plate to the third set of holes in the mounting bracket with two 1/2 x 1-1/2" bolts, lockwashers and nuts.  
  
2995/2996 Coultter-Bolt the top mount plate to the second set of holes in the mounting bracket with two 1/2 x 1-1/2" bolts, lockwashers and hex nuts.
3. Slide bracket over pivot casting, reinstall coultter on shank and reinsert roll pin.
4. Install and tighten 5/8" setscrew in lock collar to 110 ft./lb. torque maximum.
5. Attach floating residue manager stem to mounting bracket with two 1/2 x 3-1/2" bolts and lock hex nuts at desired height.
6. Assemble spoke wheels (2 per row) and attach to floating residue manager stem.

### SPOKE WHEEL ASSEMBLY

1. Before assembling spoke wheel, bearing assembly and hub cap, remove the seal from the exposed side of the bearing in the hub and bearing assembly if you wish touse the zerk to grease the bearing, otherwise the bearing is sealed.
2. When assembling spoke wheel, bearing assembly and hub cap, be sure to align the grease fitting hole with the hole in the spoke wheel and the groove in hub cap to assure proper greasing of wheel and hub assembly.
3. Assemble spoke wheel, bearing assembly and hub cap as shown on the parts identification page. Be sure to install the 11/16" spacers and bearing shields. Stagger spoke wheels so that half of the rows have a left wheel leading and half of the rows have a right wheel leading. Torque 150 ft.lbs.
4. Fill hub and bearing with general purpose grease if seal was removed from bearing in step 1.

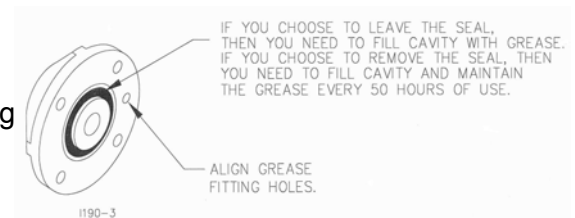

# MAINTENANCE

## BEARING ASSEMBLY AND LUBRICATION

### Practice Safety

Understand and practice safe service procedures before doing work. Follow ALL the operating, maintenance and safety information in the equipment operator manual. Clear the area of bystanders, especially small children, when performing any maintenance or adjustments. Keep work area clean and dry. Use adequate lighting for the job. Use only tools, jacks and hoists of sufficient capacity for the job.

Never lubricate, service, or adjust machine while it is moving. Keep hands, feet, and clothing from power-driven moving and rotating parts. Disengage all power and operate controls to relieve pressure. Lower equipment to the ground and stop the engine. Remove the key. Wait for all moving parts to stop before servicing, adjusting, repairing or unplugging.

Securely support any machine elements with blocks or safety stands that must be raised for service work.

Keep all parts in good condition and properly installed. Fix damaged equipment immediately. Replace worn or broken parts. Remove any buildup of grease, oil, or debris.

Make sure all guards are in place and properly secured when maintenance work is completed.

### Assembly

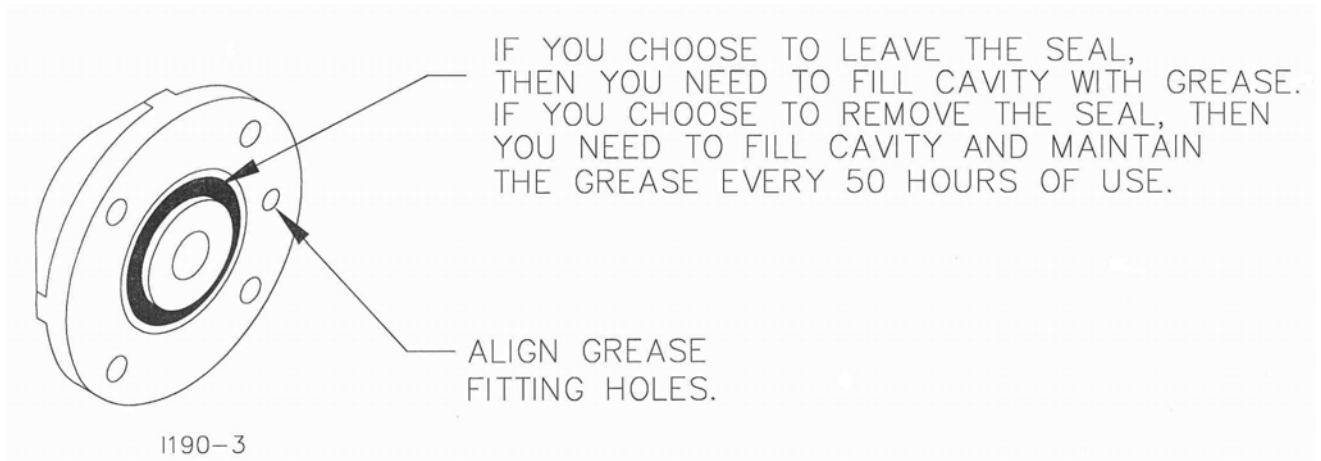

## MAINTENANCE

ALIGN THE HUB CAP GROOVE,  
WITH THE WHEEL SLOT AND  
GREASE FITTING

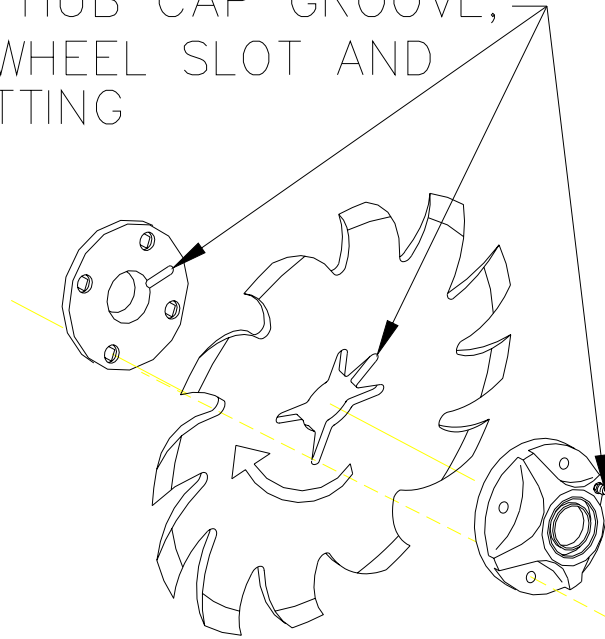

**NOTE:** Be certain to align the grease fitting with the slot in the wheel and the hubcap so that the grease can flow freely.

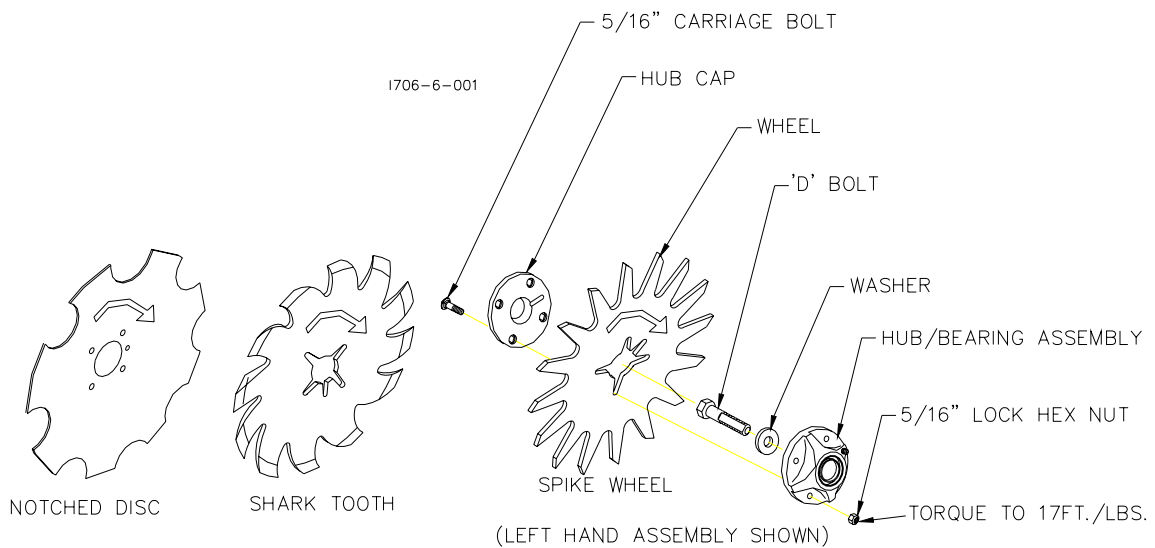

**IMPORTANT:** THE 2527-530 WASHER MUST BE INSTALLED OR THE WHEEL AND HUB ASSEMBLY WILL FALL OFF DURING USE.

# MAINTENANCE

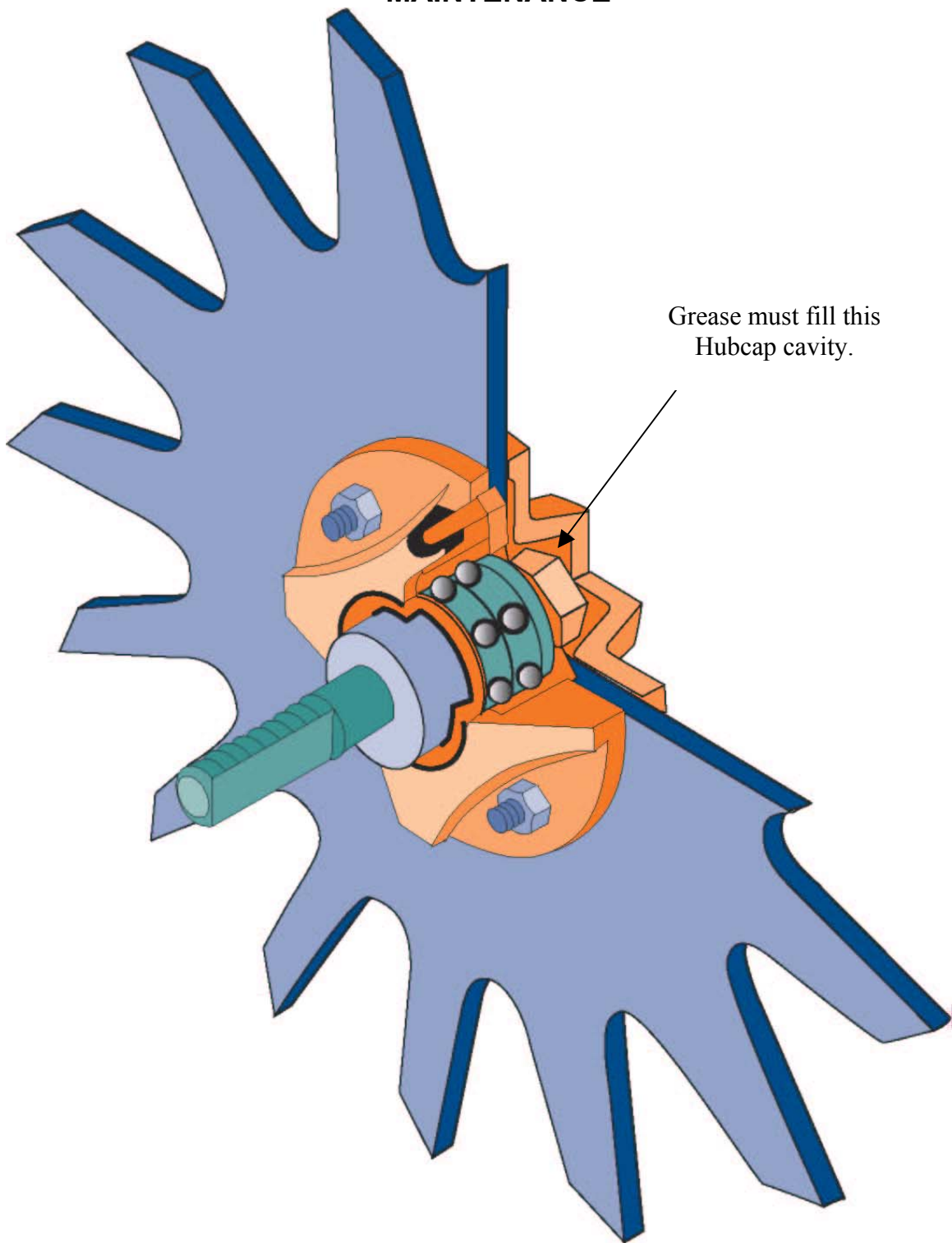

## MAINTENANCE

### Lubrication



**CAUTION:** To help prevent serious injury or death to you or others caused by unexpected movement, service machine on a level surface. Lower machine to ground or sufficiently lock or block raised machine before servicing. If machine is connected to tractor, engage parking brake and place transmission in "PARK", shut off engine and remove key. If machine is detached from tractor, block wheels and use shop stands to prevent movement.



**CAUTION:** Do not clean, lubricate, or adjust machine while in motion.

Use grease based on NLGI consistency numbers and the expected air temperature range during the service interval.

Use a **multi-purpose lithium, water resistant, moderate speed, and NLGI grade #2** grease.

Other greases may be used if they meet the following **NLGI Performance Classification: GC-LB**

**IMPORTANT:** Some types of grease thickener are not compatible with others.

**Consult your grease supplier before mixing different types of grease.**

#### Alternative Lubricants

Conditions in certain geographical areas may require special lubricants and lubrication practices which do not appear in the operator's manual. If there are any questions, consult Yetter Manufacturing Co. to obtain latest information and recommendation.

PART #	DESCRIPTION	OUNCES OF GREASE
2967-404	13" TAPER TOOTH R.M. WHEEL	1.12 OZ
2967-602	13" SHARK TOOTH R.M. WHEEL	1.12 OZ
2967-186	FLOATER WHEEL KIT W/R.M. WHEEL	2.08 OZ
2967-596	HEAVY DUTY OR BEVEL R.M. WHEEL W/ FLOATER WHEEL KIT	2.40 OZ

#### Storing Lubricants

Your machine can operate at top efficiency only if clean lubricants are used.

Use clean containers to handle all lubricants.

Store them in an area protected from dust, moisture and other contaminants.



# MAINTENANCE

## Lubrication Symbols



Lubricate with grease at hourly interval indicated on symbol.

## Lubrication Intervals

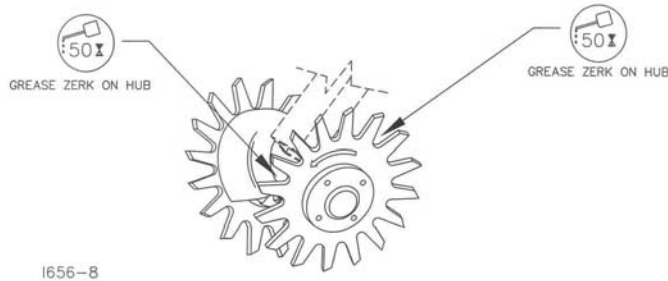

**IMPORTANT: The recommended service intervals are based on normal conditions; severe or unusual conditions may require more frequent lubrication.**

Perform each lubrication and service procedure at the beginning and end of each season.

Clean grease fittings before using grease gun, to avoid injecting dirt and grit into the bearing. Replace any lost or broken fittings immediately. If a fitting fails to take grease, remove and clean thoroughly, replace fitting if necessary. Also check for failure of adjoining parts.

## BEARING REPLACEMENT INSTALLATION

1. If you wish to be able to grease the bearings in the hubs, remove the seal from one side of the bearings as illustrated before assembly. Otherwise the bearings may be left "sealed for life".
2. When assembling the spoke wheels, bearing assembly and hubcap, be sure to align the grease transfer hole in the spoke wheel with the groove in the hubcap and hole in the hub to allow grease passage.
3. Install/assemble the wheels, hubs and caps. **IMPORTANT: THE 2527-530 WASHER MUST BE INSTALLED OR THE WHEEL AND HUB ASSEMBLY WILL FALL OFF DURING USE.**
4. Grease the wheel/hub/bearing assembly.

# MAINTENANCE

## **Storing the Equipment**

Store the machine in an area away from human activity

Store machine in RAISED position.

Install service locks on all wheel cylinders.

At the end of the season, the machine should be thoroughly inspected and prepared for storage. Repair or replace any worn or damaged components to prevent down time at the start of the next season. Store machine under cover with all parts in operating condition.

- Clean machine thoroughly to remove all dirt, debris and crop residue, which would hold moisture and cause rusting.
- Inspect machine for worn or broken parts. See your Yetter Farm Equipment dealer during the off-season so that parts or service can be acquired when machine is not needed in the field.
- Lubricate bearings as outlined in the Lubrication section
- Paint all parts which are chipped or worn and require repainting.
- Store machine in a clean, dry place with the planting unit out of the sun.
- If the machine cannot be stored inside, cover with a waterproof tarpaulin and tie securely in place.
- Do not allow children to play on or around the machine

## TROUBLESHOOTING

<i>Problem</i>	<i>Cause</i>	<i>Solution</i>
Overall settings	Planter not set correctly. Planter not set correctly.	Ensure that in operation the planter frame is at correct height (20-22") and level the tool bar.
Cannot set shallow enough.	Spoke wheels not engaging residue.	See above.
Spoke wheels not turning continuously.		Lower wheels to ensure rotation at all times, <b>DO NOT</b> engage solid part of wheel in dirt.

## PARTS IDENTIFICATION

### 2967-113 - FLOATING RESIDUE MANAGER STEM

Key	Qty	Part No.	Description
1	1	2967-241	Pivot Arm W.A.
2	1	2967-242	Adjustment Tube W.A.
3	1	2967-425	Inside Bushing ZYD
4	1	2502-296	1/2-13 x 2-1/2 HHCS Gr. 5 ZP
5	1	2520-357	1/2-13 Lock Hex Nut ZP
6	1	2960-359	Spring Adjustment Pin ZP
7	1	2570-448	1/8 Std. Hairpin Cotter ZP
8	1	2550-750	Spring, Floating R.M.

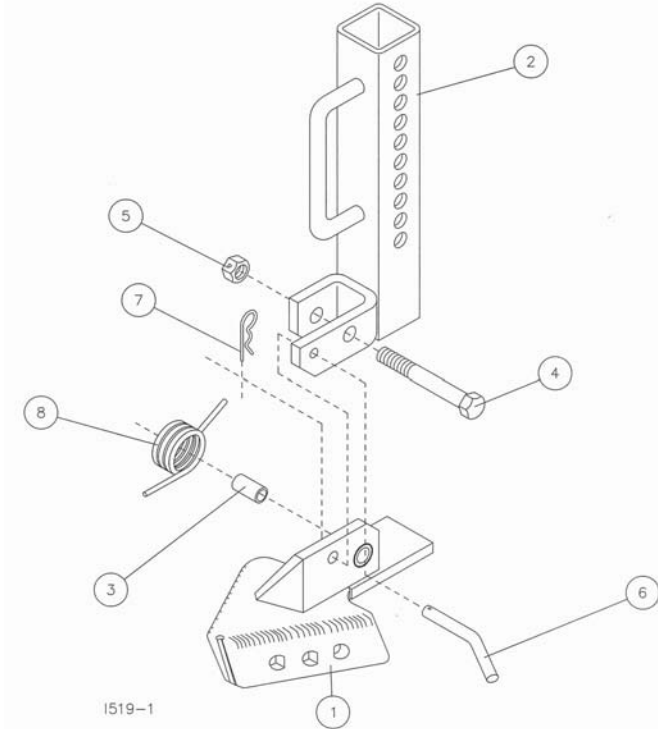

**07-97 TO 05-08**

## OPTIONAL EQUIPMENT

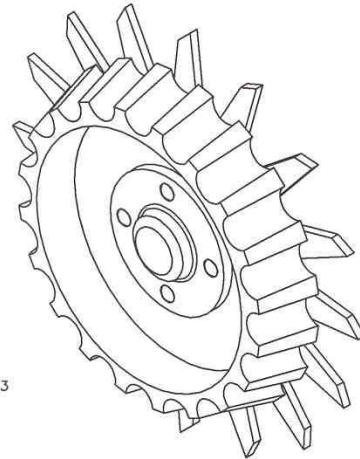

S280-3

## PARTS IDENTIFICATION

### 2967-113 - FLOATING RESIDUE MANAGER STEM

Key	Qty	Part No.	Description
1	1	2967-241	Pivot Arm W.A.
2	1	2967-242	Adjustment Tube W.A.
3	1	2967-425	Inside Bushing ZYD
4	1	2502-296	1/2-13 x 2-1/2 HHCS Gr. 5 ZP
5	1	2520-357	1/2-13 Lock Hex Nut ZP
6	1	2960-359	Spring Adjustment Pin ZP
7	1	2570-448	1/8 Std. Hairpin Cotter ZP
8	1	2550-750	Spring, Floating R.M

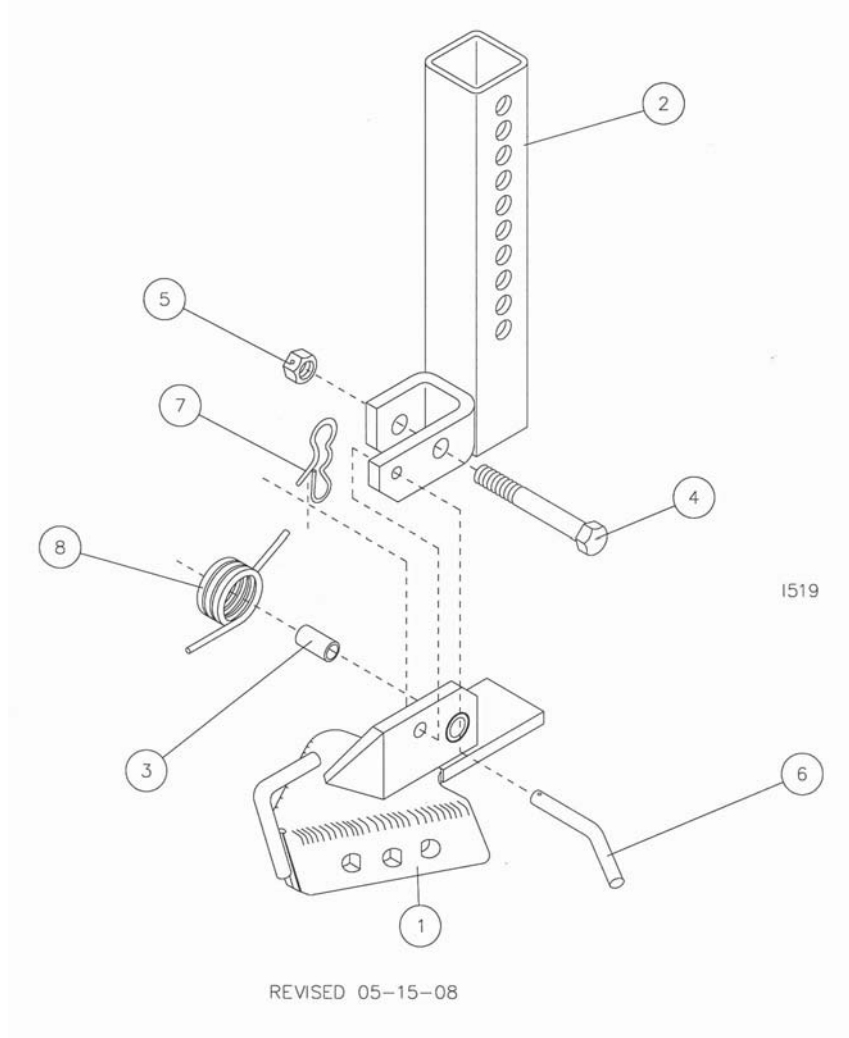

**05-08 TO PRESENT**

# PARTS IDENTIFICATION

2967-102

FLOATING RESIDUE MANAGER STEM W/ WHEELS

KEY	QTY	PART NO.	DESCRIPTION
1	8	2505-207	5/16-18 X 1 1/4 CAR BLT GR 5 ZP
2	2	2965-352	HUB CAP CASTING, 4 BOLT, BLACK
3	2	2967-404	13" TAPER TOOTH SPOKE WHEEL
	2	2967-596	3/8" TAPER TOOTH SPOKE WHEEL
	2	2967-602	13" SHARK TOOTH WHEEL
4	2	2570-742	5/8-11 X 4" 'D' BOLT GR. 5 ZYD
5	2	2965-128	HUB AND BEARING ASSEMBLY, 4 BOLT
6	2	2527-530	1 1/2 OD X 21/32 ID X 3/16 MA BU
7	2	2570-594	BEARING, 2 ROW, NTN# DF0654LU
8	2	2570-715	BEARING INSERT, TRASHMASTER
9	2	2965-351	HUB CASTING, MACHINED, 4 BOLT
10	2	2550-052	SEAL, CR #13548
11	8	2520-205	5/16-18 HEX LOCK NUT ZP
12	2	2525-451	5/8 MED LOCKWASHER ZP
13	2	2520-452	5/8-11 HEX NUT ZP
14	2	2533-110	1/4 SELF TAP GREASE ZERK (NOT SHOWN)
15	2	2967-302	SPACER, 3/4", ZYD
16	2	2967-336	R.M. SHIELD, PAINTED, W/HOLE
17	1	2967-113	FLOATING RESIDUE MANAGER STEM
18	1	2526-402	9/16 ID X 1 3/4 OD X 1/4 MB ZP
19	1	2965-305	PIN, FURROWING ATTACHMENT ZP
20	2	2502-316	1/2-13 X 3 1/2 HHCS GR 5 ZP
21	5	2520-357	1/2-13 HEX LOCK NUT ZP
22	3	2502-294	1/2-13 X 1 1/2 HHCS GR 5 ZP
23	2	2526-355	1/2 FLAT WASHER, HARD'ND, P.C.
24	1	2967-211	MOUNTING BRKT., TRIMMED, W.A.
25	1	2570-448	1/8 BOWTIE LOCKING COTTER ZYD

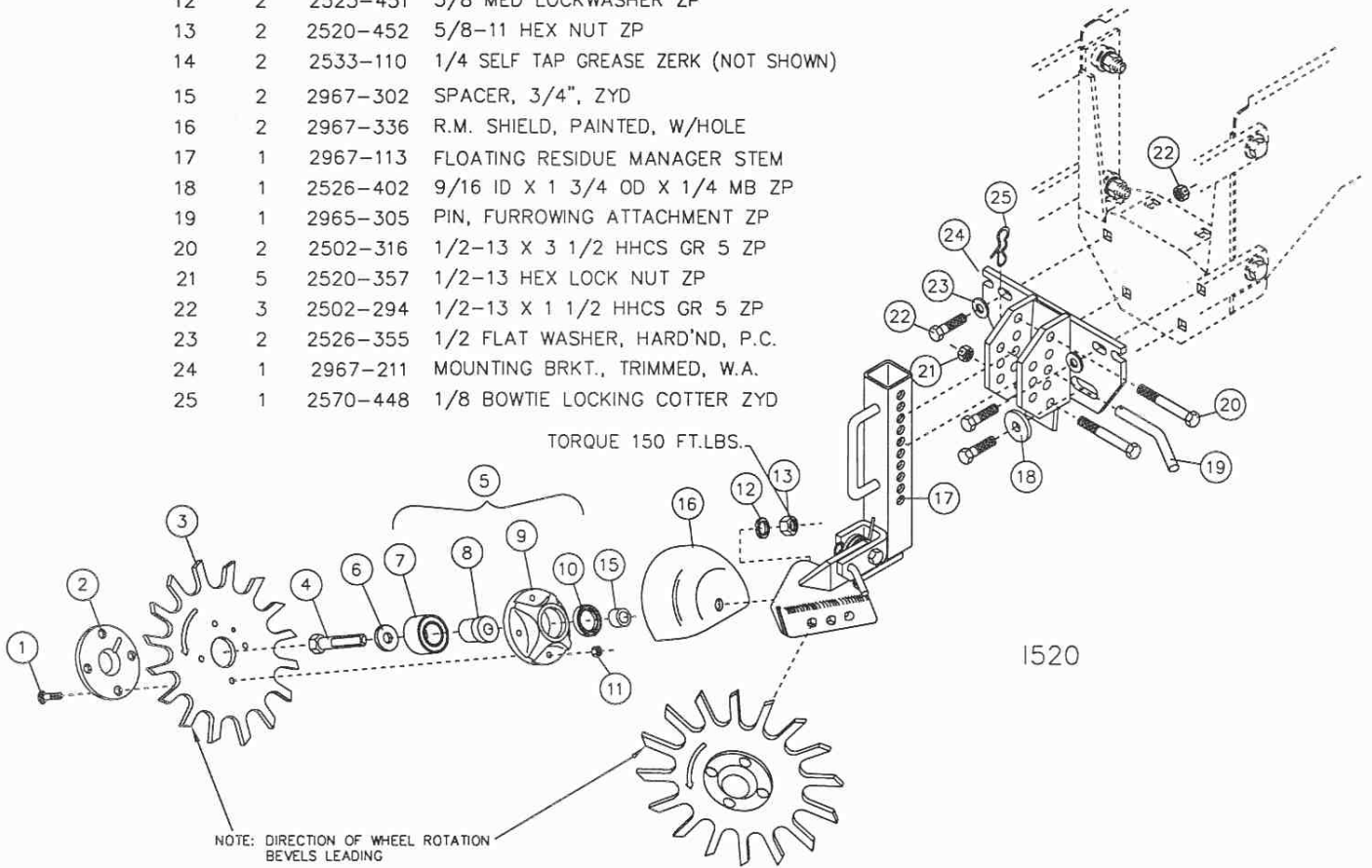

REVISED 02/05/09

07-97 TO 05-08

# PARTS IDENTIFICATION

2967-102

FLOATING RESIDUE MANAGER STEM W/ WHEELS

KEY	QTY	PART NO.	DESCRIPTION
1	8	2505-207	5/16-18 X 1 1/4 CAR BLT GR 5 ZP
2	2	2965-352	HUB CAP CASTING, 4 BOLT, BLACK
3	2	2967-404	13" TAPER TOOTH SPOKE WHEEL
	2	2967-596	3/8" TAPER TOOTH SPOKE WHEEL
	2	2967-602	13" SHARK TOOTH WHEEL
4	2	2570-742	5/8-11 X 4" 'D' BOLT GR. 5 ZYD
5	2	2965-128	HUB AND BEARING ASSEMBLY, 4 BOLT
6	2	2527-530	1 1/2 OD X 21/32 ID X 3/16 MA BU
7	2	2570-594	BEARING, 2 ROW, NTN# DF0654LU
8	2	2570-715	BEARING INSERT, TRASHMASTER
9	2	2965-351	HUB CASTING, MACHINED, 4 BOLT
10	2	2550-052	SEAL, CR #13548
11	8	2520-205	5/16-18 HEX LOCK NUT ZP
12	2	2525-451	5/8 MED LOCKWASHER ZP
13	2	2520-452	5/8-11 HEX NUT ZP
14	2	2533-110	1/4 SELF TAP GREASE ZERK (NOT SHOWN)
15	2	2967-302	SPACER, 3/4", ZYD
16	2	2967-336	R.M. SHIELD, PAINTED, W/HOLE
17	1	2967-113	FLOATING RESIDUE MANAGER STEM
18	1	2526-402	9/16 ID X 1 3/4 OD X 1/4 MB ZP
19	1	2965-305	PIN, FURROWING ATTACHMENT ZP
20	2	2502-316	1/2-13 X 3 1/2 HHCS GR 5 ZP
21	5	2520-357	1/2-13 HEX LOCK NUT ZP
22	3	2502-294	1/2-13 X 1 1/2 HHCS GR 5 ZP
23	2	2526-355	1/2 FLAT WASHER, HARD'ND, P.C.
24	1	2967-211	MOUNTING BRKT., TRIMMED, W.A.
25	1	2570-448	1/8 BOWTIE LOCKING COTTER ZYD

TORQUE 150 FT.LBS.

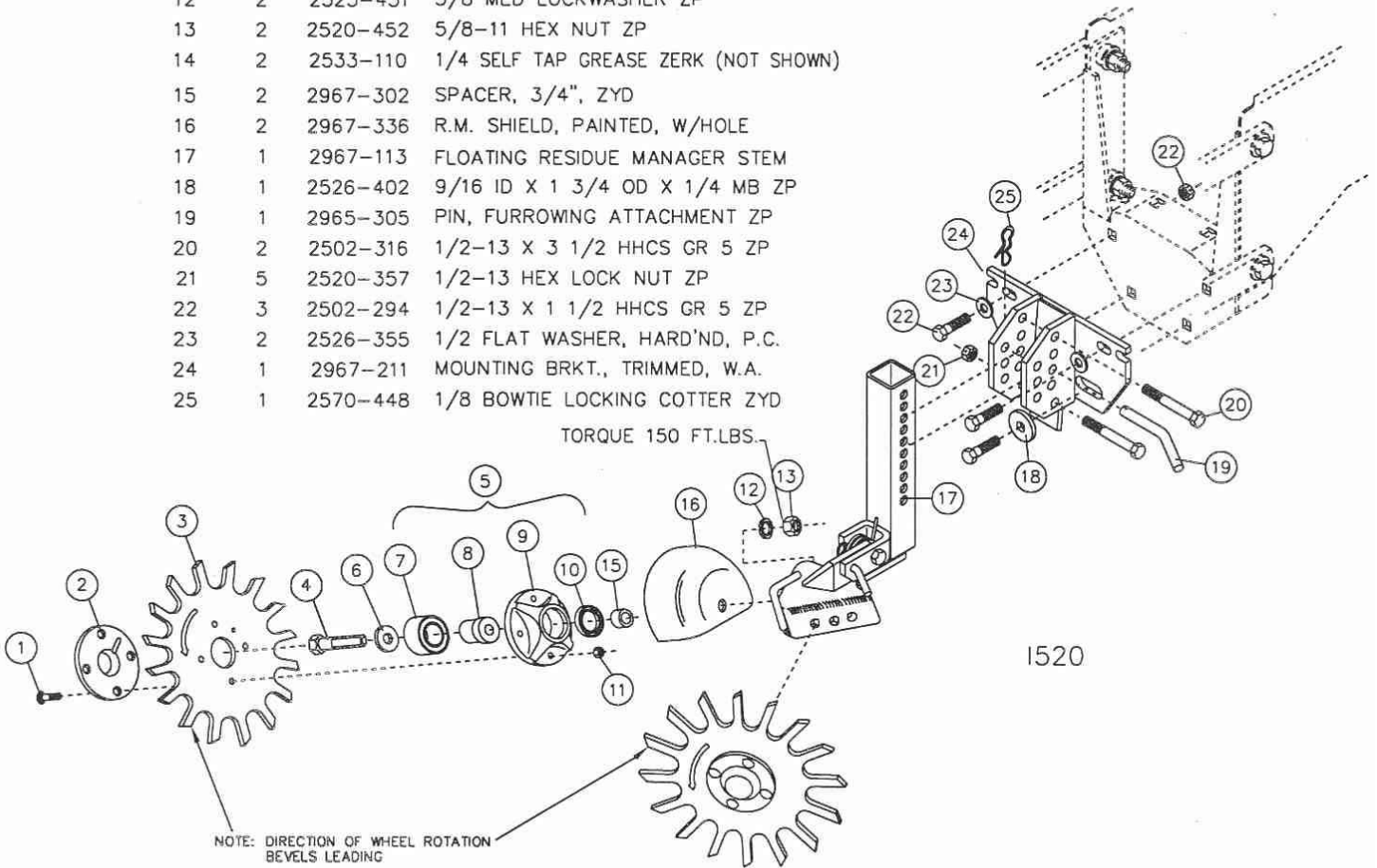

REVISED 02/05/09

05-08 TO PRESENT

## PARTS IDENTIFICATION

# 2967-122

FLOATING RESIDUE MANAGER 2910/2995/2996

DET	QTY	PART NO.	DESCRIPTION
1	8	2505-207	5/16-18 X 1 1/4 CAR BLT GR 5 ZP
2	2	2965-352	HUB CAP CASTING, 4 BOLT, BLACK
3	2	2967-404	13" TAPER TOOTH SPOKE WHEEL
	2	2967-596	3/8" TAPER TOOTH SPOKE WHEEL
4	2	2570-742	5/8-11 X 4" 'D' BOLT GR. 5 ZYD
5	2	2965-128	HUB AND BEARING ASSEMBLY, 4 BOLT
6	2	2527-530	1 1/2 OD X 21/32 ID X 3/16 MA BU
7	2	2570-594	BEARING, 2 ROW, NTN# DF0654LU
8	2	2570-715	BEARING INSERT, TRASHMASTER
9	2	2965-351	HUB CASTING, MACHINED, 4 BOLT
10	2	2550-052	SEAL, CR#13548
11	8	2520-205	5/16-18 HEX LOCK NUT ZP
12	2	2525-451	5/8 MED LOCKWASHER ZP
13	2	2520-452	5/8-11 HEX NUT ZP
14	2	2533-110	1/4 SELF TAP GREASE ZERK (NOT SHOWN)
15	2	2967-302	SPACER, 3/4", ZYD
16	2	2967-336	R.M. SHIELD, PAINTED, W/HOLE
17	1	2967-113	FLOATING RESIDUE MANAGER STEM
18	1	2570-448	1/8 STANDARD HAIRPIN COTTER ZP
19	2	2502-294	1/2-13 X 1 1/2 HHCS GR 5 ZP
20	1	2967-244	R.M. MOUNT BRKT. W.A.
21	1	2965-305	PIN, FURROWING ATTACHMENT ZP
22	1	2503-379	5/8-11 X 1 SQHCPSS ZP.
23	1	2967-243	TOP MOUNT PLATE W.A.
24	2	2520-352	1/2-13 HEX NUT ZP.
25	2	2525-352	1/2 MED LOCKWASHER ZP.

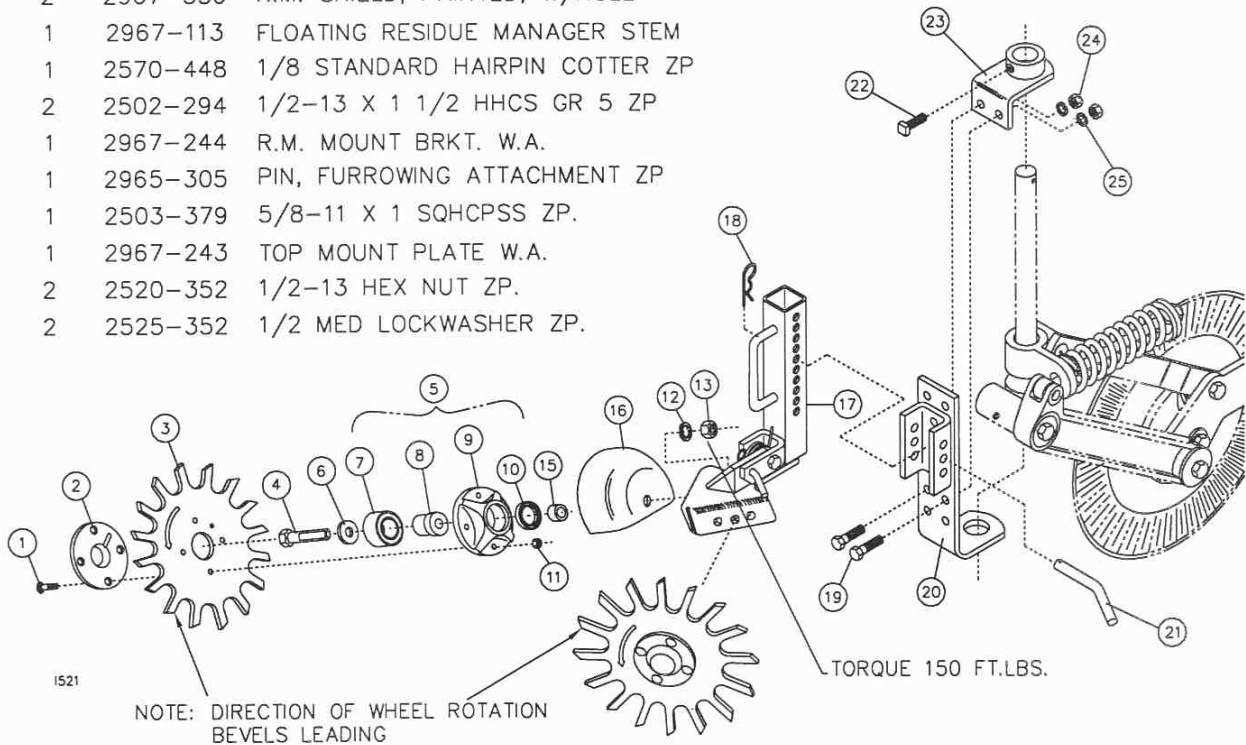

REVISED 02/06/09

**07-97 TO 05-08**



# PARTS IDENTIFICATION

## 2967-122

FLOATING RESIDUE MANAGER 2910/2995/2996

DET	QTY	PART NO.	DESCRIPTION
1	8	2505-207	5/16-18 X 1 1/4 CAR BLT GR 5 ZP
2	2	2965-352	HUB CAP CASTING, 4 BOLT, BLACK
3	2	2967-404	13" TAPER TOOTH SPOKE WHEEL
	2	2967-596	3/8" TAPER TOOTH SPOKE WHEEL
4	2	2570-742	5/8-11 X 4" 'D' BOLT GR. 5 ZYD
5	2	2965-128	HUB AND BEARING ASSEMBLY, 4 BOLT
6	2	2527-530	1 1/2 OD X 21/32 ID X 3/16 MA BU
7	2	2570-594	BEARING, 2 ROW, NTN# DF0654LU
8	2	2570-715	BEARING INSERT, TRASHMASTER
9	2	2965-351	HUB CASTING, MACHINED, 4 BOLT
10	2	2550-052	SEAL, CR#13548
11	8	2520-205	5/16-18 HEX LOCK NUT ZP
12	2	2525-451	5/8 MED LOCKWASHER ZP
13	2	2520-452	5/8-11 HEX NUT ZP
14	2	2533-110	1/4 SELF TAP GREASE ZERK (NOT SHOWN)
15	2	2967-302	SPACER, 3/4", ZYD
16	2	2967-336	R.M. SHIELD, PAINTED, W/HOLE
17	1	2967-113	FLOATING RESIDUE MANAGER STEM
18	1	2570-448	1/8 STANDARD HAIRPIN COTTER ZP
19	2	2502-294	1/2-13 X 1 1/2 HHCS GR 5 ZP
20	1	2967-244	R.M. MOUNT BRKT. W.A.
21	1	2965-305	PIN, FURROWING ATTACHMENT ZP
22	1	2503-379	5/8-11 X 1 SQHCPSS ZP.
23	1	2967-243	TOP MOUNT PLATE W.A.
24	2	2520-352	1/2-13 HEX NUT ZP.
25	2	2525-352	1/2 MED LOCKWASHER ZP.

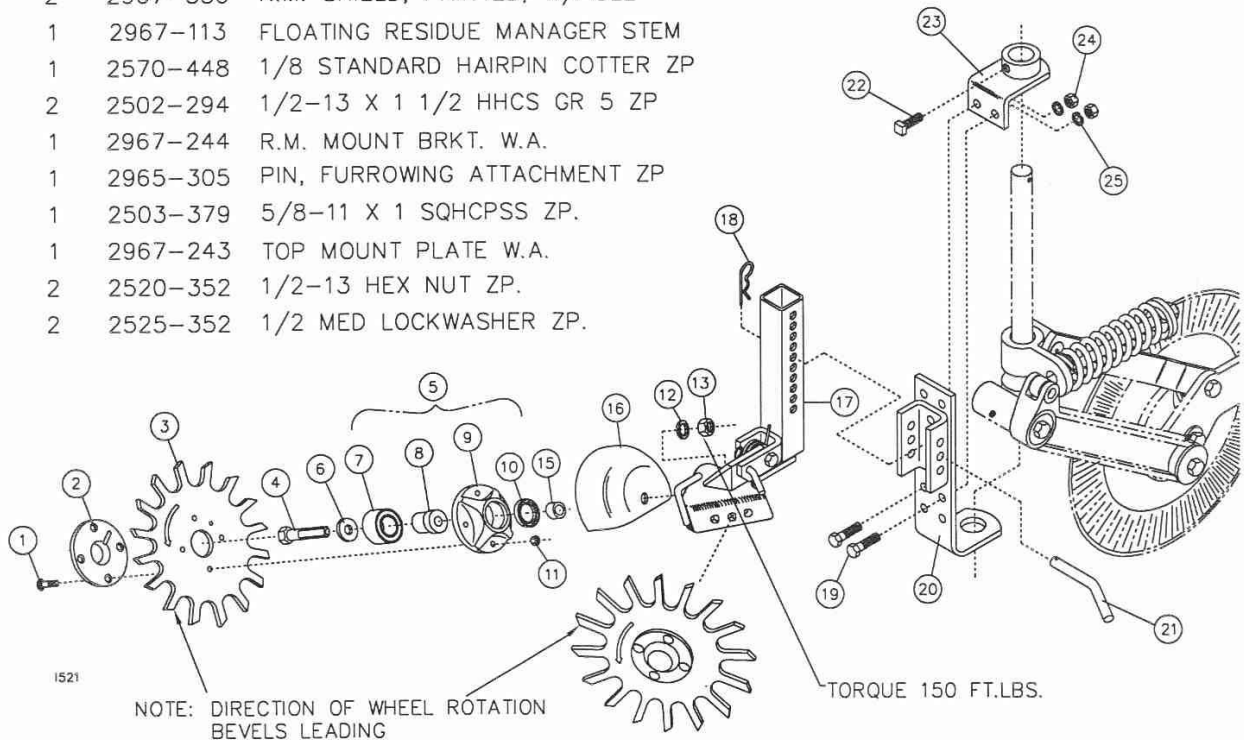

REVISED 02/06/09

05-08 TO PRESENT

## PARTS IDENTIFICATION

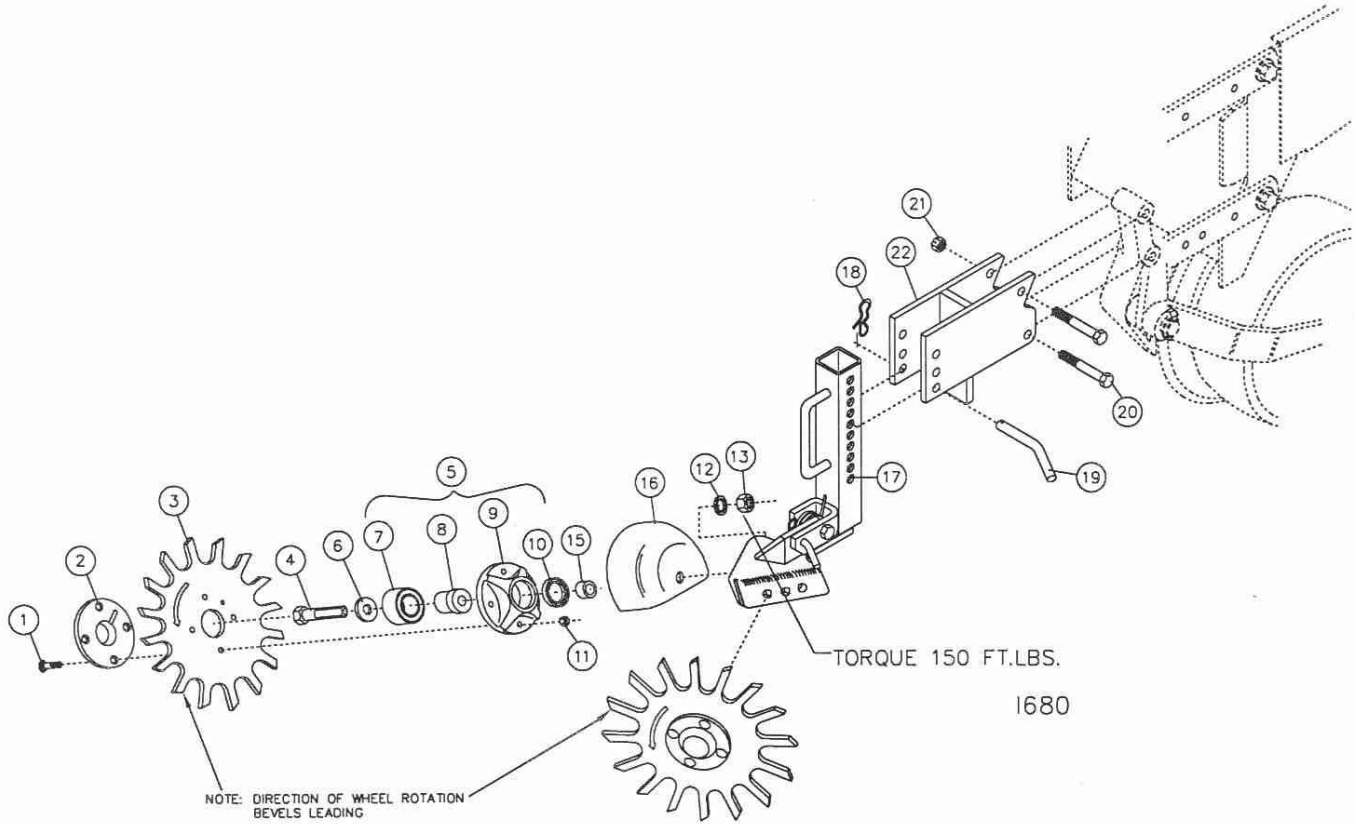

2967-103

FLOATING RESIDUE MANAGER C.N.H.

KEY	QTY	PART NO.	DESCRIPTION
1	8	2505-207	5/16-18 X 1 1/4 CAR BLT GR 5 ZP
2	2	2965-352	HUB CAP CASTING, 4 BOLT, BLACK
3	2	2967-404	13" TAPER TOOTH SPOKE WHEEL
	2	2967-596	3/8" TAPER TOOTH SPOKE WHEEL
	2	2967-602	13" SHARK TOOTH WHEEL
4	2	2570-742	5/8-11 X 4" 'D' BOLT GR. 5 ZYD
5	2	2965-128	HUB AND BEARING ASSEMBLY, 4 BOLT
6	2	2527-530	1 1/2 OD X 21/32 ID X 3/16 MA BU
7	2	2570-594	BEARING, 2 ROW, NTN# DF0654LU
8	2	2570-715	BEARING INSERT, TRASHMASTER
9	2	2965-351	HUB CASTING, MACHINED, 4 BOLT
10	2	2550-052	SEAL, CR #13548
11	8	2520-205	5/16-18 HEX LOCK NUT ZP
12	2	2525-451	5/8 MED LOCKWASHER ZP
13	2	2520-452	5/8-11 HEX NUT ZP
14	2	2533-110	1/4 SELF TAP GREASE ZERK (NOT SHOWN)
15	2	2967-302	SPACER, 3/4", ZYD
16	2	2967-336	R.M. SHIELD, PAINTED, W/HOLE
17	1	2967-113	FLOATING RESIDUE MANAGER STEM
18	1	2570-448	1/8 BOWTIE LOCKING COTTER ZYD
19	1	2965-305	PIN, FURROWING ATTACHMENT ZP
20	2	2502-316	1/2-13 X 3 1/2 HHCS GR 5 ZP
21	2	2520-357	1/2-13 HEX LOCK NUT ZP
22	1	2965-203	FURROWER MOUNT BRACKET, 800

REVISED 02/06/09

**07-97 TO 05-08**

## PARTS IDENTIFICATION

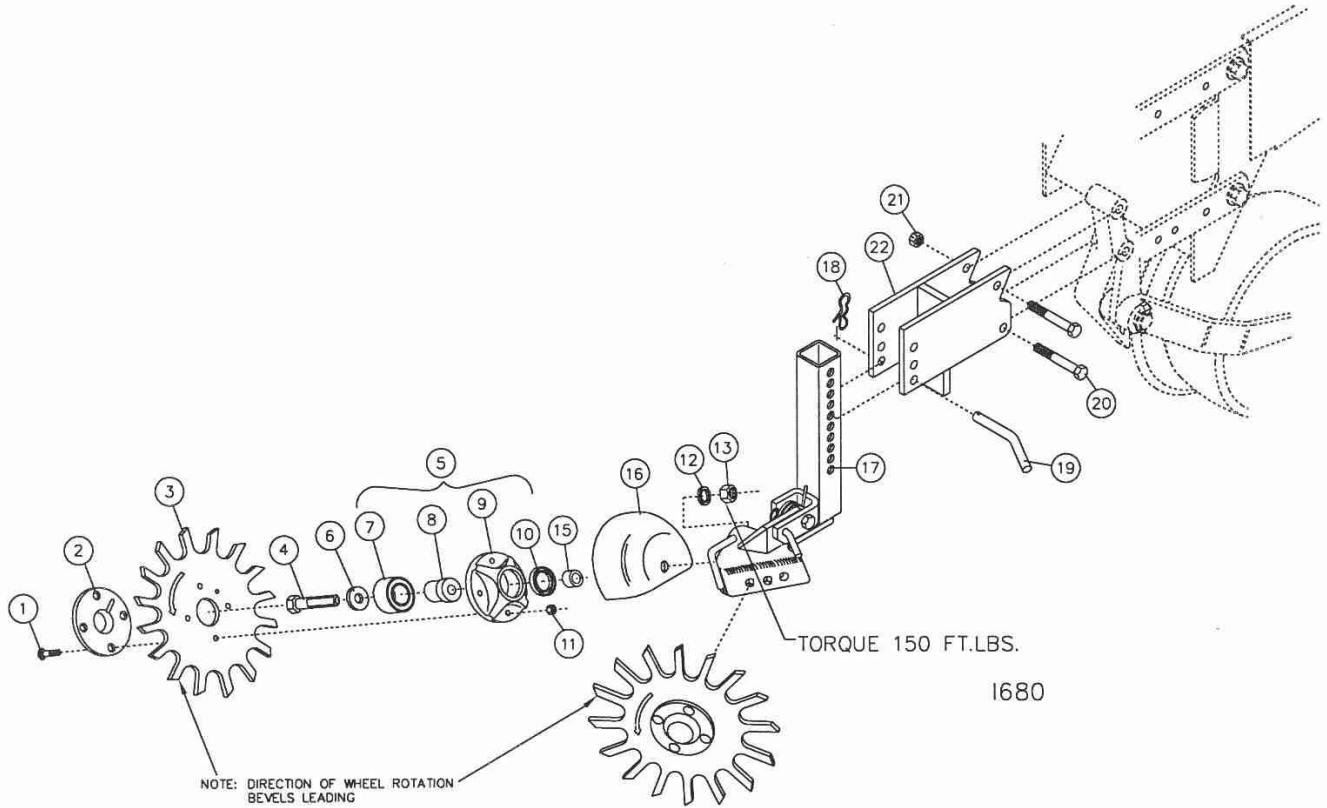

2967-103

FLOATING RESIDUE MANAGER C.N.H.

KEY	QTY	PART NO.	DESCRIPTION
1	8	2505-207	5/16-18 X 1 1/4 CAR BLT GR 5 ZP
2	2	2965-352	HUB CAP CASTING, 4 BOLT, BLACK
3	2	2967-404	13" TAPER TOOTH SPOKE WHEEL
	2	2967-596	3/8" TAPER TOOTH SPOKE WHEEL
	2	2967-602	13" SHARK TOOTH WHEEL
4	2	2570-742	5/8-11 X 4" 'D' BOLT GR. 5 ZYD
5	2	2965-128	HUB AND BEARING ASSEMBLY, 4 BOLT
6	2	2527-530	1 1/2 OD X 21/32 ID X 3/16 MA BU
7	2	2570-594	BEARING, 2 ROW, NTN# DF0654LU
8	2	2570-715	BEARING INSERT, TRASHMASTER
9	2	2965-351	HUB CASTING, MACHINED, 4 BOLT
10	2	2550-052	SEAL, CR #1354B
11	8	2520-205	5/16-18 HEX LOCK NUT ZP
12	2	2525-451	5/8 MED LOCKWASHER ZP
13	2	2520-452	5/8-11 HEX NUT ZP
14	2	2533-110	1/4 SELF TAP GREASE ZERK (NOT SHOWN)
15	2	2967-302	SPACER, 3/4", ZYD
16	2	2967-336	R.M. SHIELD, PAINTED, W/HOLE
17	1	2967-113	FLOATING RESIDUE MANAGER STEM
18	1	2570-448	1/8 BOWTIE LOCKING COTTER ZYD
19	1	2965-305	PIN, FURROWING ATTACHMENT ZP
20	2	2502-316	1/2-13 X 3 1/2 HHCS GR 5 ZP
21	2	2520-357	1/2-13 HEX LOCK NUT ZP
22	1	2965-203	FURROWER MOUNT BRACKET, 800

REVISED 02/06/09

05-08 TO PRESENT

# Our name Is getting known

Just a few years ago, Yetter products were sold primarily to the Midwest only. Then we embarked on a program of expansion and moved into the East, the South, the West and now north into Canada. We're even getting orders from as far away as Australia and Africa.

So, when you buy Yetter products . . .you're buying a name that's recognized. A name that's known and respected. A name that's become a part of American agriculture and has become synonymous with quality and satisfaction in the field of conservation tillage.

Thank you.

**YETTER MANUFACTURING CO.**

Colchester, IL 62326-0358 • 309/776-4111

Toll Free 800/447-5777

Fax 309/776-3222

Website: [WWW.YETTERCO.COM](http://WWW.YETTERCO.COM)

E-MAIL: [INFO@YETTERCO.COM](mailto:INFO@YETTERCO.COM)

2565-415\_REV\_A ☐  
03/09